

*Correction Copy*

LAND ATLAS & PLAT BOOK

# WINNEBAGO COUNTY

WISCONSIN

1989



Valley Queen II - Photo by David Groth

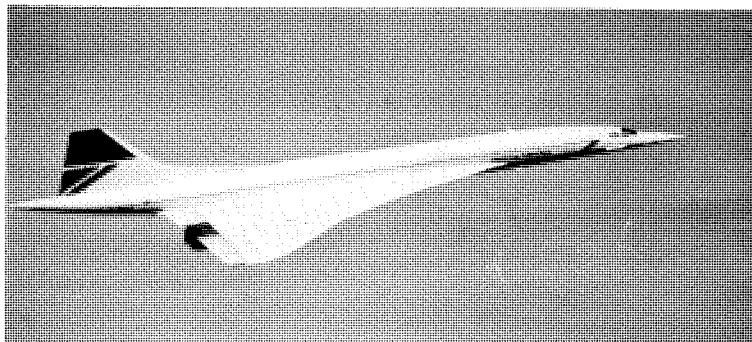

British Airways "Concorde" at EAA Convention - Photo by Timothy Sweet

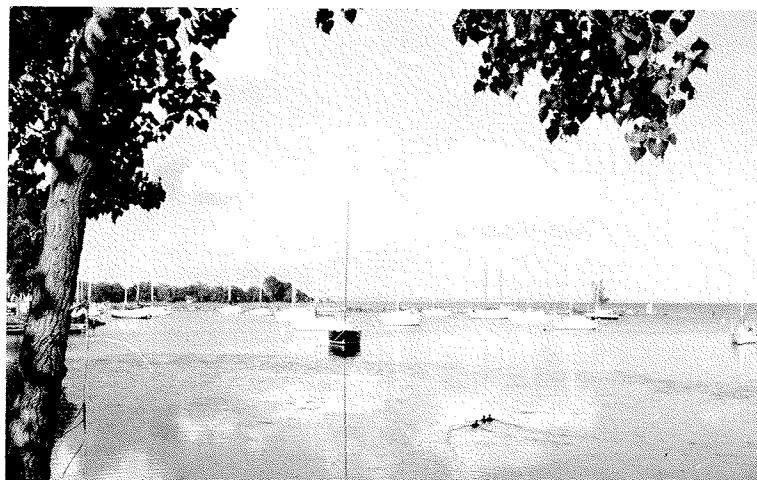

Harbor Scene off Lake Winnebago - Photo by Lois Fischer



**Winnebago County**

WISCONSIN

*The Wave of the Future*

Published by  
ROCKFORD MAP PUBLISHERS, Inc.  
4525 Forest View Avenue, P.O. Box 6126  
Rockford, Illinois 61125

Books available from  
MARJORIE DAHMS  
Winnebago County Register of Deeds Office  
Oshkosh, Wisconsin 54901

# INDEX MAP

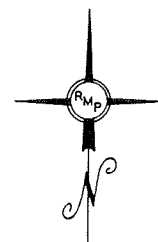
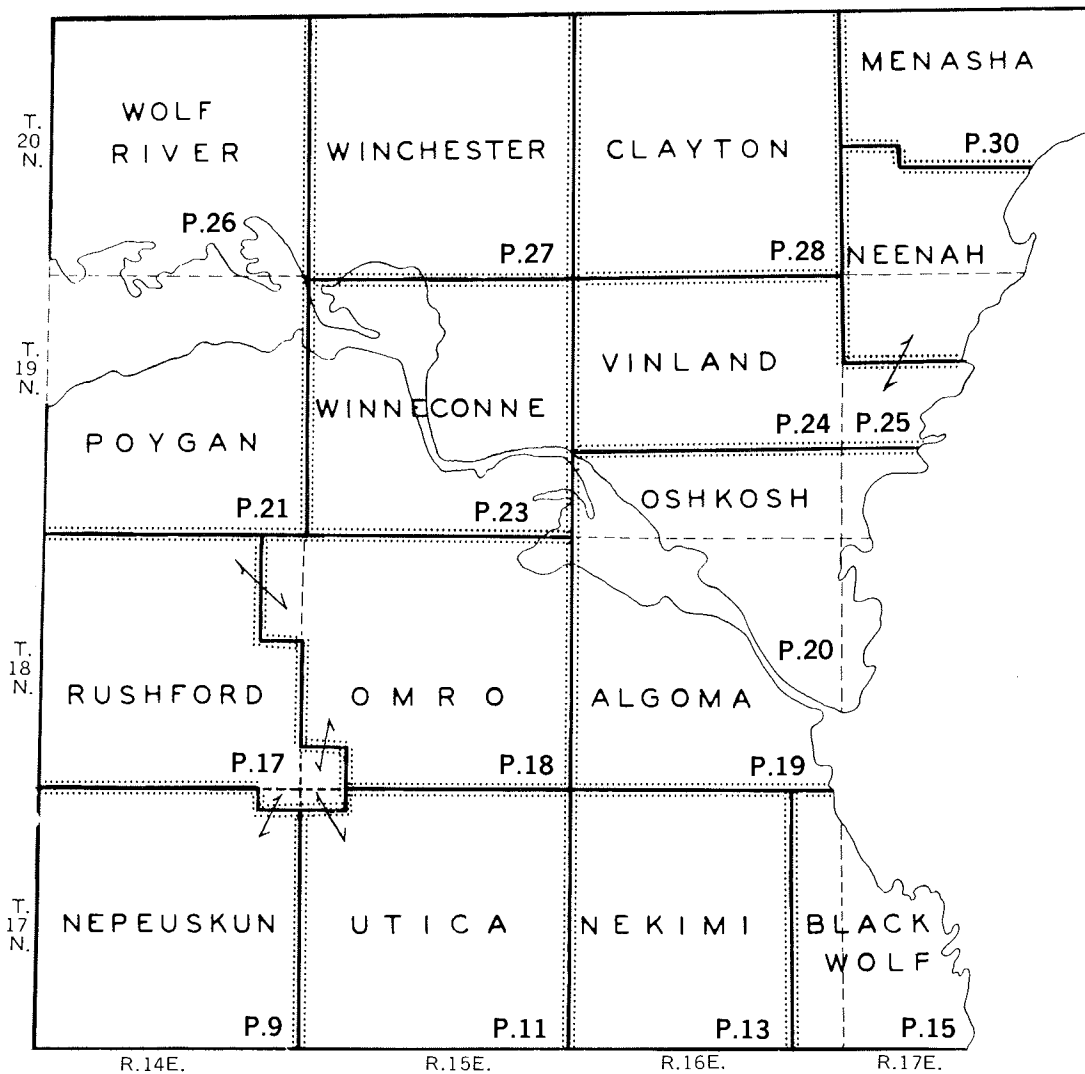

## ALPHABETICAL INDEX TO TOWNSHIP MAPS

Township	Page
ALGOMA	19
BLACK WOLF	15
CLAYTON	28
MENASHA	30
NEENAH	25
NEKIMI	13
NEPEUSKUN	9
OMRO	17,18
OSHKOSH	20
POYGAN	21
RUSHFORD	9,11,17,18
UTICA	11
VINLAND	24,25
WINCHESTER	27
WINNECONNE	23
WOLF RIVER	26

## LEGEND

CIVIL TWP. BORDER:   
 CONG. TWP. BORDER:

## LEGEND FOR TOWNSHIP MAPS

<p>INTERSTATE EXPRESSWAY </p> <p>FEDERAL HIGHWAY </p> <p>STATE HIGHWAY </p> <p>COUNTY - STATE AID HIGHWAY </p> <p>DIVIDED HIGHWAY </p> <p>PAVED ROAD </p> <p>BITUMINOUS ROAD </p> <p>GRAVEL ROAD </p> <p>OTHER ROADS </p> <p>TRAIL </p> <p>HIKING TRAIL </p> <p>RAILROAD </p> <p>DITCH </p>	<p>CANAL </p> <p>LEVEE </p> <p>FARMSTEAD OR DWELLING </p> <p>GROUP OF BUILDINGS </p> <p>RURAL BUSINESS BUILDING </p> <p>CHURCH </p> <p>SCHOOL </p> <p>CEMETERY </p> <p>FIRE TOWER </p> <p>INCORPORATED CITY OR VILLAGE </p> <p>CORPORATE LIMIT LINE </p> <p>UNINCORPORATED CITY OR VILLAGE </p> <p>SUBDIVISIONS OR AREAS OF SMALL TRACTS </p> <p>CIVIL TOWNSHIP BOUNDARY </p>	<p>COUNTY PARKS </p> <p>PARK </p> <p>GAME REFUGE, FOREST, WILDLIFE AREA </p> <p>SCALE: 1 1/4 INCH EQUALS 1 MILE</p> <p> HOOK MEANS SAME OWNER FOR BOTH PARCELS</p>	<p>ETUX ..... AND WIFE</p> <p>ETVIR ..... AND HUSBAND</p> <p>ETAL ..... AND OTHERS</p> <p>F.C.L. .... FOREST CROP LANDS</p> <p>HRS. .... HEIRS</p> <p>IRREV. TRUST ..... IRREVOCABLE TRUST</p> <p>(L.C.) ..... LAND CONTRACT</p> <p>(L.E.) ..... LIFE ESTATE</p> <p>(L.U.) ..... LIFE USE</p> <p>M.F.L. .... MANAGED FOREST LANDS</p> <p>M.T. .... MARITAL TRUST</p> <p>P.F.C. .... PRIVATE FOREST CROP LANDS</p> <p>REV. TRUST ..... REVOCABLE TRUST</p> <p>R.O.W. .... RIGHT OF WAY</p> <p>S.U.L. .... SPECIAL USE LANDS</p> <p>T.F.L. .... TAX FORFEITED LANDS</p> <p>U.C.D. .... UNRECORDED CONTRACT DEED</p> <p>W.D. .... WORKING DEED</p> <p>W.T.L. or W.T. .... WOODLAND TAX LANDS</p>
---	---	--	---

### Abbreviations

A.K.A. .... ALSO KNOWN AS  
 C.D. .... CONTRACT DEED  
 C.F.L. .... COUNTY FOREST LANDS  
 C.P. .... CONTRACT FOR PURCHASE  
 C.S.M. .... CERTIFIED SURVEY MAP  
 D/B/A. .... DOING BUSINESS AS

SEE PAGE 17

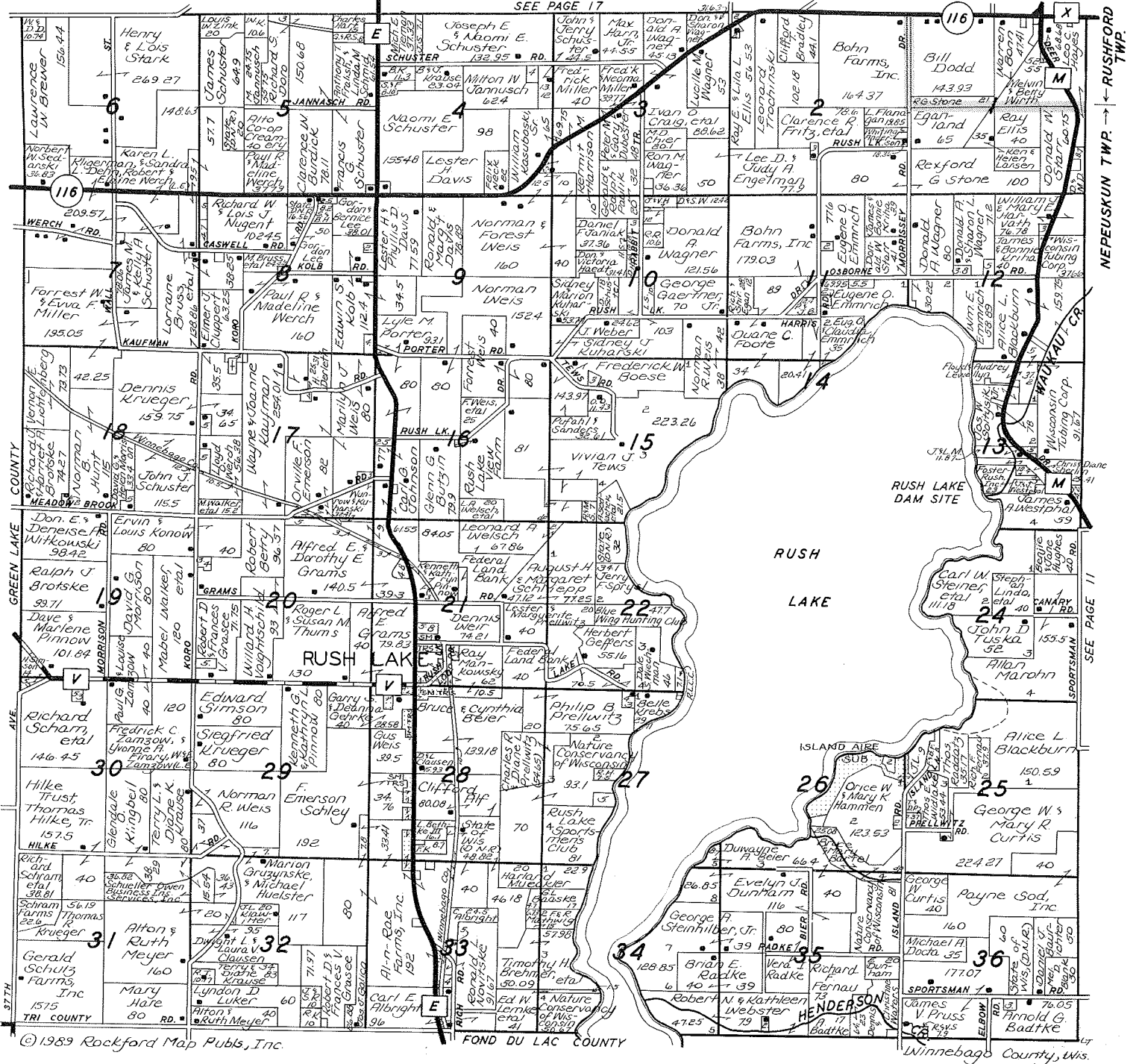

©1989 Rockford Map Pubs, Inc.

FOND DU LAC COUNTY

Winnebago County, Wis.



**BERLIN REAL ESTATE AGENCY**  
**361-0727**

110 North Pearl Street - Berlin, Wisconsin 54923  
 "Complete Real Estate, Auction and Appraisal Service"

LEROY TESKE - Real Estate Broker & Auctioneer  
 SALES:

Janet Teske - Gerene Bartol  
 Dave Reitz - Jean Reitz - Marilyn Voeltner



110 North Pearl Street  
 Berlin, Wisconsin  
 Phone: (414) 361-2255

LeRoy Teske, Berlin  
 Bill Jones, Pickett ☆ 589-4912  
 Tom Rusch, Oshkosh ☆ 231-8203  
 Don Lloyd, Oshkosh ☆ 231-4789

Complete Auction & Appraisal Service

# UTICA SOUTHEAST PART RUSHFORD T.17N.-R.15E.

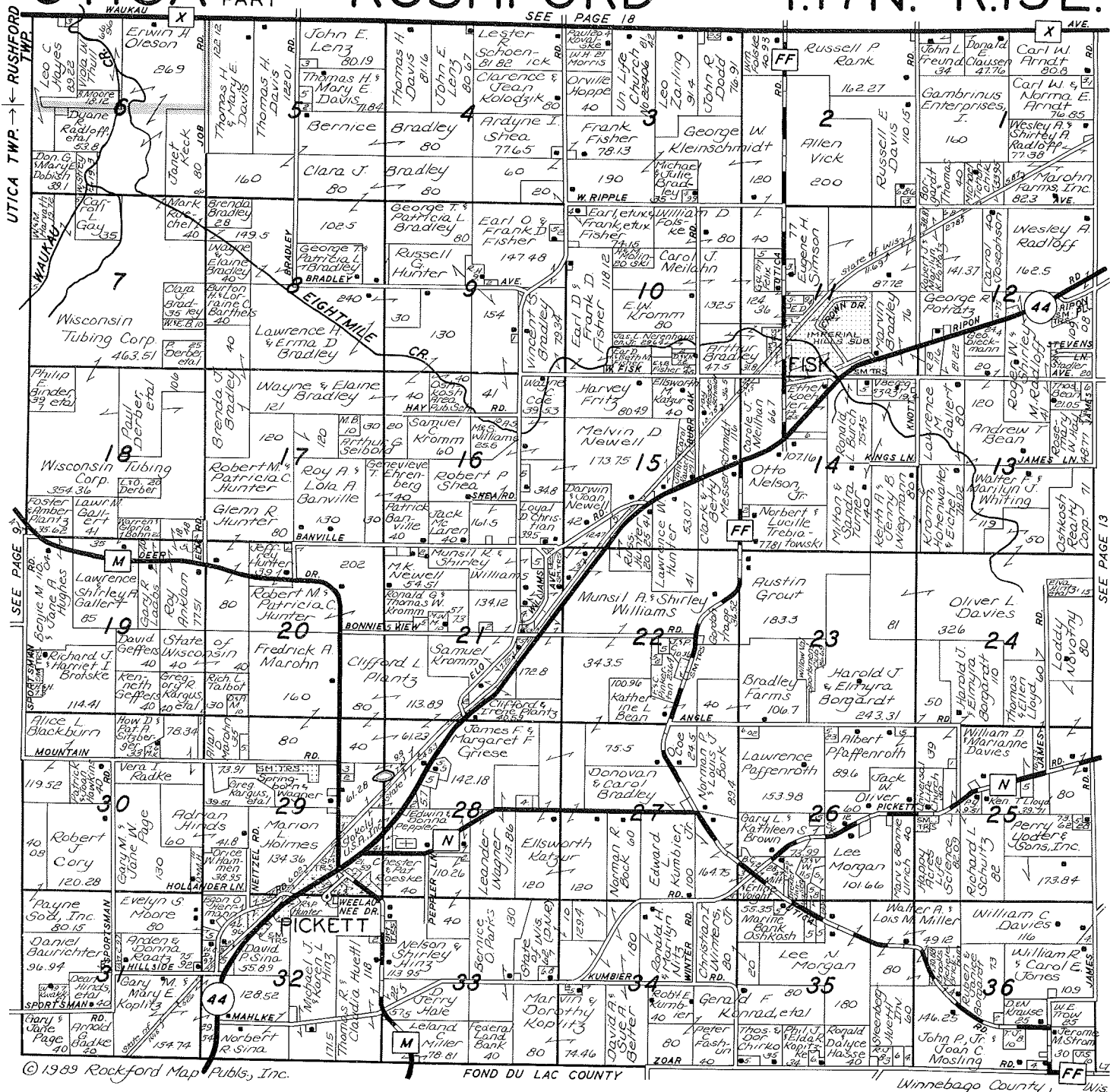

© 1989 Rockford Map Pubs., Inc.

FOND DU LAC COUNTY

Winnebago County, Wis

## ELDORADO FEED SUPPLY, INC.



DEALER IN

FEED - SEED - GRAIN - FERTILIZER  
CUSTOM GRINDING - MIXING  
PICKUP & DELIVERY

Processors of Tomorrows Feed Today

PHONE: Rosendale 872-2331  
or 872-2433

ELDORADO, WISCONSIN



## WILLIAM (BILL) JONES

AUCTIONEER and REALTOR

FARM — RESIDENTIAL — APPRAISING

Serving the Fox Valley for over 25 years



PHONE: (414) 589-4912

7321 James Road — Pickett, Wisconsin 54964



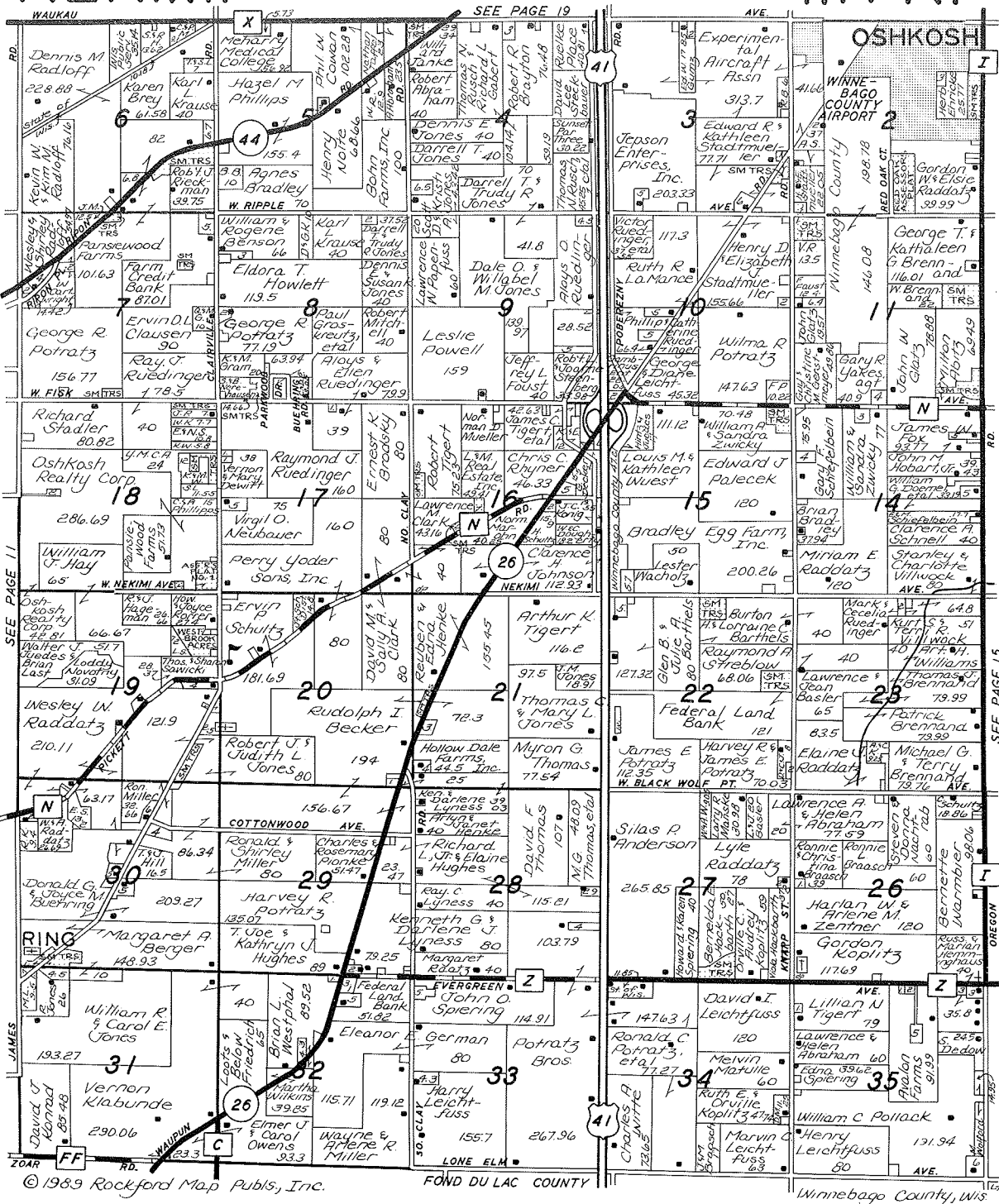

# Rosendale State Bank

YOUR LOCALLY OWNED BANK

3 LOCATIONS

Rosendale, Pickett and Van Dyne, Wisconsin

Visit Any Of Our Offices and Discuss The Various Savings Plans Available



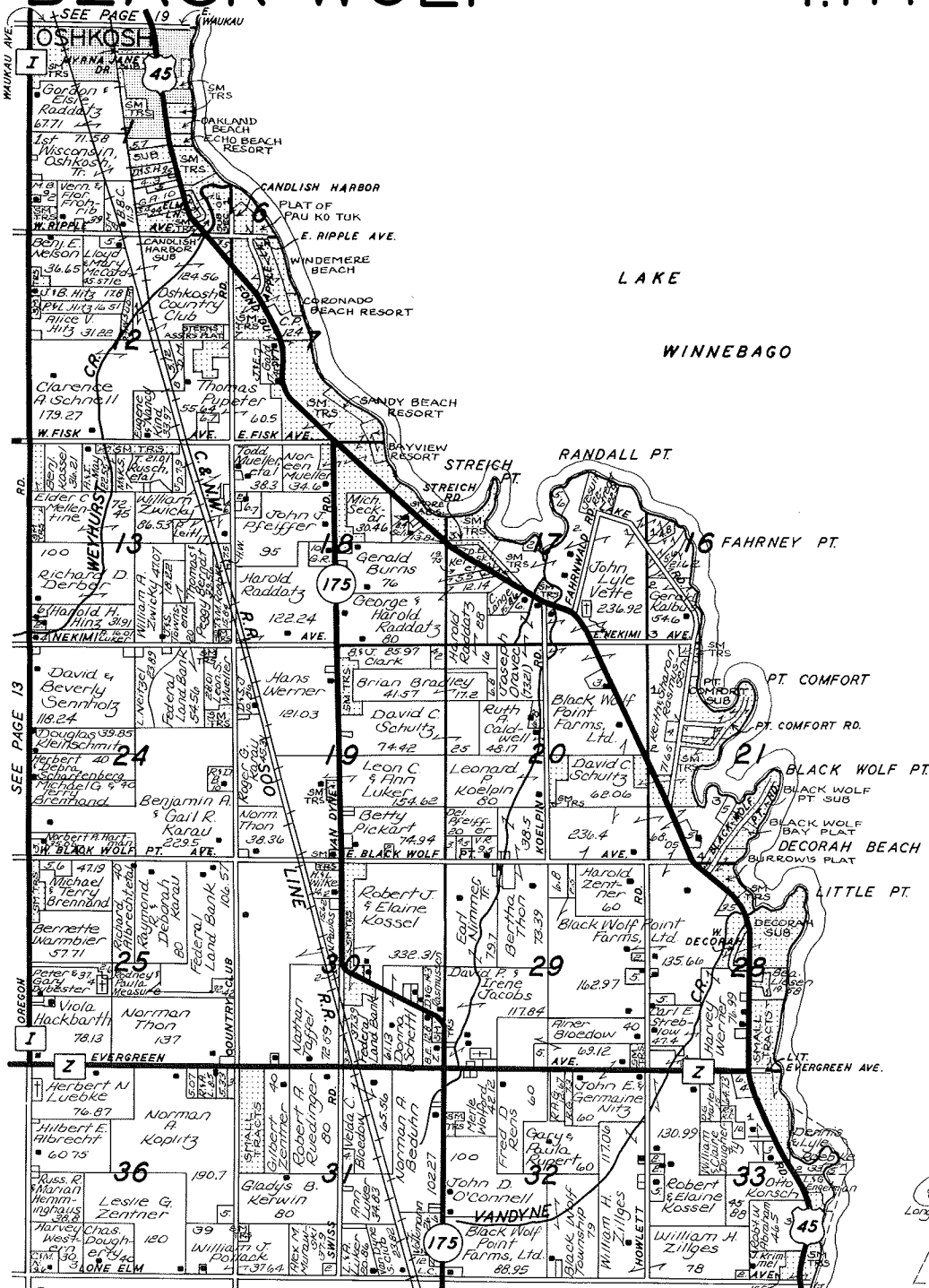

© 1989 Rockford Map Publ., Inc.  
R.16E. ← R.17E.

FOND DU LAC COUNTY Winnebago County, Wis.

*Shore acc used 18-17-17*

# OSHKOSH SAVINGS

*“ We care about our customers.  
That’s not just our philosophy.  
That’s our way of doing business.”*



OSHKOSH

APPLETON

WINNECONNE

BERLIN



# NORTHWEST PART RUSHFORD WEST PART OMRO T.18N.-R.14E.

SEE PAGE 21

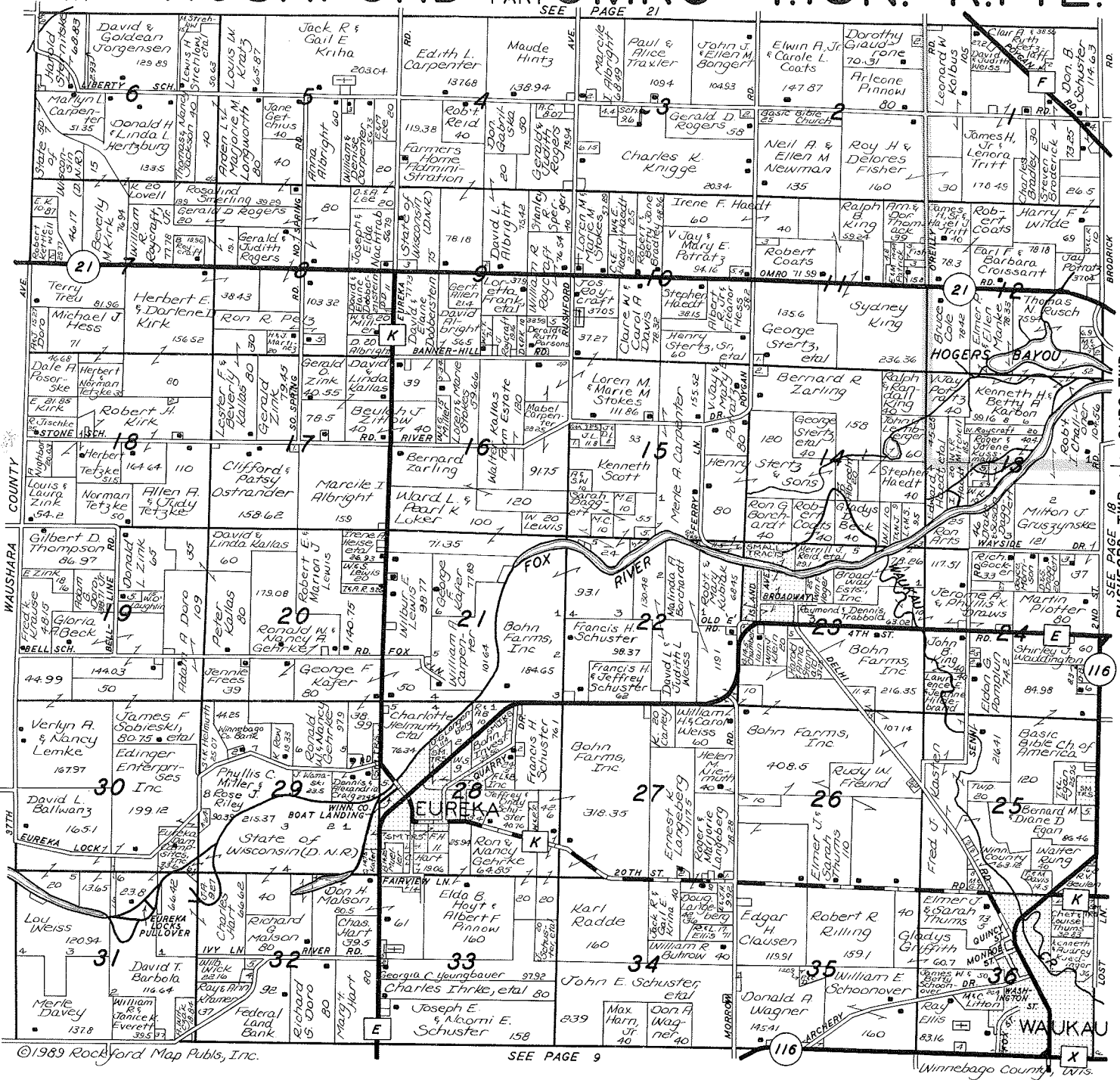

©1989 Rockford Map Publ's, Inc.

SEE PAGE 9

SEE PAGE 19 RUSHFORD TWP. ← OMRO TWP.

## M. P. B., INC.

Ripon, Wisconsin — (414) 748-2601

**Design and Construction of —**  
Post Frame • Stud Wall and Steel Buildings

**Buildings For —**  
Commercial • Industrial • Agricultural

Write or Call:

### M. P. B., INC.

654 East Oshkosh Street  
Ripon, Wisconsin 54971  
Call Collect: (414) 748-2601

### Other Services Available

Building Material Sales • Lumber • Steel • Trim  
Treated Posts • Wolmanized Outdoor Wood  
Building Packages • Equipment & Tool Rental

IN-HOUSE REGISTERED ENGINEER



EAST PART OMRO NORTHEAST PART RUSHFORD T.18N.-R.15E.

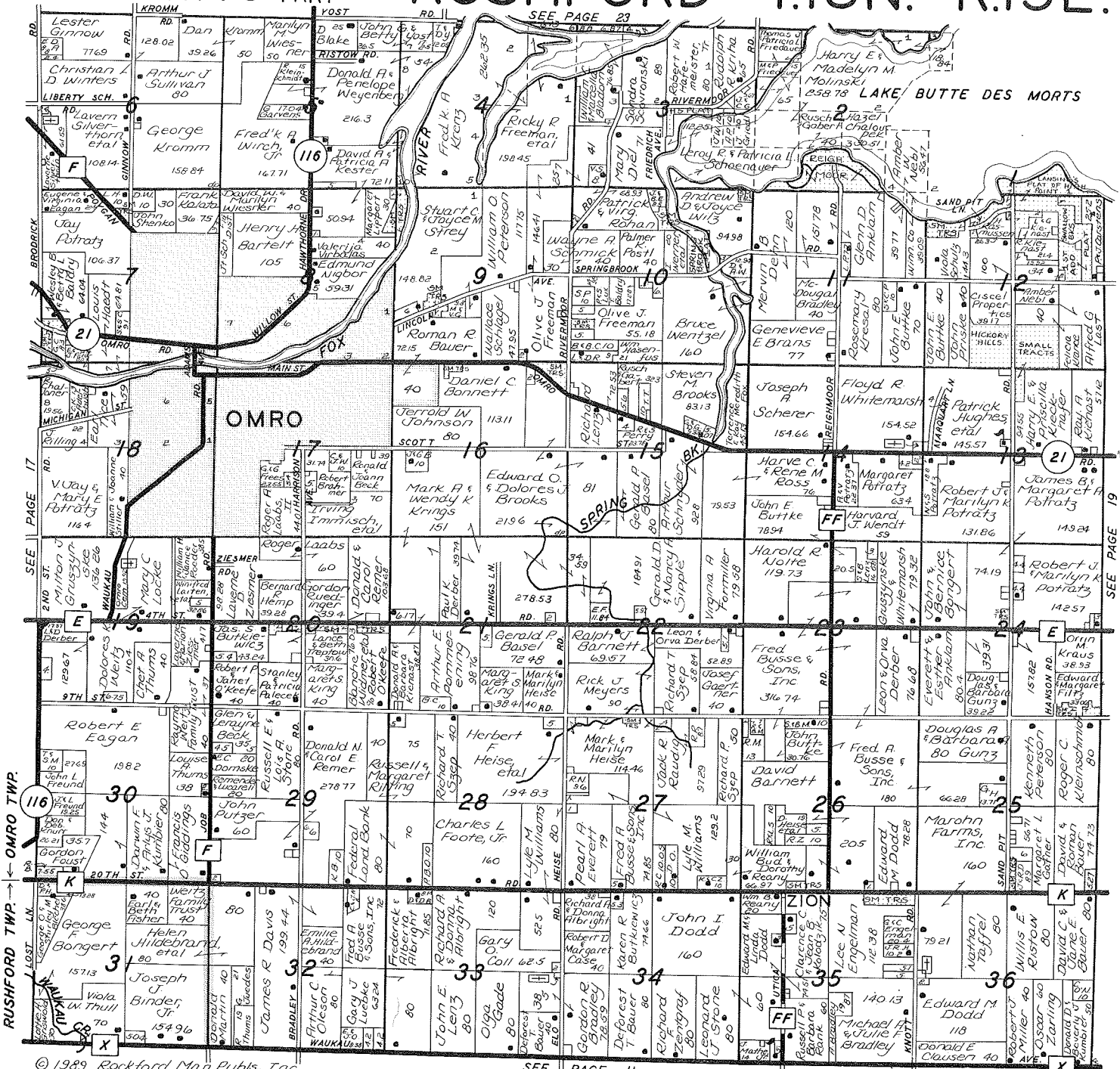

OMRO  
685-2771

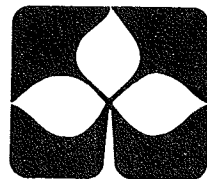

**F&M  
Bank**

WINNECONNE  
582-4351

YOUR FINANCIAL MANAGEMENT CENTER  
See us for ALL your banking needs.



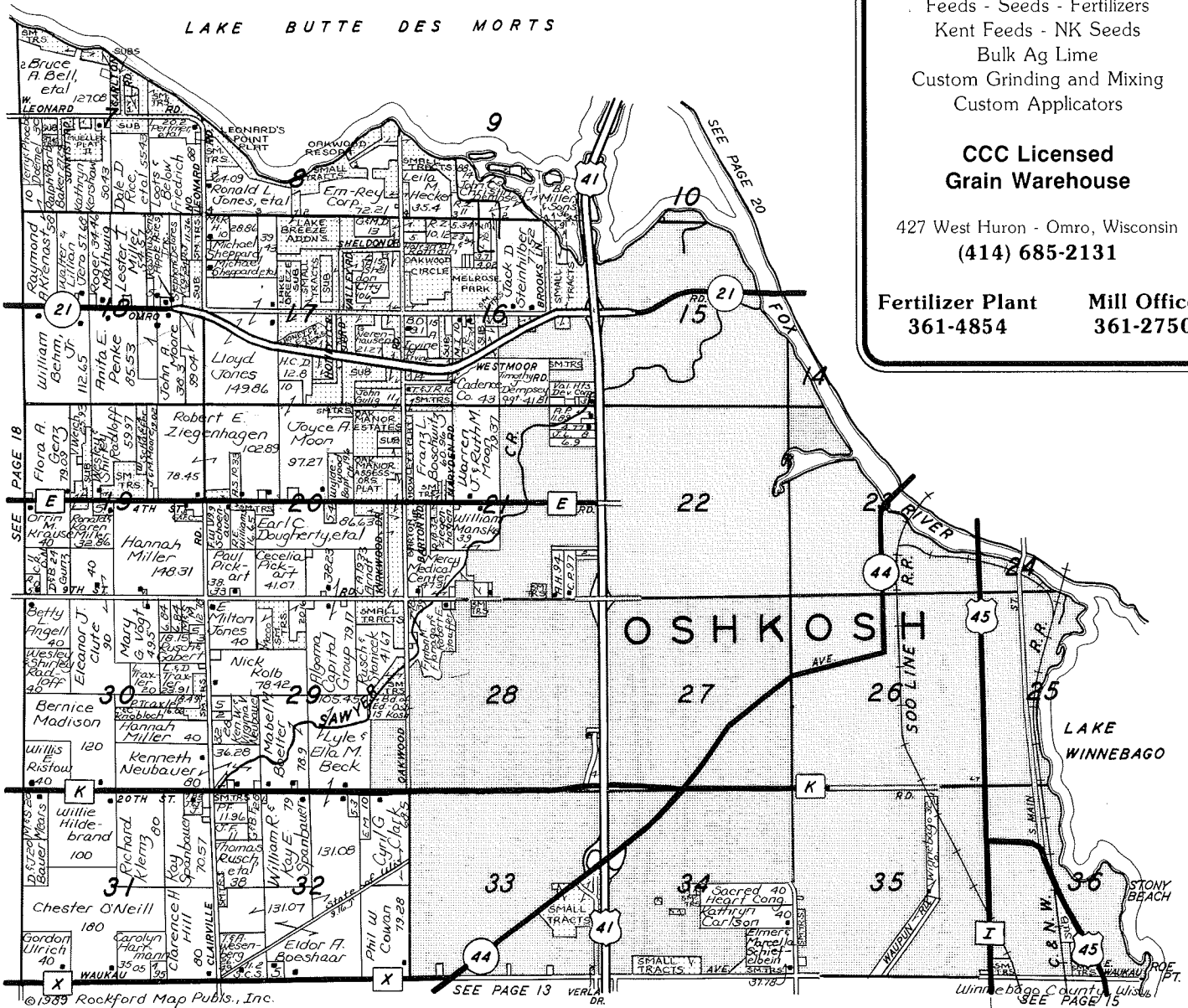

## Olsen's Mill, Inc.

Feeds - Seeds - Fertilizers  
Kent Feeds - NK Seeds  
Bulk Ag Lime  
Custom Grinding and Mixing  
Custom Applicators

**CCC Licensed  
Grain Warehouse**

427 West Huron - Omro, Wisconsin  
**(414) 685-2131**

<b>Fertilizer Plant</b> 361-4854	<b>Mill Office</b> 361-2750
-------------------------------------	--------------------------------

**PHONE:**  
Oshkosh 235-7580  
Neenah 772-7526



"USED FOOD DEALER"

## Winnebago Liquid Waste

HOLDING TANKS, SEPTIC TANKS, GREASE TRAPS

DAVE CONGER  
Owner

5097 Sherman Road  
Oshkosh, Wisconsin 54901

# Dehn Trucking

Livestock Hauling & Grain Trucking

2299 West Fisk Avenue  
Oshkosh, Wisconsin 54901

**(414) 235-1114**

# OSHKOSH T.18-19N.-R.16-17E.

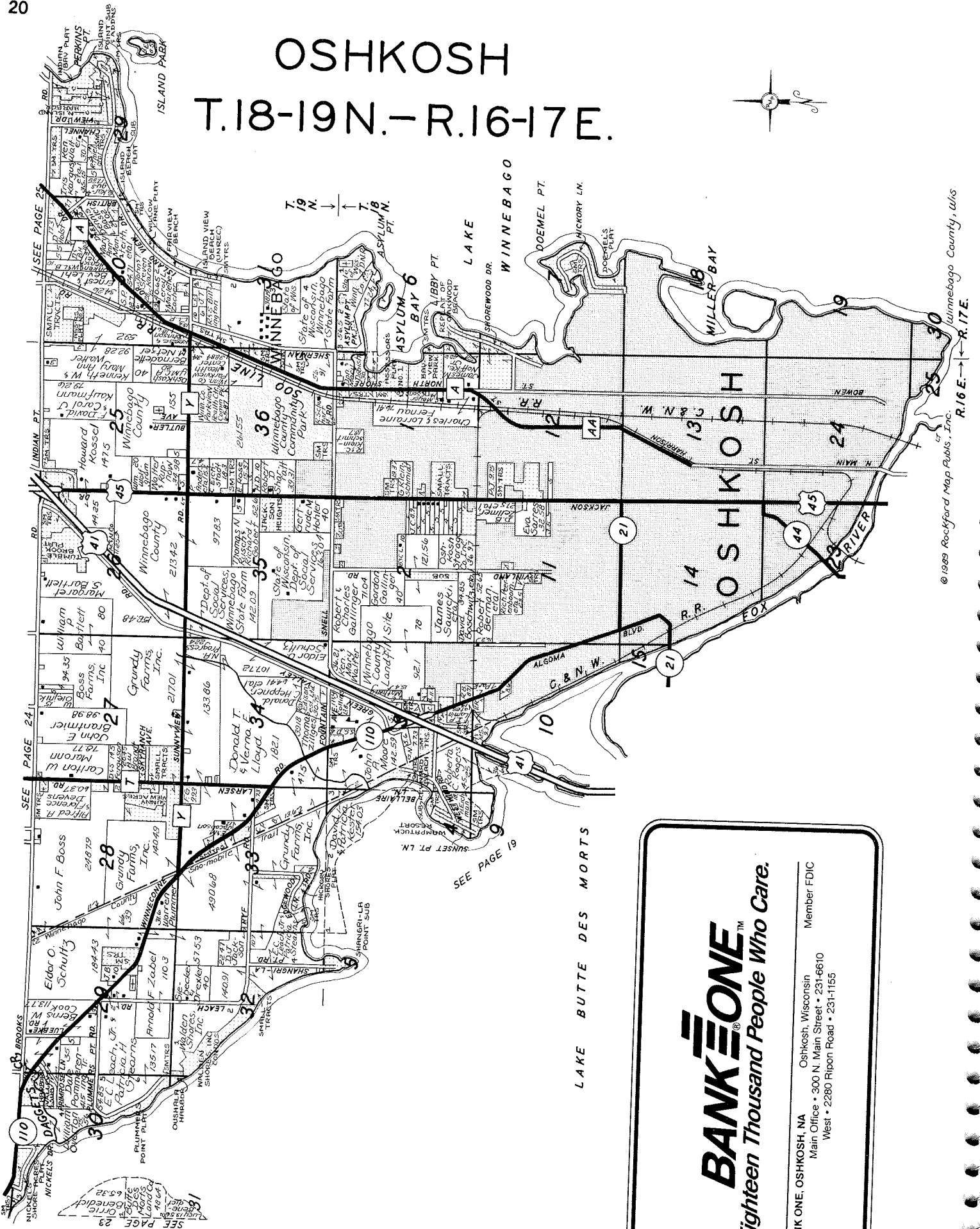
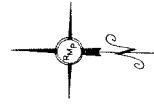

© 1989 Rockford Map Pubs., Inc. Winnebago County, Wis. R.16E. → R.17E.

LAKE BUTTE DES MORTS

**BANK ONE**<sup>TM</sup>  
Eighteen Thousand People Who Care.

---

BANK ONE, OSHKOSH, WI  
 Oshkosh, Wisconsin  
 Main Office • 300 N. Main Street • 231-6610  
 West • 2280 Ripon Road • 231-1155

Member FDIC

SEE PAGE 26

LAKE POYGAN

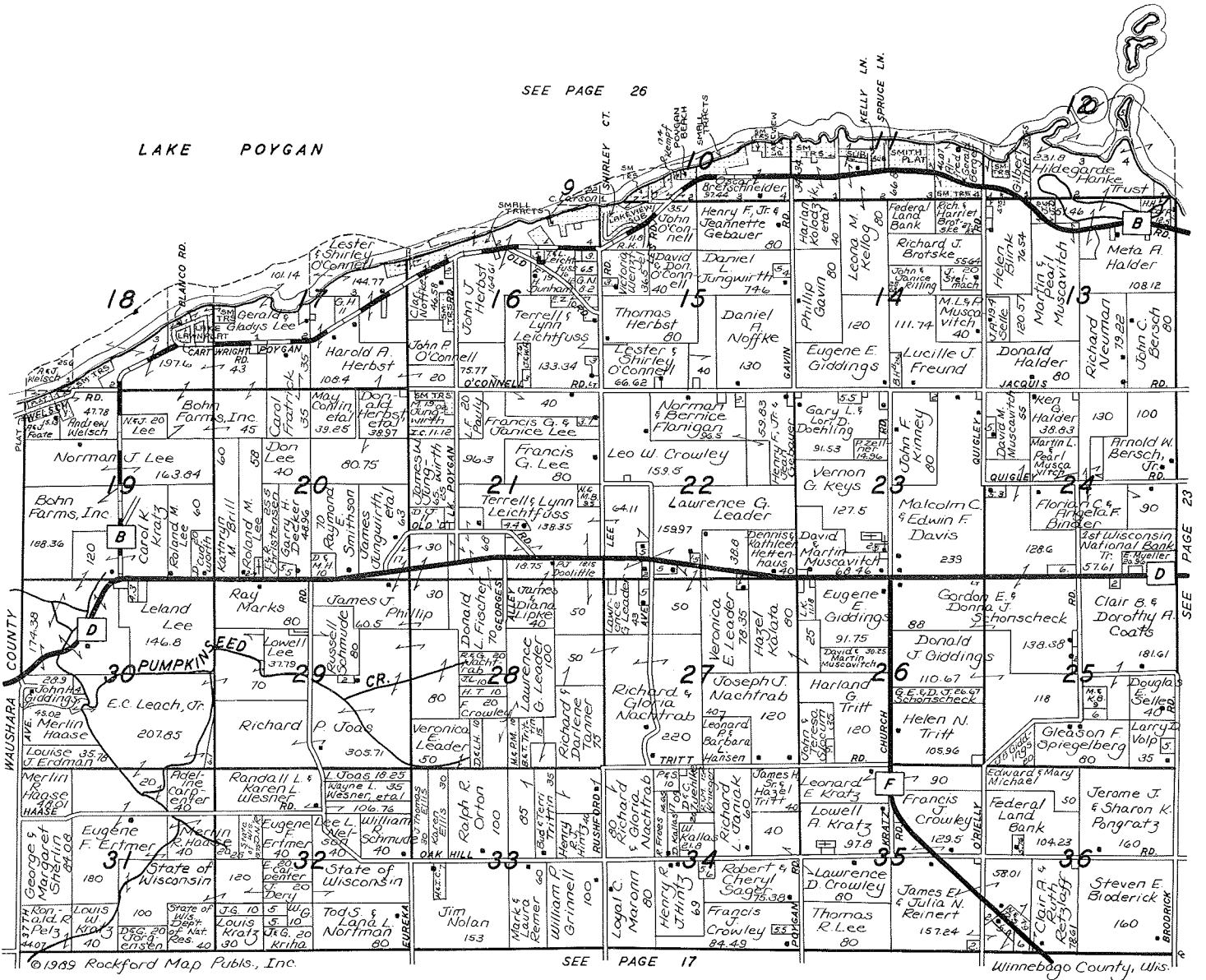

SEE PAGE 17

Winnepago County, Wis.

# WAUPACA CO. MUTUAL INSURANCE CO.

P.O. BOX 220 - READFIELD, WISCONSIN 54969

Farm Owners - Homeowners - Commercial - Liability - Inland Marine

Home Office: (414) 667-4308

Serving: Winnebago - Outagamie - Waupaca & Waushara Counties



## THE HARMON AGENCY, INC.

"Three Generations of Service Since 1902"

COMPLETE INSURANCE SERVICE

1600 South Main Street, P.O. Box 44, Oshkosh, Wisconsin 54902-0044 — Phone: (414) 235-3540



**Sayler**  
**Survey, Inc.**

land surveyors

SURVEYING THE AREA SINCE 1947

CERTIFIED

Surveys • Maps • Plats • Farm Surveys • Subdivisions  
 As Built Plans

**(414) 582-4234**

139A West Main - Box 252 - Winneconne, Wisconsin 54986

**BOB'S**  
**PARK & SAVE**

**915 E. Main, WINNECONNE**

**582-4362**

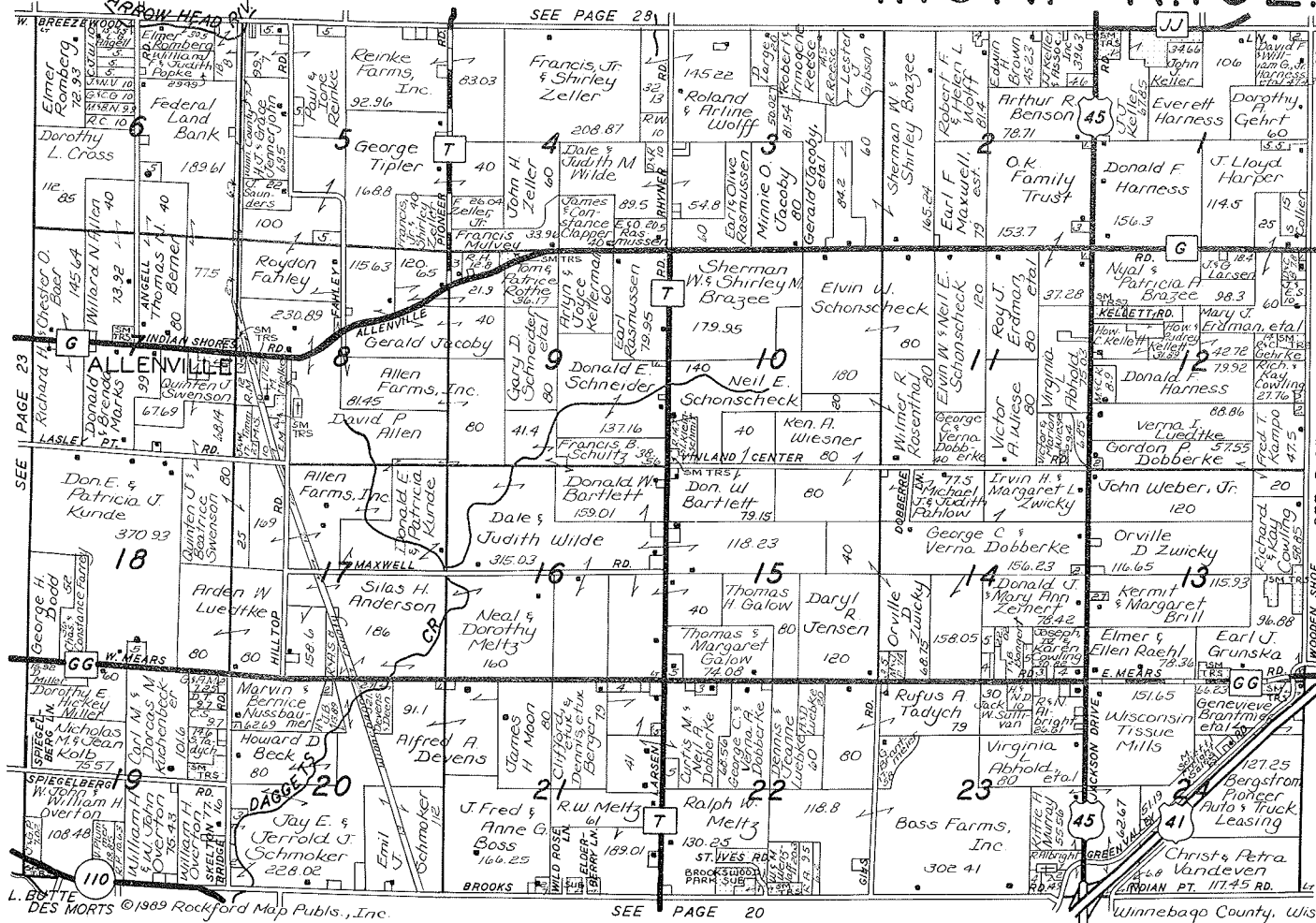

L. B. WHITE DES MORTS ©1989 Rockford Map Publs., Inc.

SEE PAGE 20

SEE PAGE 25



Auto  
 Fire, Wind and Liability, Crop-Hail  
 Commercial, Farm Owner and Homeowner Policies  
 Umbrella Liability - Prompt Claim Services

George A. Tipler  
**836-3577**

Jack Zeller  
**836-2993**

8075 Pioneer Road - Oshkosh, Wisconsin 54901

### KRUEGER ACCOUNTING & TAX SERVICE

Gerald W. Krueger, C.P.A.

33 South 2nd Street  
 P.O. Box 300  
 Winneconne, Wisconsin  
 54986  
 (414) 582-4577

122 East Main Street  
 P.O. Box 530  
 Weyauwega, Wisconsin  
 54983  
 (414) 867-3841

### Harold N. Schonscheck Trucking Inc.

5943 Larsen Road — Oshkosh, Wisconsin 54904

Phone: (414) 231-1688

Grade "A" Milk Hauling to Borden's  
 Galloway West — Fond du Lac, Wisconsin



© 1989 Rockford Map & Publs., Inc. SEE PAGE 20 Winnebago County, Wis

**ASSOCIATED**  
BANK

*Get your Service*

<p><b>Appleton</b> Fox River Mall 4301 Wisconsin Avenue • 738-5220</p> <p><b>Grand Chute</b> 1500 North Casaloma Drive • 738-5200</p> <p><b>Northland</b> 600 East Northland Avenue • 738-5205</p>	<p><b>Kimberly</b> 600 West Kimberly Avenue • 738-5210</p> <p><b>Menasha</b> Highways 10 &amp; 114 • 731-6408</p> <p><b>Oshkosh</b> 5307 North Shore Drive • 233-2260</p>	<p><b>Neenah</b> Downtown 100 West Wisconsin Avenue • 722-3321</p> <p><b>Neenah West</b> 1055 Winneconne Avenue • 727-3500</p> <p><b>Westridge</b> Highway 150 &amp; Clayton Road • 727-3505</p>
--	---	--



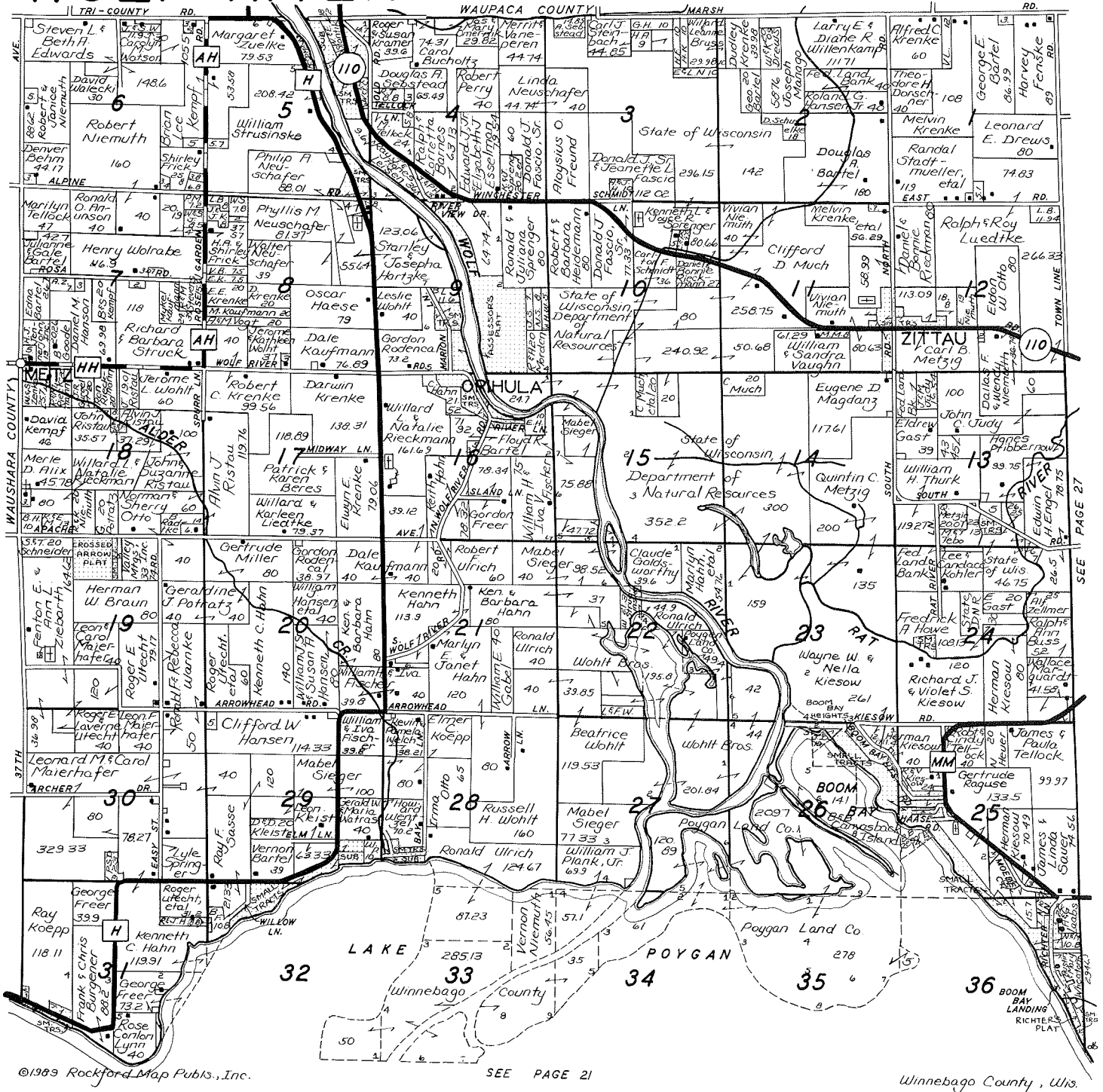

©1989 Rockford Map Pubs., Inc.

SEE PAGE 21

Winnebago County, Wis.

Larsen Subscribers Call Enterprise 6320  
**MUELLER FUNERAL HOME**  
 RONALD R. MUELLER, Director  
 (414) 582-4242  
 208 West Main Street — Winneconne, Wisconsin 54986

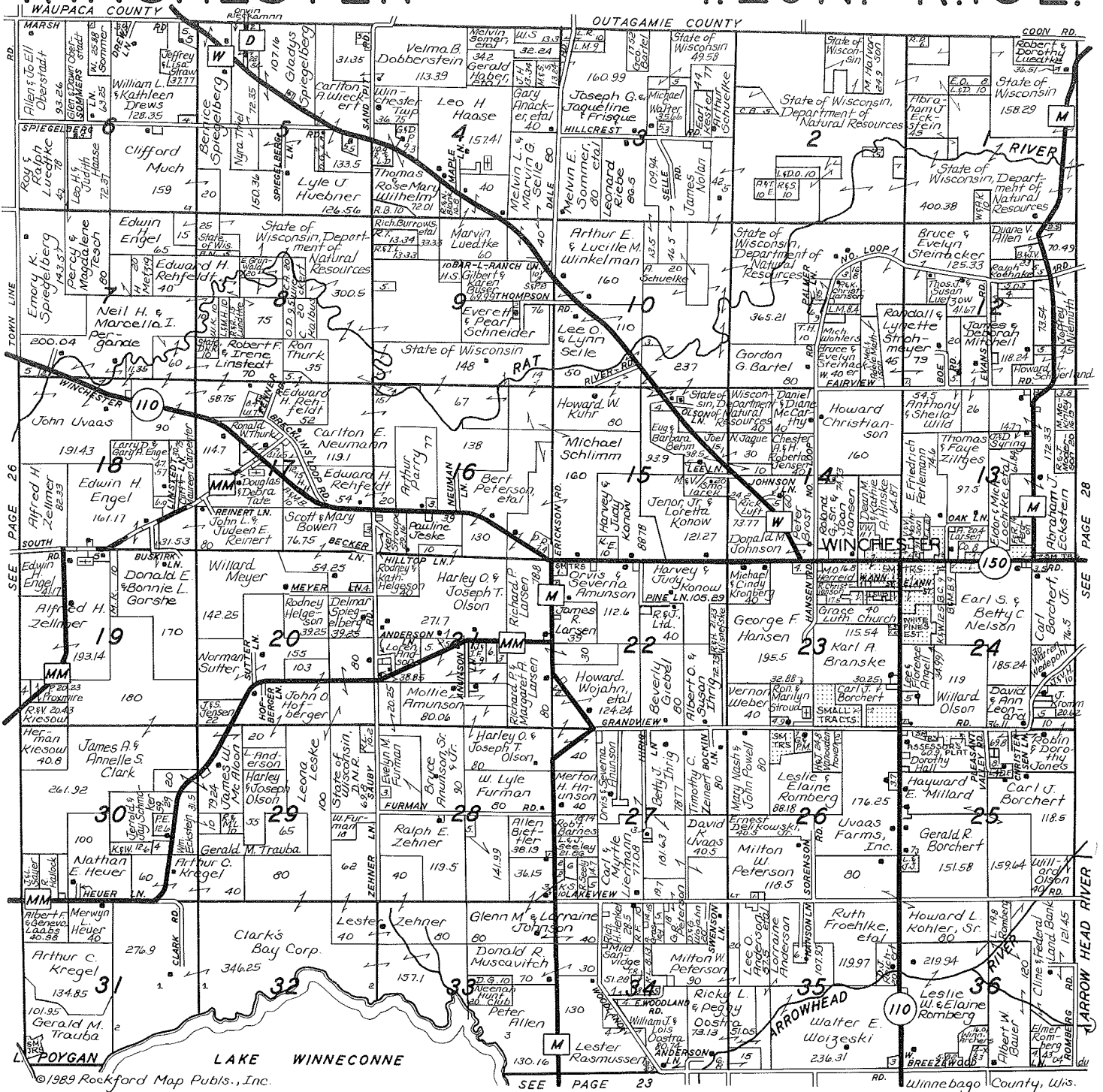

©1989 Rockford Map Pubs., Inc.

## PLEASE PATRONIZE THE ADVERTISERS

### THEY WILL WELCOME THE OPPORTUNITY TO SERVE YOU

# OMNI ENGINEERS

- ENGINEERS
- ARCHITECTS
- SURVEYORS
- PLANNERS
- SCIENTISTS

303 S. BLUEMOUND DR. • APPLETON, WI • 54914 • (414) 739-7814

"We provide the complete package... from surveying & platting to architectural & engineering design/build to pre-purchase assessments... underground storage tank testing, investigations & closures... to landfills... to waste water treatment... to bridges and roads."

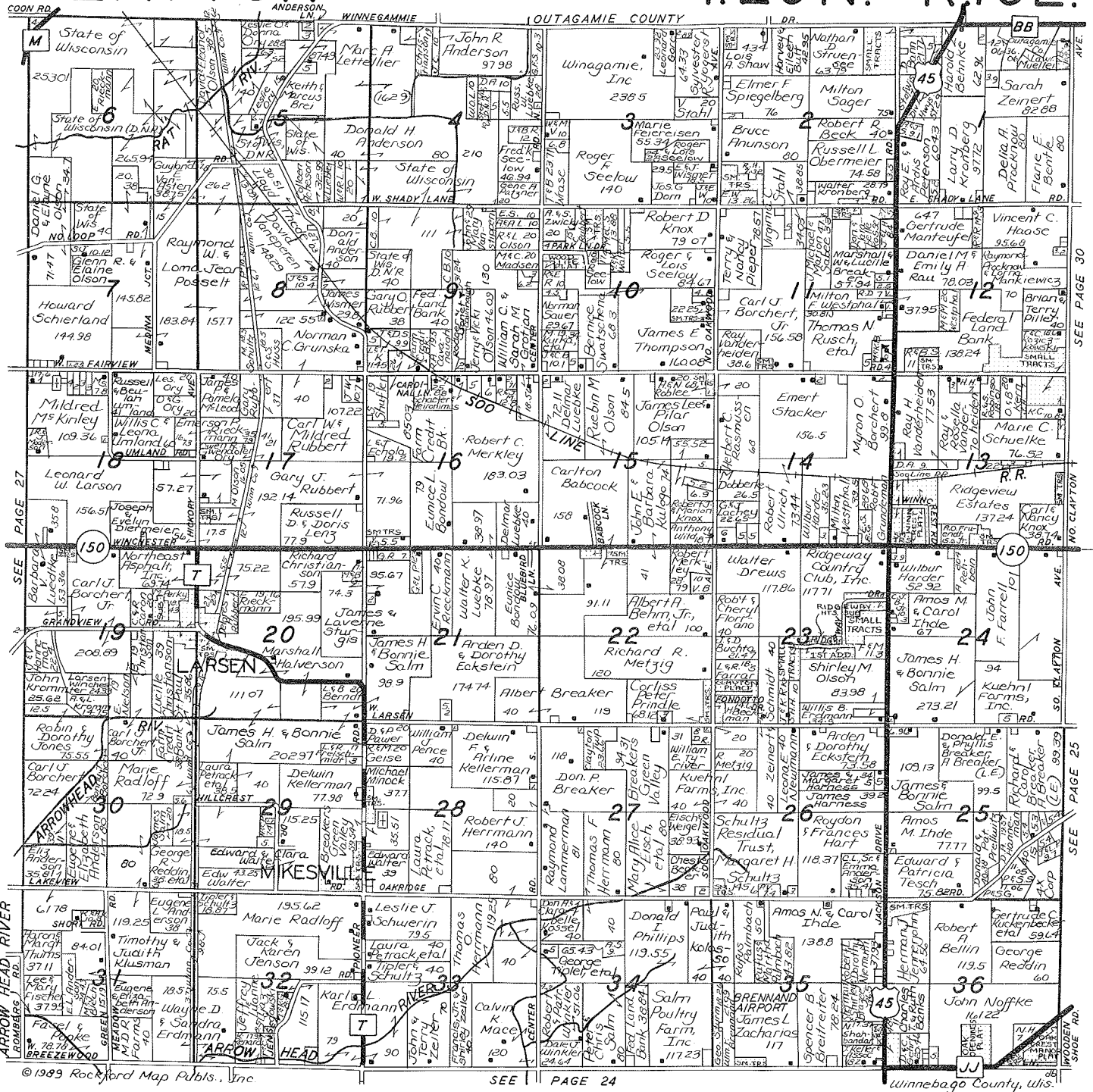

© 1989 Rockford Map Pubs., Inc.

SEE PAGE 24

Winnebago County, Wis.

# BANK ONE

*Eighteen Thousand People Who Care.*

BANK ONE, NEENAH, NA      Neenah, Wisconsin      Member FDIC  
 Main Office • 111 East Wisconsin Avenue • 725-4371  
 Larsen Office • 4487 Grandview Road • 836-2101

# MENASHA

# T.20N.-R.17E.

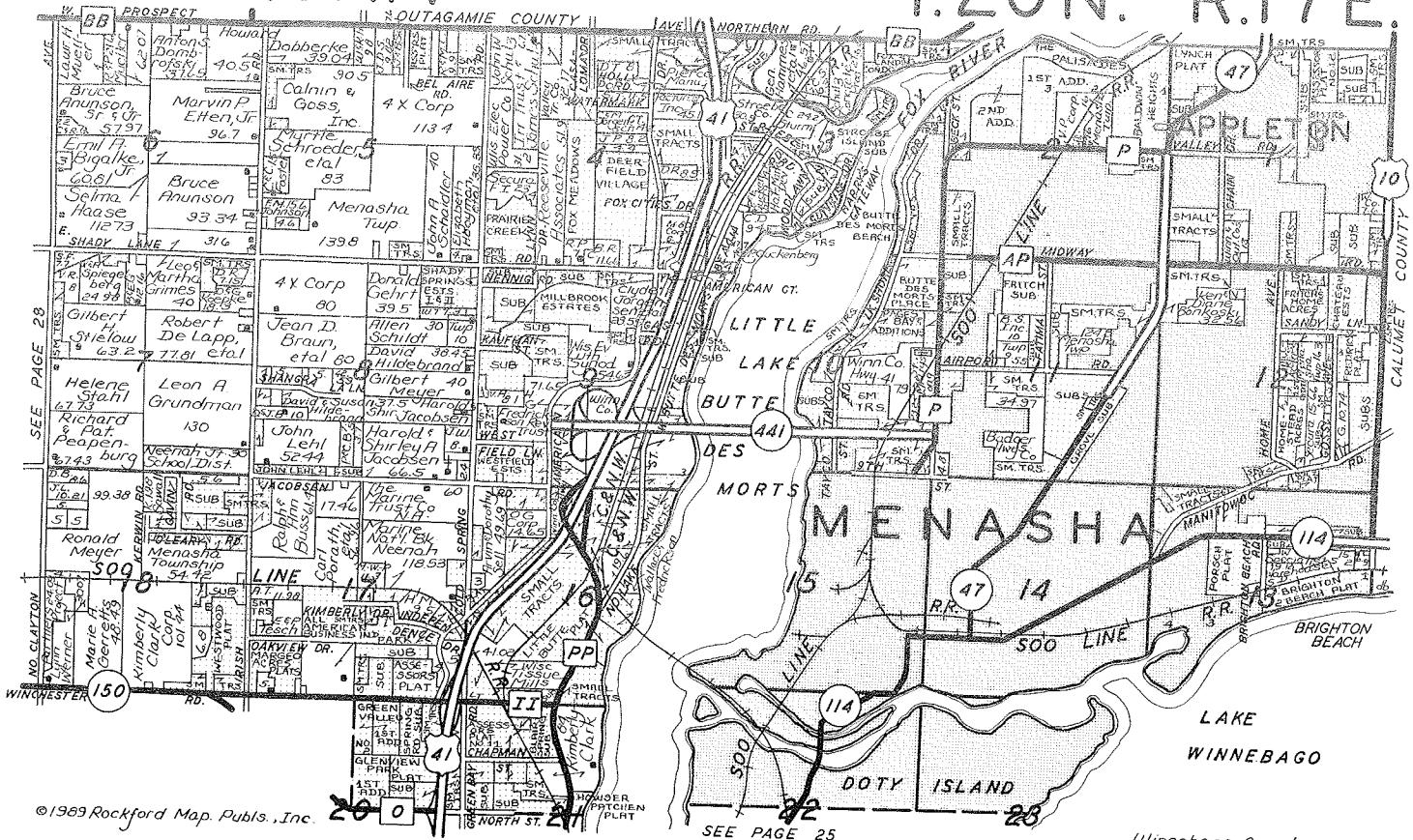

©1989 Rockford Map. Publs., Inc.

SEE PAGE 25

Winnebago County, Wis.

# Rsi

## REFUSE SERVICE, INC.

RESIDENTIAL, COMMERCIAL, INDUSTRIAL  
 SPECIAL PICK-UP & DOCKSIDE REMOVAL  
 REMODELING & CONSTRUCTION SERVICE  
 TOWNSHIP & MUNICIPAL CONTRACTS

### 722-0165

937 Haase - Neenah, Wisconsin 54956

We help keep America beautiful.  
With your help.



## GALLOWAY

THE THIRD GENERATION COMPANY

A BETTER MARKET FOR YOUR PRODUCTS  
WE OFFER YOU BOTH GRADE "A" AND  
MANUFACTURED MARKETS

601 South Commercial Street  
 P.O. Box 609  
 Neenah, Wisconsin 54956  
 (414) 722-7741

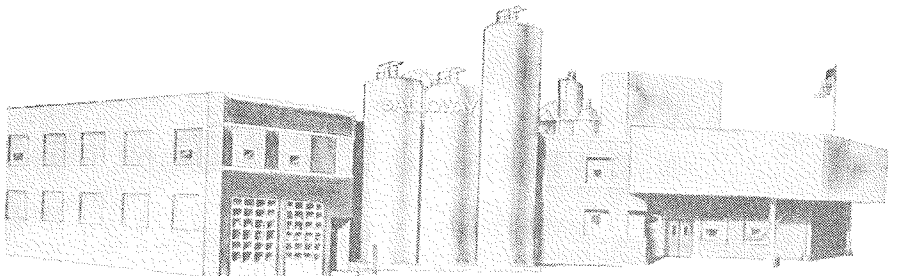



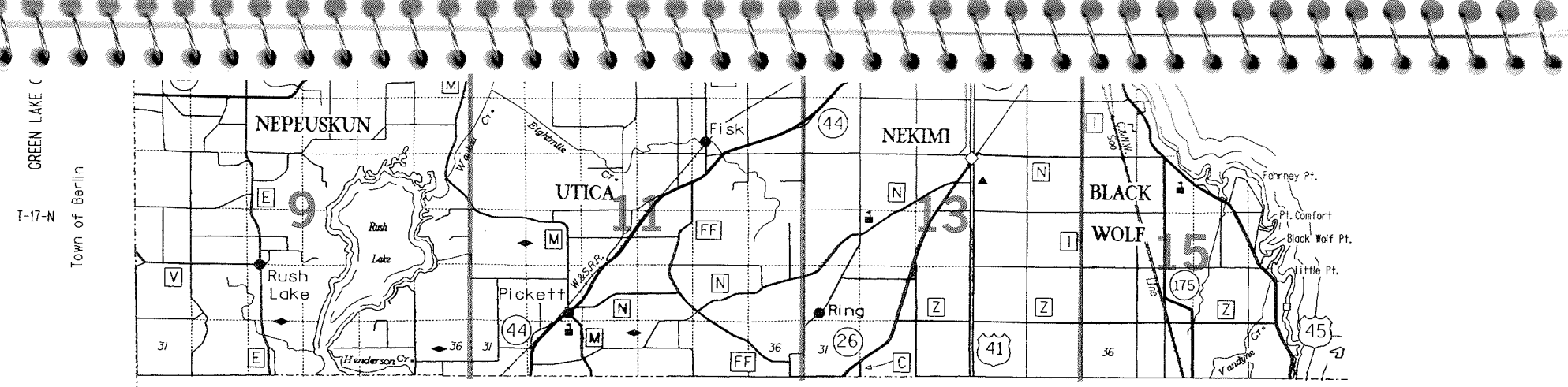
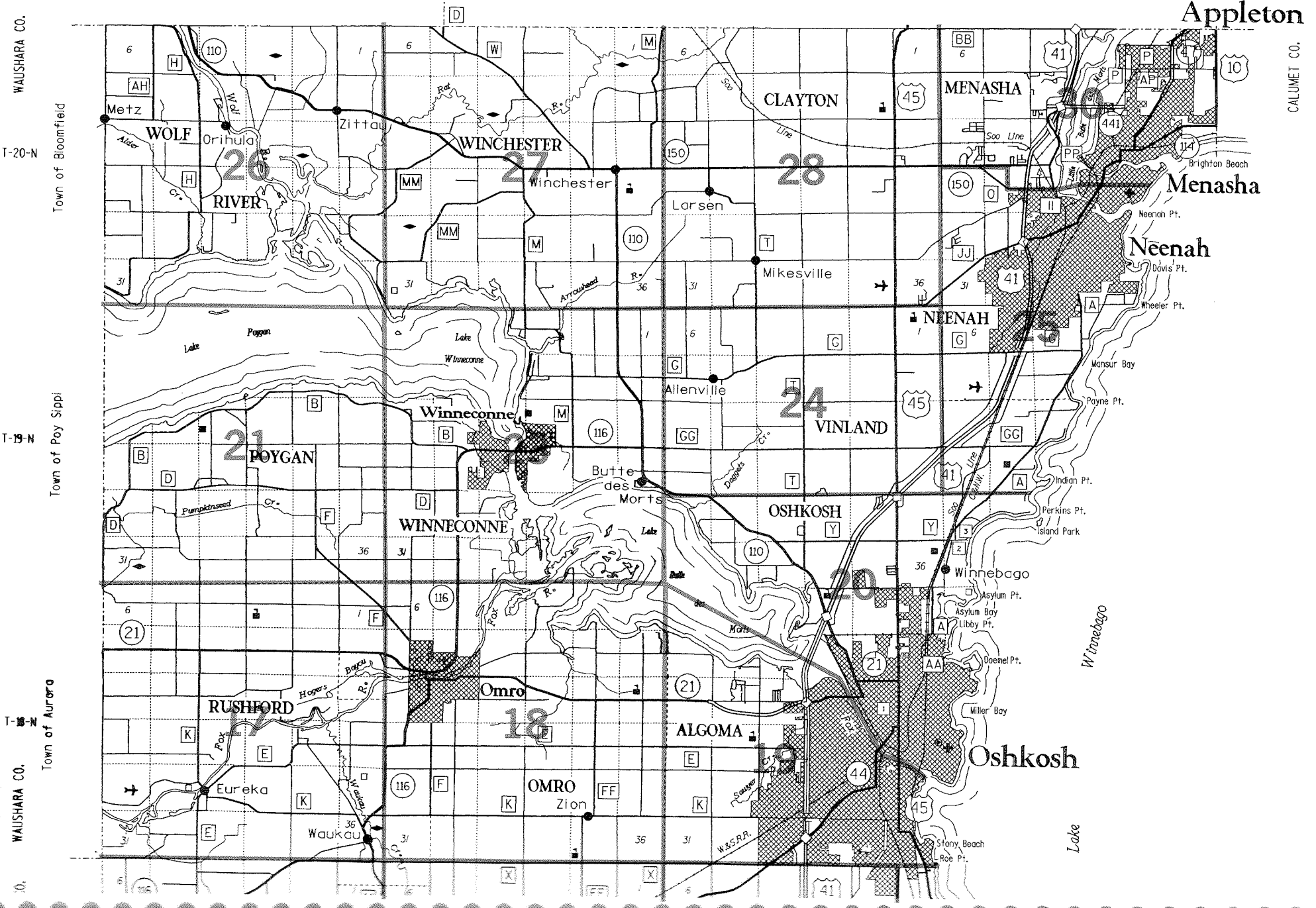

**LEGEND**

- |                                  |                         |   |     |
|----------------------------------|-------------------------|---|-----|
| Freeway                          | =====<br>=====<br>===== | Dam                                     | — — |
| U.S. or State Highway            | —————                   | Hospital                                | +   |
| County Trunk Highway             | —————                   | Schools                                 | ■   |
| Town Road                        | —————                   | Airport                                 | ✈   |
| Firelane                         | .....                   | County Seat                             | ◎   |
| Multilane Divided                | =====<br> <br>=====     | Unincorporated Village                  | ●   |
| Interchange                      | — —<br> <br>— —         | Fish Hatchery                           | — — |
| Highway Separation               | =====<br> <br>=====     | Game Farm                               | ◆   |
| Interstate Highway No.           | 94                      | Public Hunting or Fishing Grounds       | — — |
| U.S. Highway No.                 | 18                      | Public Camp & Picnic Grounds            | ▲   |
| State Highway No.                | 59                      | Ranger Station                          | ⌘   |
| County Highway Letter            | T                       | State Park —                            |     |
| Railroad                         | — —                     | With Campsites                          | ▲   |
| State Boundary                   | -----                   | Without Campsites                       | △   |
| County Boundary                  | -----                   | County Park —                           |     |
| Civil Town Boundary              | -----                   | With Facilities                         | ■   |
| Section Line                     | -----                   | Without Facilities                      | □   |
| Corporate Limits                 | ▨                       | Wayside —                               |     |
| National & State Forest Boundary | ▨                       | With Facilities                         | ▲   |
|                                  |                         | Without Facilities                      | △   |
|                                  |                         | University of Wisconsin - Oshkosh       | 1   |
|                                  |                         | Winnebago Mental Health Institute       | 2   |
|                                  |                         | Winnebago Camp Correctional Institution | 3   |
- ◆ For boundaries of public hunting and fishing grounds please contact the Department of Natural Resources.

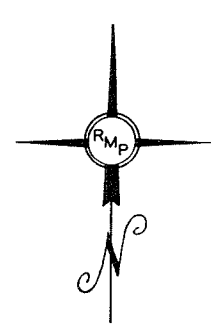

**MAP PAGE DIVISIONS SHOWN IN RED**

**ALPHABETICAL INDEX FOR TOWNSHIP MAPS**

Township	Page
ALGOMA	19
BLACK WOLF	15
CLAYTON	28
MENASHA	30
NEENAH	25
NEKIMI	13
NEPEUSKUN	9
OMRO	17,18
OSHKOSH	20
POYGAN	21
RUSHFORD	9,11,17,18
UTICA	11
VINLAND	24,25
WINCHESTER	27
WINNECONNE	23
WOLF RIVER	26

**GENERAL HIGHWAY MAP  
WINNEBAGO COUNTY**

**WISCONSIN**  
BASE MAP PREPARED BY  
**DEPARTMENT OF TRANSPORTATION**  
STATE OFFICE BUILDING  
Madison, Wisconsin

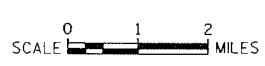

INDEX TO OWNERS

SMALL TRACT OWNERS ARE NOT SHOWN ON TOWNSHIP MAPS, HOWEVER THEY ARE KEYED BY QUARTER SECTIONS: NORTHEAST QUARTER BY A, NORTHWEST QUARTER BY B, SOUTHWEST QUARTER BY C, SOUTHEAST QUARTER BY-D, THIS SHOWING GENERAL LOCATION

Table with 4 columns: Name, Sec.-Pg., Name, Sec.-Pg. Lists property owners and their section/page numbers, including entries for A, B, and C.





INDEX TO OWNERS

SMALL TRACT OWNERS ARE NOT SHOWN ON TOWNSHIP MAPS, HOWEVER THEY ARE KEYED BY QUARTER SECTIONS: NORTHEAST QUARTER BY A, NORTHWEST QUARTER BY B, SOUTHWEST QUARTER BY C, SOUTHEAST QUARTER BY D, THIS SHOWING GENERAL LOCATION

Table with 5 columns: Name, Sec.-Pg., Name, Sec.-Pg., Name, Sec.-Pg., Name, Sec.-Pg., Name, Sec.-Pg. listing property owners and their corresponding section and page numbers.

INDEX TO OWNERS

SMALL TRACT OWNERS ARE NOT SHOWN ON TOWNSHIP MAPS, HOWEVER THEY ARE KEYED BY QUARTER SECTIONS: NORTHEAST QUARTER BY A, NORTHWEST QUARTER BY B, SOUTHWEST QUARTER BY C, SOUTHEAST QUARTER BY D, THIS SHOWING GENERAL LOCATION

Table with 4 columns: Name, Sec.-Pg., Name, Sec.-Pg. Lists property owners and their section/page numbers across the page.

INDEX TO OWNERS

SMALL TRACT OWNERS ARE NOT SHOWN ON TOWNSHIP MAPS, HOWEVER THEY ARE KEYED BY QUARTER SECTIONS: NORTHEAST QUARTER BY A, NORTHWEST QUARTER BY B, SOUTHWEST QUARTER BY C, SOUTHEAST QUARTER BY D, THIS SHOWING GENERAL LOCATION

Table with columns: Name, Sec.-Pg., Name, Sec.-Pg., Name, Sec.-Pg., Name, Sec.-Pg., Name, Sec.-Pg. Lists owners and their corresponding section/page numbers across five columns.

INDEX TO OWNERS

SMALL TRACT OWNERS ARE NOT SHOWN ON TOWNSHIP MAPS, HOWEVER THEY ARE KEYED BY QUARTER SECTIONS: NORTHEAST QUARTER BY A, NORTHWEST QUARTER BY B, SOUTHWEST QUARTER BY C, SOUTHEAST QUARTER BY D, THIS SHOWING GENERAL LOCATION

Table with multiple columns: Name, Sec.-Pg., Name, Sec.-Pg., Name, Sec.-Pg., Name, Sec.-Pg., Name, Sec.-Pg., Name, Sec.-Pg. The table lists numerous owners and their corresponding section and page numbers, organized alphabetically by name.

INDEX TO OWNERS

SMALL TRACT OWNERS ARE NOT SHOWN ON TOWNSHIP MAPS, HOWEVER THEY ARE KEVED BY QUARTER SECTIONS: NORTHEAST QUARTER BY A, NORTHWEST QUARTER BY B, SOUTHWEST QUARTER BY C, SOUTHEAST QUARTER BY D, THIS SHOWING GENERAL LOCATION

Table with columns: Name, Sec.-Pg., Name, Sec.-Pg., Name, Sec.-Pg., Name, Sec.-Pg. Lists property owners and their corresponding section numbers across four quadrants.





INDEX TO OWNERS

SMALL TRACT OWNERS ARE NOT SHOWN ON TOWNSHIP MAPS, HOWEVER THEY ARE KEYED BY QUARTER SECTIONS: NORTHEAST QUARTER BY A, NORTHWEST QUARTER BY B, SOUTHWEST QUARTER BY C, SOUTHEAST QUARTER BY D, THIS SHOWING GENERAL LOCATION

Table listing owners and their township sections. Columns include Name, Sec.-Pg., Name, Sec.-Pg., Name, Sec.-Pg., Name, Sec.-Pg., Name, Sec.-Pg. The entries are sorted alphabetically by owner name across the columns.

INDEX TO OWNERS

SMALL TRACT OWNERS ARE NOT SHOWN ON TOWNSHIP MAPS, HOWEVER THEY ARE KEYED BY QUARTER SECTIONS: NORTHEAST QUARTER BY A, NORTHWEST QUARTER BY B, SOUTHWEST QUARTER BY C, SOUTHEAST QUARTER BY D, THIS SHOWING GENERAL LOCATION

Table with 5 columns: Name, Sec.-Pg., Name, Sec.-Pg., Name, Sec.-Pg. Lists owners and their corresponding section/page numbers across the township.

INDEX TO OWNERS

SMALL TRACT OWNERS ARE NOT SHOWN ON TOWNSHIP MAPS, HOWEVER THEY ARE KEYS BY QUARTER SECTIONS: NORTHEAST QUARTER BY A, NORTHWEST QUARTER BY B, SOUTHWEST QUARTER BY C, SOUTHEAST QUARTER BY D, THIS SHOWING GENERAL LOCATION

Table with multiple columns: Name, Sec.-Pg., Name, Sec.-Pg., Name, Sec.-Pg., Name, Sec.-Pg. Lists property owners and their respective section numbers across four quadrants.



INDEX TO OWNERS

SMALL TRACT OWNERS ARE NOT SHOWN ON TOWNSHIP MAPS, HOWEVER THEY ARE KEYED BY QUARTER SECTIONS: NORTHEAST QUARTER BY A, NORTHWEST QUARTER BY B, SOUTHWEST QUARTER BY C, SOUTHEAST QUARTER BY D, THIS SHOWING GENERAL LOCATION

Table with columns: Name, Sec.-Pg. Includes entries like KWAKKEL, W 31 11, KWON, KUN 3D 30, KWON, TAE K 3D 30, L & M REAL ESTATE INC 16 13, LA BRECHE, J REX 15B 17, LA COUNTE, JOYCE 25C 26, LA FONTAINE, JACK F 12B 18, LA FOUNTAIN, BARB 8C 25, LA FOUNTAIN, DON J 8C 25, LA MANICE, RUTH R 10 13, LAABS, A 36 26, LAABS, ALBERT F 36A 26, LAABS, ALBERT F 31 27, LAABS, BRIAN 16C 27, LAABS, DARLENE 9C 19, LAABS, G 36 26, LAABS, GARY R 19 11, LAABS, GENEVA 31 27, LAABS, GENEVA 36A 26, LAABS, LAWRENCE L 28D 27, LAABS, ROBERT L 27D 28, LAABS, ROGER 20 18, LAABS, ROGER A II 17 18, LABARGE, BONNIE 7A 30, LABARRE, AMY 3D 30, LABARRE, DENNIS 3D 30, LABELLE, L 18 23, LABELLE, LEON 18B 23, LABRECHE, DOR 15B 17, LABUS, BERNICE 19A 15, LABUS, STEV 19A 15, LABUWI, DAVID 32B 11, LABUWI, JOHN 25C 17, LABUWI, JOHN 36A 17, LACHER, ROBERT 36A 26, LACHEY, G 14 28, LACHEY, J 14 28, LADWIG, MARTHA 2A 13, LADWIG, MARY 12D 17, LADWIG, THOMAS G 12D 17, LAEDTKE, GREG W 13D 27, LAEDTKE, JANE 13D 27, LAEDTKE, LESTER C 20C 28, LAFEVER, CAROL 16A 26, LAFEVER, MILES 16A 26, LAFEVER, MILES ETAL 16A 26, LAFLEX, VELDA A 12D 28, LAFOND, LORR 8C 30, LAFOND, RICH 8C 30, LAGEMAN, WM JR 22A 13, LAGER, KAREN 11C 28, LAGER, THOS M 11C 28, LAGORIO, ANN 36A 15, LAGORIO, RANDALL 36A 15, LAITEN, WINFRED ETAL 19 18, LAKE BREZE ADDNS 17 19, LAKE BREZE SUB 17 19, LAKE LAWN PLAT 18 21, LAKE WIND CORP 24 23, LAKEVIEW LTD PARTNERHSP 30C 20, LAKEVIEW PLAT 10 21, LAKEVIEW SUB 15 21, LAKEWIND PLAT 24 23, LAMARCHE, KEVIN 29D 25, LAMARCHE, MICHELLE 29D 25, LAMB, LOIS BIETTLER 23A 27, LAMENSKY, CARRIE 9C 25, LAMENSKY, TODD 9C 25, LAMERS, CORNELIUS H 16B 21, LAMERS, PETER C 9D 23, LAMINATES, E P 3 20, LAMMERMAN, RAYMOND 27 28, LAMORE, KATHRYN 3C 25, LAMPE, RONALD L 8D 19, LAMPE, SHARON 8D 19, LAMSON, DONALD W 18A 15, LANCASTER, LARRY R 30A 25, LANCASTER, PENNY 30A 25, LANDOLT, JAS 29D 20, LANDOLT, STEPHEN H 18A 13, LANDSKRON, HOLLIS 3A 30, LANDSKRON, ROY B 3A 30, LANDSVERK, JEROME A 16C 25, LANDSVERK, MARVIN R 36A 26, LANDSVERK, SANDRA 16C 25, LANG, DENNIS R 4 23, LANG, DIANE 32C 19, LANG, JAMES H 2D 20, LANG, JAS H 21A 19, LANG, JERRY 32C 19, LANG, JULIE 30A 13, LANG, MICHAEL J 30A 13, LANG, NANCY 31C 26, LANG, ROBT 31C 26, LANGE, C 17 15, LANGE, EDW 21B 15, LANGE, EDWARD G 21B 15, LANGE, MARUERITE 21B 15, LANGE, MARY 33D 15, LANGE, PAUL 21B 15, LANGE, ROSS 33D 15, LANGEBERG, BEA 9D 17, LANGEBERG, DOUG 34 17, LANGEBERG, ERNEST K 27 17, LANGEBERG, ERNEST K 27D 17, LANGEBERG, HERMAN C 9D 17, LANGEBERG, MARJORIE 27 17, LANGEBERG, ROGER 27 17, LANGEBERG, ROGER 27D 17, LANGENBERG, ELEANOR 16C 25, LANGENBERG, J G 2B 17

Table with columns: Name, Sec.-Pg. Includes entries like LANGENBERG, ROBERT W 16C 25, LANGENHUIZEN, DIANA 23D 27, LANGENHUIZEN, GYR 23D 27, LANGENHUIZEN, LEE 2B 28, LANGHOFF, KIM 24A 15, LANGHOFF, LOUIS L 18A 19, LANGHOFF, RODNEY 24A 15, LANGKAU, RICHARD 28D 20, LANGLITZ-FILLMORE INV 8A 18, LANGLITZ, JANE M 16C 19, LANSING'S PLAT HIGH PT 1 18, LAPINE, CLIFFORD A 19C 25, LAPLANTE, K 17 23, LAPLANTE, KENNETH R 8C 23, LAPLANTE, S 17 23, LAPLANTE, SALLY 8C 23, LAPOINT, DAVID M 19A 24, LAPOINT, LORETTA 33A 15, LAPOINT, RICHARD H 33A 15, LAPP, CHARLES D 12D 28, LAPP, GLADYS 18B 23, LAPP, JENNIFER 12D 28, LAPP, JOS 18B 23, LARABELL, KATHRYN 31C 25, LARABELL, TIMOTHY 31C 25, LARGE, D 3 24, LARIE, ANNETTE 4B 13, LARIE, KEN 4B 13, LAROUX, GERALDINE 9B 13, LAROUX, VERN 9B 13, LARSEN CO-OP 20B 28, LARSEN CO-OP 20C 28, LARSEN-READFIELD TELE 24A 27, LARSEN-READFIELD TELE 25D 26, LARSEN-WINCHESTER 19 28, LARSEN, A 13 27, LARSEN, ARTHUR R 13C 27, LARSEN, CAROL 29D 20, LARSEN, DANIEL E 30A 25, LARSEN, EMIL 13C 27, LARSEN, G 12 24, LARSEN, HELEN 1 9, LARSEN, J 12 24, LARSEN, JAMES R 22 27, LARSEN, JOEL 22B 27, LARSEN, JOEL L 29D 20, LARSEN, JSZ 12A 24, LARSEN, KEN 1 9, LARSEN, MARGARET A 21 27, LARSEN, MARGT 29C 27, LARSEN, PATRICIA J 29B 17, LARSEN, RICHARD P 21 27, LARSEN, RICHARD P 21 27, LARSEN, RICHARD P 29A 27, LARSEN, RICHARD P 29C 27, LARSEN, VALERIA 13A 27, LARSON, BARB 27D 13, LARSON, C 9 21, LARSON, DEBRA 27C 20, LARSON, EARL 25C 11, LARSON, ELAINE 22A 13, LARSON, ELIZ 26A 26, LARSON, ERWIN 26A 26, LARSON, EUGENE C 10D 21, LARSON, FRANCES 7B 30, LARSON, HOWARD R JR 36A 28, LARSON, JAS 7B 30, LARSON, JOHN W II 27D 13, LARSON, KAREN 13D 27, LARSON, LEONARD W 18 28, LARSON, MARION 36B 28, LARSON, MARY 10D 21, LARSON, MARY 25C 11, LARSON, RONALD A 27C 20, LARSON, ROSE 5A 26, LARSON, WAYNE 22A 13, LARSON, WILLIAM D 30A 19, LARUE, DUANE I 3C 20, LARUE, SHIR 3C 20, LASCALLE, HAROLD J 23B 17, LASHUA, DEBRA 3B 25, LASHUA, JEROME F 3B 25, LASHUA, WALTER 3B 25, LASKA, DENNIS 13B 21, LASLEYS PT PLAT 9 23, LAST, ALFRED G 12 18, LAST, BRIAN 19 13, LAST, DEBBIE 15A 23, LAST, JOHN 15A 23, LAST, JOYCE 29D 20, LAST, MARY 17C 15, LAST, NEIL W 29D 20, LAST, RAY 19C 24, LAST, RAY 30B 20, LAST, SANDRA 18A 19, LAST, STEVEN W 18A 19, LAST, SUSAN 8C 13, LATIMER, CHARLES S 13D 23, LAUDON, THOMAS S 1A 15, LAUER, HARRIET G 16A 23, LAUS, DONNA 7B 13, LAUS, ROBT 7B 13, LAUSON, JAMES G 9D 25, LAUTENSCHLAGER, ALLEN R 18A 19, LAUTENSCHLAGER, CAROL 20D 19, LAUTENSCHLAGER, J M 17A 19, LAUTENSCHLAGER, LARRY 20D 19, LAUX, DONALD R 36A 26, LAUX, EMILY 12D 30, LAUX, JACK 31C 26, LAUX, JEAN 28B 25, LAUX, MARJ 31C 26, LAUX, RANDOLPH J 12D 30, LAUX, STEVEN 31C 26

Table with columns: Name, Sec.-Pg. Includes entries like LAW & BYE 9 25, LAWN AVENUE INVESTMENTS 11C 21, LAWRENCE, GEORGE T 20A 15, LAWRENCE, MELINDA 20A 15, LAZOWSKI, MICHAEL 21C 15, LEA, JOAN 20D 25, LEA, JOHN C 20D 25, LEACH, E C JR 30 20, LEACH, E C JR 30 21, LEACH, E C JR 32B 20, LEACH, JANET 30B 20, LEACH, STANLEY C 30B 20, LEADER, GRACE G 22C 21, LEADER, LAWRENCE G 22 21, LEADER, LAWRENCE G 27 21, LEADER, LAWRENCE G 28 21, LEADER, VERONICA E 27 21, LEADER, VERONICA E 28 21, LEAMAN, LELAND L 9C 19, LECALSEY, LOUIS 23C 28, LECALSEY, SUSAN 23C 28, LEDIOYT, GORDON 1D 15, LEDIOYT, MICH 8A 9, LEDIOYT, WAYNE G 7C 15, LEDIOYT, WENDY 8A 9, LEE, A 8 17, LEE, BERNICE 8 9, LEE, COLIN L 8C 19, LEE, DON 20 21, LEE, E 5 17, LEE, ELDON 20C 25, LEE, ELIZABETH H 9D 23, LEE, ELIZABETH M 24B 28, LEE, FRANCIS G 21 21, LEE, FRANCIS G 21 21, LEE, GARY E 30A 21, LEE, GERALD 17 21, LEE, GLADYS 17 21, LEE, GORDON 8 9, LEE, GORDON 8 9, LEE, J 7 25, LEE, J 19 21, LEE, JAMES 15 28, LEE, JAMES W 22A 21, LEE, JAMES W 23B 21, LEE, JANICE 21 21, LEE, JUNE 28C 21, LEE, JUNE I 21C 21, LEE, L 6C 27, LEE, LELAND 30 21, LEE, LOUISE 21C 21, LEE, LOWELL 29 21, LEE, LOWELL 15B 21, LEE, LOWELL 29B 21, LEE, M 5 17, LEE, MARJ 28A 11, LEE, MARV 28A 11, LEE, MARY 11A 17, LEE, MARY 20C 25, LEE, MICH 11A 17, LEE, N 19 21, LEE, NORMAN J 19 21, LEE, O 8 17, LEE, RAYMOND 17D 21, LEE, RICHARD A 29B 21, LEE, ROBERT E 11A 17, LEE, ROBERT E 21C 21, LEE, ROLAND M 19 21, LEE, ROLAND M 20 21, LEE, SUSAN 30A 21, LEE, THOMAS R 35 21, LEGOIS, DARLENE 24B 27, LEGOIS, JAS 24B 27, LEHER, KEN 25C 26, LEHER, WARREN 25C 26, LEHL, BEV 30 20, LEHL, ERNESWT 30 20, LEHL, JOHN 8 30, LEHL, JOHN 8 30, LEHL, JOHN SUB 8 30, LEHL, RITA 8C 30, LEHMAN, REBECCA 16A 30, LEHMAN, W DUDLEY 16A 30, LEHMANN, DONALD W 33C 20, LEHMANN, ELIZ 33C 20, LEHNDORF, ARTHUR 19C 25, LEHRER & RATHSACK 19 25, LEHRER REALTY 12D 30, LEHRER, AGNES 12D 30, LEHRER, DENNIS 19A 25, LEHRER, EUNICE 16B 21, LEHRER, KATH 29D 25, LEHRER, MARTHA 5A 30, LEHRER, ROBERT J JR 17C 30, LEHRER, ROBT 5A 30, LEHRER, RORY 5B 27, LEHRER, WALTER 12D 30, LEIBOLD, ROBERT ASSOC 16C 30, LEICHTFUSS, DAVID T 34 13, LEICHTFUSS, DIANE 10 13, LEICHTFUSS, DIANE 7C 13, LEICHTFUSS, GEORGE 10 13, LEICHTFUSS, GEORGE R 7C 13, LEICHTFUSS, HARRY 33 13, LEICHTFUSS, HENRY 35 13, LEICHTFUSS, JEFFREY 27D 13, LEICHTFUSS, JULIE 27D 13, LEICHTFUSS, L 16 21, LEICHTFUSS, LYNN 16 21, LEICHTFUSS, LYNN 21 21, LEICHTFUSS, MARVIN C 34 13, LEICHTFUSS, OSCAR 36D 15, LEICHTFUSS, RICKY D 22A 13

Table with columns: Name, Sec.-Pg. Includes entries like LEICHTFUSS, RON 1B 15, LEICHTFUSS, RON 16C 19, LEICHTFUSS, RON 21D 19, LEICHTFUSS, T 16 21, LEICHTFUSS, TERRELL 16 21, LEICHTFUSS, TERRELL 21 21, LEINWEBER, ALVIN 14A 13, LEINWEBER, BYRON D 2A 20, LEINWEBER, CAROL 2A 20, LEINWEBER, RICHARD J 19C 19, LEINWEBER, THERESA 3D 20, LEINWEBER, WM 3D 20, LEISEN, AGNES 4 26, LEISEN, MARY 16A 30, LEISEN, MARY 16D 30, LEISEN, MARY 4 26, LEITL, P 13 15, LEITL, THOS 13A 15, LEITZ, RUSSEL E 25C 20, LEITZ, RUTH 25C 20, LEMAY, JOS JR 28A 20, LEMBCKE, ALLEN 11A 30, LEMBCKE, GLORIA 11A 30, LEMBERGER, JOHN J 14 17, LEMBERGER, KENNETH G 17A 19, LEMKE, CLIFFORD 18 27, LEMIEUX, CHAS JR 20C 25, LEMIEUX, SHIR 20C 25, LEMKE, ALBERTA 25C 26, LEMKE, CATH 32C 28, LEMKE, DANIEL L 23A 27, LEMKE, DEB 23A 27, LEMKE, ED W ETAL 33 9, LEMKE, KATHIE 15B 28, LEMKE, LEONARD F 23B 27, LEMKE, LEONARD F 36A 26, LEMKE, NANCY 30 17, LEMKE, ROBERT 15B 28, LEMKE, STEPHANIE 17A 25, LEMKE, THOMAS J 17A 25, LEMKE, TIMOTHY 32C 28, LEMKE, VERLYN A 30 17, LENZ, ARNOLD 7C 26, LENZ, B 23 18, LENZ, BARB 14C 18, LENZ, CHAS 4B 11, LENZ, DAVID 7C 26, LENZ, DENNIS 16B 21, LENZ, DORIS 17 28, LENZ, DORIS 24B 27, LENZ, EMIL H 24B 27, LENZ, GERALD E 21C 21, LENZ, JAMES G 27C 26, LENZ, JAMES G 30D 26, LENZ, JOHN E 4 11, LENZ, JOHN E 5 11, LENZ, JOHN E 33 18, LENZ, JUD 28A 20, LENZ, MARGT 25D 28, LENZ, MARK 28A 20, LENZ, MARLENE 20D 18, LENZ, MINDY 28D 20, LENZ, NORM 25D 28, LENZ, PAMELA 24B 27, LENZ, RICHARD 15 18, LENZ, RUSSELL D 17 28, LENZ, S 23 18, LENZ, SHARON 16B 21, LENZ, STEVEN D 14C 18, LENZ, THOS 24B 27, LEON, CARLOS 9C 30, LEON, NANCY 9C 30, LEONARD, ANN 24 27, LEONARD, DAVID 24 27, LEONARD'S POINT PLAT 8 19, LEOPOLD, TIM R 11A 30, LEPIANKA, MARY 9C 18, LEPSCH, WILLIAM F 7B 30, LERCH, GARY R 16C 19, LERCH, MARGT 16C 19, LERCH, WARREN R 16C 19, LEROY, JOSEPH H 12B 18, LEROY, JOSEPH H ETAL 25B 9, LEROY, SHIR 12B 18, LESINSKI, IRENE 21B 30, LESKE, LEONA 29 27, LESNICK, JAS 5A 11, LESNICK, MARIE 5A 11, LESNICK, PAMELA 30A 19, LESNICK, TIMOTHY 30A 19, LESNIEWSKI, ARLENE 28C 26, LESNIEWSKI, RICHARD 28C 26, LETOURNEAU, MAURICE 7B 19, LETOURNEAU, NORRINE 7B 19, LETT, BEV 9C 18, LETT, CAROL A 19A 15, LETT, HARRY JAY JR 29A 20, LETT, NELL 20D 19, LETT, RAY W 20D 19, LETT, THOMAS J 9C 18, LETTAU, KAY 21A 28, LETTAU, THOMAS J 21A 28, LETTELLIER, MARC 5 28, LEUTHOLD, JAS 7D 15, LEUTHOLD, RACHELLE 7D 15, LEVENHAGEN, DOUGLAS 25A 15, LEVENHAGEN, OSCAR 6C 15, LEVENHAGEN, WM 25D 15, LEWELLYN, AUDREY 12D 9, LEWELLYN, BERNADINE 33B 20, LEWELLYN, FLOYD 13 9, LEWELLYN, FLOYD 12D 9, LEWELLYN, FLOYD 13A 9, LEWELLYN, LYNN 25A 17

Table with columns: Name, Sec.-Pg. Includes entries like LEWELLYN, MONONA 15A 17, LEWELLYN, RALPH 25A 17, LEWELLYN, ROGER 33B 20, LEWELLYN, ROGER J 25B 20, LEWIS, ARMAAND W 20C 18, LEWIS, CHRIS 20C 18, LEWIS, DON 20C 18, LEWIS, ELLEN 16C 19, LEWIS, EVERETT O 28C 17, LEWIS, GORDON D 3C 17, LEWIS, MARION J 20 17, LEWIS, ROBERT E 20 17, LEWIS, ROCCO L 29A 17, LEWIS, S 20 17, LEWIS, THERESA 20C 18, LEWIS, W 16 17, LEWIS, W 20 17, LEWIS, WILBUR E 21 17, LEWIS, WM 18C 19, LIBERTY PRAIRIE CEM 20C 11, LICHTENBERG, VERNON E 1B 9, LICHTERMAN, ANTHONY J 9A 20, LICHTFUSS, LINDA 18A 13, LICHTFUSS, RICHARD 18A 13, LICHTWALD, RICH 5D 13, LIEBER, ROBT 9A 25, LIEBER, ROBT 9B 25, LIEBERGEN, HAL 10C 21, LIEBERGEN, STELLA 10C 21, LIEDS NURSERY CO 13C 28, LIEDTKE, IRENE 16B 26, LIEDTKE, KARLEEN 17 26, LIEDTKE, WILLARD 17 26, LIENHARD, ADELINE 36B 20, LIENHARD, HAL 36B 20, LIERMANN, CARL 27 27, LIERMANN, MYRTLE 27 27, LIESKE, BEA 2B 15, LIESKE, JAMES 32B 11, LIESKE, LYNETTE 32B 11, LIN, SUN SAN 8C 30, LIN, YA CHANG 8C 30, LINCOLN, BARB 21C 15, LINCOLN, JANE 30A 20, LINCOLN, JOHN J 30D 25, LINCOLN, JUD 30D 25, LINCOLN, ROBT SR 30A 20, LINCOLN, RUSSELL A 21C 15, LIND, ERLIN C 2A 28, LIND, PAMELA 5D 17, LIND, ROGER 33D 15, LIND, ZEL 5D 17, LINDBERG, HUGO E 4A 30, LINDBERG, PAT 4A 30, LINDE, LOIS 33A 15, LINDE, WAYNE M 33A 15, LINDNER, DORIS 33D 15, LINDNER, MARVIN A 33D 15, LINDO, STEPHAN ETAL 24 9, LINSTEDT, IRENE 8 27, LINSTEDT, IRENE 9B 27, LINSTEDT, JAS ETAL 18D 27, LINSTEDT, ROBERT F 8 27, LINSTEDT, ROBERT F 9B 27, LINZMEYER, ARMAND J 31C 25, LINZMEYER, NANCY 31C 25, LIONS CLUB OF VAN DYNE 31D 15, LIPKE, DIANE 28 21, LIPKE, JAMES 28 21, LIPPERT, MARGARET 8 18, LIPPERT, MARGT 9B 18, LIPSE, MICHAEL E 19A 25, LISAK, MARIAN A 25C 26, LISON, CHRIS 9B 30, LISON, PETER 9B 30, LITJENS, JOHN J 20D 18, LITJENS, TINA 20D 18, LITTLE BUTTE PLAT 16 30, LITTON, C 36 17, LITTON, CLARENCE D 25D 17, LITTON, JUD 25D 17, LITTON, M 36 17, LITVINAS, LISELOTTE 21B 21, LITVINAS, PRANAS 21B 21, LIVINGSTORE, MARTIN R 19 23, LLOYD, DONALD T 34 20, LLOYD, DOUGLAS 25A 11, LLOYD, ELLEN 24 11, LLOYD, JANICE 7C 15, LLOYD, KATH 25A 11, LLOYD, KEN T 25 11, LLOYD, ROBT 7C 15, LLOYD, THOMAS 24 11, LLOYD, VERNA E 34 20, LOBERG, BRUCE 2D 28, LOBERG, CYNTHIA 2D 28, LOCHNER, ALBERT 8B 9, LOCKE, MARY C 19 18, LOCKE, TERRY 16C 30, LOEHKE, ELDOR A ETAL 13C 27, LOEHKE, ELDOR ETAL 13 27, LOEHKE, ELDOR ETAL 13D 27, LOEHKE, KEN 20B 28, LOEHKE, MICH ETAL 13 27, LOEHKE, ROBERT W 13D 27, LOESSEL, JOSEPH J 2B 28, LOESSEL, MARGT 2B 28, LOFTUS, BARBARA G 30B 20, LOKER, HARLEY F 36B 28, LOKER, JEFFREY 14B 23, LOKER, LAURA 36B 28, LOKER, LESLIE 31C 23, LOKER, PEARL K 16 17, LOKER, ROXANNE 23A 24, WDW



INDEX TO OWNERS

SMALL TRACT OWNERS ARE NOT SHOWN ON TOWNSHIP MAPS, HOWEVER THEY ARE KEYS BY QUARTER SECTIONS: NORTHEAST QUARTER BY A, NORTHWEST QUARTER BY B, SOUTHWEST QUARTER BY C, SOUTHEAST QUARTER BY D, THIS SHOWING GENERAL LOCATION

Table with columns: Name, Sec.-Pg., Name, Sec.-Pg., Name, Sec.-Pg., Name, Sec.-Pg. Lists owners and their corresponding section and page numbers.

INDEX TO OWNERS

SMALL TRACT OWNERS ARE NOT SHOWN ON TOWNSHIP MAPS, HOWEVER THEY ARE KEVED BY QUARTER SECTIONS. NORTHEAST QUARTER BY A, NORTHWEST QUARTER BY B, SOUTHWEST QUARTER BY C, SOUTHEAST QUARTER BY D, THIS SHOWING GENERAL LOCATION

Table with 5 columns: Name, Sec.-Pg., Name, Sec.-Pg., Name, Sec.-Pg. listing various owners and their corresponding section numbers.

INDEX TO OWNERS

SMALL TRACT OWNERS ARE NOT SHOWN ON TOWNSHIP MAPS, HOWEVER THEY ARE KEYED BY QUARTER SECTIONS: NORTHEAST QUARTER BY A, NORTHWEST QUARTER BY B, SOUTHWEST QUARTER BY C, SOUTHEAST QUARTER BY D, THIS SHOWING GENERAL LOCATION

Table with columns: Name, Sec.-Pg., Name, Sec.-Pg., Name, Sec.-Pg., Name, Sec.-Pg. Lists property owners and their corresponding section and page numbers.



INDEX TO OWNERS

SMALL TRACT OWNERS ARE NOT SHOWN ON TOWNSHIP MAPS, HOWEVER THEY ARE KEYED BY QUARTER SECTIONS: NORTHEAST QUARTER BY A, NORTHWEST QUARTER BY B, SOUTHWEST QUARTER BY C, SOUTHEAST QUARTER BY D, THIS SHOWING GENERAL LOCATION

Table with columns: Name, Sec.-Pg., Name, Sec.-Pg., Name, Sec.-Pg., Name, Sec.-Pg. Lists owners and their corresponding section/page numbers across four quadrants.

INDEX TO OWNERS

SMALL TRACT OWNERS ARE NOT SHOWN ON TOWNSHIP MAPS, HOWEVER THEY ARE KEYED BY QUARTER SECTIONS: NORTHEAST QUARTER BY A, NORTHWEST QUARTER BY B, SOUTHWEST QUARTER BY C, SOUTHEAST QUARTER BY D, THIS SHOWING GENERAL LOCATION

Name	Sec.-Pg.	Name	Sec.-Pg.	Name	Sec.-Pg.	Name	Sec.-Pg.
RHYNER, LORI	7A 13	ROBERTS, KEITH L	21B 21	ROMBERG, ELMER	36 27	RUEDINGER, CATHERINE	10 13
RHYNER, NANCY	20C 19	ROBERTS, MARIE	25C 15	ROMBERG, FLORENCE	12 23	RUEDINGER, CECELIA	23 13
RHYNER, PAUL J	20C 19	ROBERTS, ROANE	30C 13	ROMBERG, L	36 27	RUEDINGER, CECILIA	18A 15
RHYNER, THOMAS R	28D 20	ROBERTS, THOMAS L	20A 17	ROMBERG, L	36 27	RUEDINGER, DAVID	6D 13
RIBAR PROPERTIES II	16A 21	ROBERTS, THOS	25C 15	ROMBERG, LESLIE	2 23	RUEDINGER, DAWN	11D 13
RICE, DALE D ETAL	7 19	ROBICHAUD, RAYMOND F	10A 9	ROMBERG, LESLIE W	26 27	RUEDINGER, ELLEN	8 13
RICH, NORBERT L	31 23	ROBINETTE, BARB	35B 27	ROMBERG, MARY	36 27	RUEDINGER, GORDON	20 18
RICH, NORBERT L	11C 21	ROBINETTE, REGINALD	35B 27	ROMBERG, WAYNE	17C 30	RUEDINGER, JANET	10C 13
RICHTER, ALLEN D	17A 19	ROBINSON, CINDY	28D 15	ROMENESKO, EUGENE J	32B 26	RUEDINGER, KATH	6D 13
RICHTER, DENNIS J	30B 9	ROBINSON, DARLENE	29A 28	ROMENESKO, JANE	32B 26	RUEDINGER, KENNETH	36 17
RICHTER, DUANE F	31B 15	ROBINSON, EYVONNE	10B 28	ROMENESKO, CHRIS	7C 15	RUEDINGER, MARK	23 13
RICHTER, KAROL	17A 19	ROBINSON, HUBERT	32B 11	ROMLOW, WILLIAM M	7C 15	RUEDINGER, MARK L	18A 15
RICHTER, THERESA	31B 15	ROBINSON, JOY	28D 15	ROMME, BERNICE	27C 20	RUEDINGER, PATK	10C 13
RICHTER'S PLAT	36 26	ROBINSON, MARGT	32B 11	ROMME, DEB	16B 13	RUEDINGER, PHILL	5C 13
RICK, DONALD R	5D 30	ROBINSON, R	13 28	ROMME, JAMES R	16B 13	RUEDINGER, PHILL	6D 13
RICK, GERALD SR	14B 11	ROBINSON, ROBT	10B 28	ROMME, JEAN	22D 24	RUEDINGER, PHILLIP	10 13
RICK, PEGGIE	5D 30	ROBINSON, S	13 28	ROMME, MARK L	5B 30	RUEDINGER, PHILLIP R	6C 15
RICKERS BAY PLAT	9 25	ROBINSON, WILLIAM R	29A 28	ROOT, ROBIN	5B 30	RUEDINGER, RAY J	7 13
RIDER, CRAIG A	34C 27	ROBL, WM	29D 11	ROOT, RUTH E	7D 15	RUEDINGER, RAYMOND J	17 13
RIDER, DONNA	34C 27	ROBLEE, A	15 28	ROPPER, RUTH E	18A 15	RUEDINGER, RICHARD C	19D 24
RIDGEVIEW ESTATES	13 28	ROBLEE, FRANK J JR	15A 28	ROPPER, RUTH E	18A 15	RUEDINGER, ROBERT A	31 15
RIDGEWAY COUNTRY CLUB	23 28	ROBLEE, N	15 28	RORRER, HOW	19 13	RUEDINGER, THOMAS O	19D 24
RIDGEWAY HTS SUB	23 28	ROCHON, MARY	9D 25	RORRER, JOYCE	19 13	RUEDINGER, VICTOR ETAL	10 13
RIEBE, LEONARD	3 27	ROCHON, PATK	9D 25	ROSE, ANNE	29D 28	RUEDLINGER, ALOYS O	9 13
RIEBE, LEONARD	3B 27	ROCKWELL, ANNE ETAL	1A 15	ROSE, BONNIE	10 30	RUEGER, CAROLE	21B 11
RIECHENBERGER, M T ETAL	15A 13	ROCOLE, KERRY	28D 20	ROSE, E	36 20	RUEGER, TIMOTHY	21B 11
RIECHENBERGER, MICH	18D 15	ROCOLE, PATK	28D 20	ROSE, RICHARD B	10 30	RUESCH, LARRY C	9D 30
RIECKMANN, ORWIN	5 27	RODENCAL, ALBERT M	20A 26	ROSENDALE STATE BANK	29D 11	RUETTEN, ALTA M	18 15
RIECKMAN, BONNIE	12 26	RODENCAL, GORDON	9 26	ROSENOW, DONNA	2C 28	RUETTEN, JOHN	28C 15
RIECKMAN, DANIEL	12 26	RODENCAL, SONYA	20A 26	ROSENOW, GEORGE M JR	8A 30	RUETTEN, JOHN	28C 15
RIECKMAN, EVELYN	2B 28	RODENCALO, GORDON	20 26	ROSENOW, RICHARD C	2C 28	RUH, ROBERT R	13C 15
RIECKMAN, NATALIE	16 26	RODENSAL, WILLIAM C	8B 9	ROSENTHAL, ERWIN	36D 28	RUHL, GEORGE E	18D 30
RIECKMAN, ROBT	6D 13	RODERICK, BENNIE JR	29D 20	ROSENTHAL, WILOMER R	11 24	RUHL, GERMAINE	18D 30
RIECKMAN, ROBT J	6 13	RODERICK, KARLA	29D 20	ROSPLOCHOWSKI, SONYA H	16B 21	RUMLOW, DONALD R	20D 19
RIECKMAN, VERNON E	2B 28	RODGERS, JAS	2C 27	ROSPLOCHOWSKI, JOS	16A 21	RUMLOW, TYRONE	34B 27
RIECKMAN, WILLARD L	1B 26	RODGERS, JAS	23C 28	ROSPOCHOWSKI, SONYA	16A 21	RUNG, WALTER	25 17
RIECKMANN, BONNIE	10 26	RODGERS, KARL	23C 28	ROSS, ANNE	7D 24	RUNKLE, PAT	28D 17
RIECKMANN, DANIEL	10 26	ROE, FLOYD H	7B 15	ROSS, BRENDA	29D 26	RUNKLE, WILLIAM P	28D 17
RIECKMANN, DAWN	5C 27	ROE, MARY	36C 19	ROSS, BRYAN S	3A 25	RUNKLE, ETHAN E	30B 20
RIECKMANN, E	6 28	ROE, MARY	36C 19	ROSS, CAROL	25B 20	RUPERT, GARY	30B 20
RIECKMANN, E	20 28	ROE, ROBT F	7B 15	ROSS, EDWARD	16C 30	RUPERT, PAULA	32 15
RIECKMANN, EMERSON P	17 28	ROE, ROBT	36C 19	ROSS, EDWARD A	29D 25	RUPNOW & WALTER	25 20
RIECKMANN, ERVIN C	21 28	ROE, ROBT	36D 19	ROSS, HARVE C	14 18	RUPPEL, RAY	26C 18
RIECKMANN, IRENE	6A 27	ROEBKE, DENNIS L	28D 15	ROSS, JOHN L	25B 20	RUSCH & GABERT	2 18
RIECKMANN, LOIS	11D 26	ROEBKE, LYLE	28D 15	ROSS, JUNE	12B 24	RUSCH & GABERT	15 18
RIECKMANN, M	18 26	ROEBKE, M	13 15	ROSS, KEN R	12B 24	RUSCH & GABERT	30 19
RIECKMANN, NATALIE	16 26	ROEBKE, T	13 15	ROSS, LELAND S	7D 24	RUSCH & STANICEK	29 19
RIECKMANN, R	18 26	ROEDER, JANICE	19 18	ROSS, PAUL	29D 26	RUSCH, JUDY	9C 19
RIECKMANN, RON	18 26	ROEDER, WILLIAM H	19 18	ROSS, RENE M	14 18	RUSCH, T ETAL	13 15
RIECKMANN, WAYNE O	22B 28	ROEHRRICK, JOS	9D 23	ROSS, RICHARD L	7A 13	RUSCH, THOMAS ETAL	32 19
RIECKMANN, WILLARD L	16 26	ROEHRRICK, JOS	22B 23	ROST, PAULA-RAE	19C 19	RUSCH, THOMAS N	4 13
RIECKMANN, WILLER L	11D 26	ROEHRRICK, RICH	22B 23	ROTHE, JOYCE	1A 30	RUSCH, THOMAS N	12 17
RIEL, BEN	16A 19	ROEMER, MICH	6C 15	ROTHE, PATRICE	9 24	RUSCH, THOMAS N	35 20
RIEMER, NANCY	8A 26	ROEMER, VICTORIA	6C 15	ROTHE, RICH	20C 25	RUSCH, THOMAS N	16C 19
RIEMER, RON	8A 26	ROEMING, CHARLENE	29B 11	ROTHE, ROBT	1A 30	RUSCH, THOMAS N ETAL	4 13
RIES, JANE	12D 15	ROEMING, ROY	29B 11	ROTHE, TOM	9 24	RUSCH, THOMAS N ETAL	11 28
RIES, ROBT	12D 15	ROESKE, BERNICE	32B 11	ROTHENBACH, PAT	18 17	RUSCH, THOS	9C 19
RIESE, DALE	23A 27	ROESKE, CHESTER	29 11	ROTHENBACH, ROBT H	18A 19	RUSCH, THOS	23B 17
RIESE, NONA M	23A 27	ROESKE, E B	32B 11	ROTHENBACH, RON	18 17	RUSH LAKE COTTAGE CORP	22D 9
RILEY, ROSE J	29 17	ROESKE, PAT	29 11	ROTHENBACH, SANDRA	18A 19	RUSH LAKE SPORTSMENS CL	27 9
RILLING, J	18 18	ROESLER, FRANKLIN C	2D 27	ROUSE, LINDA J	20D 19	RUSH LAKE VIEW FARM	16 9
RILLING, JANICE	14 21	ROGERS, BETTY	19B 17	ROWE, ANNA	15D 23	RUSH-FOSTER INC	13 9
RILLING, JOHN	14 21	ROGERS, DON	25C 26	ROWE, CHERYL	2C 30	RUSHFORD CEM ASS'N	10C 17
RILLING, MARGARET	29 18	ROGERS, FRANK	26A 26	ROWE, DONALD R	15D 23	RUSKEY, GAYLE	21C 15
RILLING, ROBERT R	35 17	ROGERS, FRANK J	11D 26	ROWE, HARLOWE	29A 20	RUTH, REBECCA	1A 20
RILLING, RUSSELL	29 18	ROGERS, GERALD	4 17	ROY, VICKY	7D 20	RUTH, THOS	20A 24
RILLING, RUSSELL G	29A 18	ROGERS, GERALD	8 17	ROYCRAFT, B	7 17	RUTHEN, WILLIAM L	1A 20
RIMBEY, KATHLEEN	17D 19	ROGERS, GERALD D	3 17	ROYCRAFT, J	9 17	RUTHEN, LUC	34D 25
RIMBEY, RONNIE	17D 19	ROGERS, GLENN A	30A 25	ROYCRAFT, JOS	10 17	RUTHVEN, RICHARD L	34D 25
RIAMSEY, KATHLEEN	19D 19	ROGERS, JAS	36A 26	ROYCRAFT, LUCILLE	23B 17	RUTKAUSKAS, JAS	28C 26
RING, DONALD D	36A 15	ROGERS, JUDITH	4 17	ROYCRAFT, WILLIAM R	9 17	RUTTEN, BERNARD J	36A 26
RING, DOR	4D 30	ROGERS, JUDITH	8 17	ROYCRAFT, WILLIAM R JR	7 17	RUTTEN, CHRISTIAN G	36A 26
RING, MARILYN	36A 15	ROGERS, KAY	11D 26	ROYSTON, MAXINE R	34B 20	RUTTEN, GLADYS	36D 26
RING, STEVEN J	4A 30	ROGERS, KENNETH	19B 17	ROZEK, BARB	1C 23	RYAN, BERNADETTE	9A 25
RING, SUE	4A 30	ROGERS, LAVERNE L	35D 28	ROZEK, C	17 23	RYAN, DAVID	9A 25
RING, WESLEY R	4D 30	ROGERS, LUTHER	23C 28	ROZEK, DAVID A	1C 23	RYAN, MARGT	3C 30
RIPKE, NORMA	17D 23	ROGERS, MICH	15A 27	ROZELLE, HARRY	17 23	RYDALL, EDW	16D 30
RIPLEY, ALAN G	10B 18	ROGERS, RICH	25C 26	RUBBERT, ARN	19D 28	RYDALL, EDWARD A	16A 30
RIPP, ELAINE	29A 25	ROGERS, ROBERTA C	3 20	RUBBERT, CARL	10 28	RYF OIL CO	20D 23
RIPP, HERM	29A 25	ROGERS, SUSAN	15A 27	RUBBERT, CARL W	17 28	RYF, DOR	33D 20
RISTAU, ALVIN J	17 26	ROGERS, THOMAS N	36D 28	RUBBERT, CARL W	24B 27	RYF, JOHN A	33D 20
RISTAU, ALVIN J	18 26	ROGERS, VERNON	10B 20	RUBBERT, DELORES A	20 28	RYF, KAREN	12D 15
RISTAU, JOAN	6 25	ROGERS, VERNON TRUST	3C 20	RUBBERT, GARY	17 28	RYMER, CAROL	20C 15
RISTAU, JOHN	18 26	ROGERS, VERNON TRUST	10A 20	RUBBERT, GARY J	17 28	RYMER, DOR	30D 19
RISTAU, JOHN	18 26	ROGERS, WM	20B 25	RUBBERT, GARY J	21B 28	RYMER, JAMES C	18A 30
RISTAU, ROBERT SR	6 25	ROGGE, PHILIP D	18A 19	RUBBERT, GARY O	9 28	RYMER, LEE E	30D 19
RISTAU, SUZANNE	18 26	ROHAN, EUGENE E	10B 18	RUBBERT, MILDRED	17 28	RYMER, ROBT	33D 15
RISTOW, GERALD L	20D 19	ROHAN, JANNICE	10B 18	RUBEL, CLAR	18B 23	RYMER, SHARON	18A 30
RISTOW, KAREN	7C 13	ROHAN, PATRICK	10 18	RUBEL, DOR	18B 23	S	
RISTOW, ROBERT L	5D 18	ROHAN, PETER	24C 23	RUBY, JAMES G	34C 18	S SIDE BAPTIST CHURCH	5A 13
RISTOW, SCOTT	29D 21	ROHAN, ROBT T	10C 18	RUBY, LU ANN	34C 18	S W INDUSTRIES INC	16C 30
RISTOW, SHAWN	7C 13	ROHAN, VIRG	10 18	RUCCI, DOMENIC	6B 25	SABATKE, ORVILLE	31C 26
RISTOW, TIMOTHY	36C 11	ROHE, GEO	20C 25	RUCINSKI, VIRGINIA E	8C 19	SABEE, J MICHAEL	11 28
RISTOW, WILLIS E	30 19	ROHE, GEORGE H	17A 25	RUCK, ELMER H	9B 18	SABEE, MARION	11 28
RISTOW, WILLIS E	36 18	ROHE, MARLENE	17A 25	RUCK, ETHELYN A	12B 18	SABEF, REINHARDT	11B 23
RIVERMOOR SUB	35 23	ROHE, MARLENE	20C 25	RUCK, JAMES E	22A 13	SABEF, REINHARDT ETAL	2 23
RIVERS, ALOYSIOUS A	30A 19	ROLAND, DAVID R	15B 23	RUCK, THOMAS G	20D 19	SABEL, HAROLD A	28B 9
ROBARE, JOSE	14D 28	ROLAND, LOLEEE R	28C 26	RUDEBECK, DAN	26A 26	SABRE PROPERTIES	1C 30
ROBARE, KEN	14D 28	ROLAND, REINHOLD	15 23	RUDEBECK, KATHLEEN	26A 26	SACRED HEART CONG	34 19
ROBBERT, LYNN	12C 26	ROLFS, CLARENCE	20C 28	RUDMINAS, ALICIA	10D 30	SADER, DUANE	32B 26
ROBBERT, MARLYN	12C 26	ROLLING HTS	30 25	RUDMINAS, ANTHONY S	10D 30	SADLAK, MICH	7D 15
ROBE, DANIEL W	17A 19	ROLLMAN, GERALD A	8D 19	RUEBEIKEL, GUENTER	12D 28	SADOWSKI, JEAN	16B 21
ROBE, NANCY	17A 19	ROLLMAN, LYNNE	8D 19	RUEBEIKEL, JEAN	12D 28	SAFEMASTER, BONNIE	28C 26
ROBERTS, ADELINE	36B 17	ROLLMANN, GERALD A	17A 19	RUECHEL, MARK	7 11	SAFEMASTER, KENNETH	28C 26
ROBERTS, ALVIN G	13B 30	ROLLMANN, LYNNE	17A 19	RUEDINGER, ALOYS	8 13	SAFEMASTER, LENA	28C 26
ROBERTS, ANN	20A 17	ROMAIN & HOLTZMAN	16 19	RUEDINGER, ART	11D 13	SAFEMASTER, ROLAND L	28C 26
ROBERTS, ARLAND H	30C 13	ROMBERG, DAVID A	17C 30	RUEDINGER, AUDREY	36 17	SAFT, RONALD J	20D 19
ROBERTS, ARLENE M	16A 19	ROMBERG, E	1 23	RUEDINGER, CATH	5C 13		
ROBERTS, CHAS	17A 21	ROMBERG, ELAINE	26 27				
ROBERTS, DIANE	21B 21	ROMBERG, ELAINE	36 27				
ROBERTS, GEORGE L	31C 25	ROMBERG, ELAINE	2 23				
ROBERTS, JARRETT H	36B 15	ROMBERG, ELMER	6 24				
ROBERTS, JOYCE F	24B 17	ROMBERG, ELMER	6 24				



INDEX TO OWNERS

SMALL TRACT OWNERS ARE NOT SHOWN ON TOWNSHIP MAPS, HOWEVER THEY ARE KEYED BY QUARTER SECTIONS: NORTHEAST QUARTER BY A, NORTHWEST QUARTER BY B, SOUTHWEST QUARTER BY C, SOUTHEAST QUARTER BY D, THIS SHOWING GENERAL LOCATION

Table with 4 columns: Name, Sec.-Pg., Name, Sec.-Pg. containing a comprehensive list of property owners and their corresponding section and page numbers.

INDEX TO OWNERS

SMALL TRACT OWNERS ARE NOT SHOWN ON TOWNSHIP MAPS, HOWEVER THEY ARE KEYED BY QUARTER SECTIONS: NORTHEAST QUARTER BY A, NORTHWEST QUARTER BY B, SOUTHWEST QUARTER BY C, SOUTHEAST QUARTER BY D, THIS SHOWING GENERAL LOCATION

Table with 4 columns: Name, Sec.-Pg., Name, Sec.-Pg. listing property owners and their section/page numbers. Includes names like SEDO, MARK; SHEPHERD, WILLARD E; SPATT, DONNA; STADTMUELLER, JUD; etc.

INDEX TO OWNERS

SMALL TRACT OWNERS ARE NOT SHOWN ON TOWNSHIP MAPS, HOWEVER THEY ARE KEYED BY QUARTER SECTIONS: NORTHEAST QUARTER BY A, NORTHWEST QUARTER BY B, SOUTHWEST QUARTER BY C, SOUTHEAST QUARTER BY D, THIS SHOWING GENERAL LOCATION

Table with 5 columns: Name, Sec.-Pg., Name, Sec.-Pg., Name, Sec.-Pg. Lists property owners and their corresponding section and page numbers.

INDEX TO OWNERS

SMALL TRACT OWNERS ARE NOT SHOWN ON TOWNSHIP MAPS, HOWEVER THEY ARE KEYED BY QUARTER SECTIONS: NORTHEAST QUARTER BY A, NORTHWEST QUARTER BY B, SOUTHWEST QUARTER BY C, SOUTHEAST QUARTER BY D, THIS SHOWING GENERAL LOCATION

Table with columns: Name, Sec.-Pg., Name, Sec.-Pg., Name, Sec.-Pg., Name, Sec.-Pg. Lists owners and their corresponding section/page numbers across four quadrants.



INDEX TO OWNERS

SMALL TRACT OWNERS ARE NOT SHOWN ON TOWNSHIP MAPS, HOWEVER THEY ARE KEYED BY QUARTER SECTIONS: NORTHEAST QUARTER BY A, NORTHWEST QUARTER BY B, SOUTHWEST QUARTER BY C, SOUTHEAST QUARTER BY D, THIS SHOWING GENERAL LOCATION

Table with columns: Name, Sec.-Pg., Name, Sec.-Pg., Name, Sec.-Pg., Name, Sec.-Pg., Name, Sec.-Pg., Name, Sec.-Pg. Lists owners and their corresponding section numbers across various township maps.