

Nancy Nebl



**LAND ATLAS**  
& PLAT BOOK  
**1976**

Distributed By  
**WINNEBAGO COUNTY 4-H LEADERS ASSOCIATION**  
Oshkosh, Wisconsin 54901

WINNEBAGO COUNTY WISCONSIN

Published By  
**ROCKFORD MAP PUBLISHERS, Inc.**  
4525 Forest View Avenue, P.O. Box 6126  
Rockford, Illinois 61125

# INDEX

## WINNEBAGO COUNTY, WISCONSIN

COUNTY SEAT - OSHKOSH, WISCONSIN

### TABLE OF CONTENTS

BUSINESS DIRECTORY .....	3
COUNTY INDEX .....	1
FACTS ABOUT LAND DESCRIPTIONS .....	5,24
GENERAL HIGHWAY MAP .....	26,27
INDEX TO OWNERS .....	29

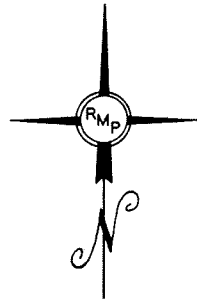

*Copyright 1969 - Revised 1976*  
**ROCKFORD MAP PUBLISHERS, Inc.**  
*See Page 3*

### LEGEND

CIVIL TWP. BORDER : : : : : CONG. TWP. BORDER - - - - -

### ALPHABETICAL INDEX TO TOWNSHIP MAPS

ALGOMA .....	13
BLACK WOLF .....	10
CLAYTON .....	22
MENASHA .....	23
NEENAH .....	18
NEKIMI .....	9
NEPEUSKUN .....	7
OMRO .....	11,12
OSHKOSH .....	14
POYGAN .....	15
RUSHFORD .....	7,8,11,12
UTICA .....	8
VINLAND .....	17,18
WINCHESTER .....	21
WINNECONNE .....	16
WOLF RIVER .....	19

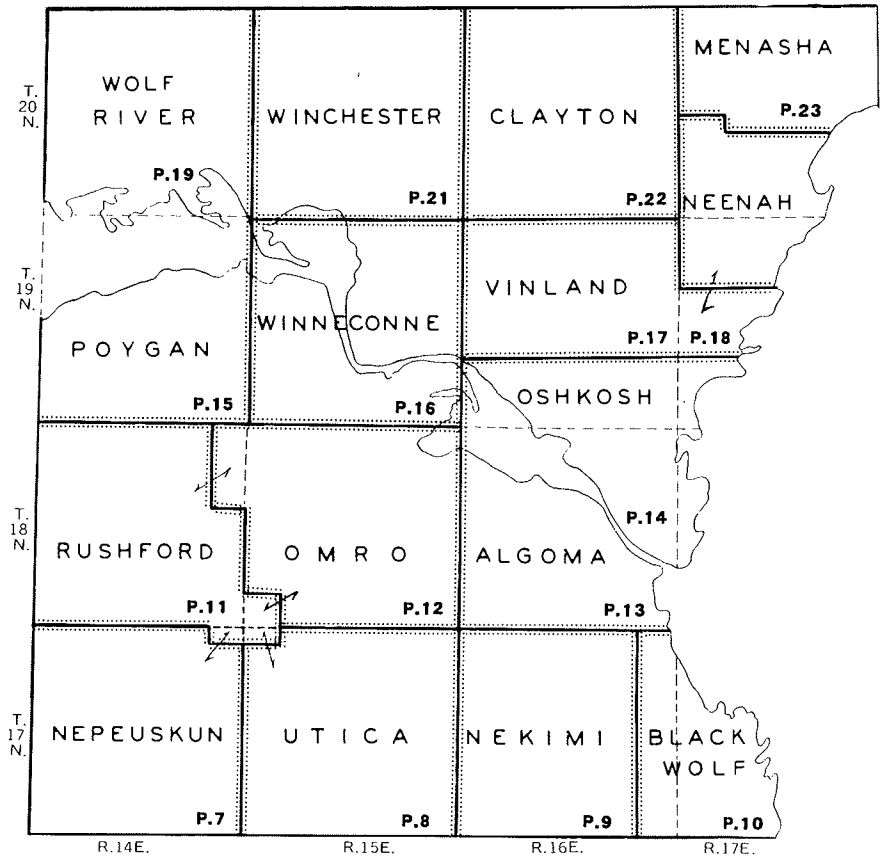

### LEGEND FOR TOWNSHIP MAPS

INTERSTATE EXPRESSWAYS.....		GROUP OF BUILDINGS.....	
FEDERAL HIGHWAYS.....		RURAL BUSINESS BUILDING.....	
STATE HIGHWAYS.....		SCHOOL.....	
STATE AID HIGHWAYS.....		CHURCH.....	
PORTLAND CEMENT or CONCRETE		CEMETERY.....	
BITUMINOUS ROADS.....		INCORPORATED CITY OR VILLAGE.....	
GRAVEL ROADS.....		CORPORATE LIMIT LINE.....	
OTHER ROADS.....		UNINCORPORATED VILLAGE.....	
TRAILS.....		SUBDIVISIONS & AREAS OF SMALL TRACTS.....	
RAILROADS.....		CIVIL TOWNSHIP BOUNDARY.....	
FARMSTEAD.....		DITCH.....	
FIRE TOWER.....		CANAL.....	
LAND CONTRACT BUYER..... (L.C.)		LEVEE.....	
HOOK MEANS SAME OWNER FOR BOTH PARCELS		SCALE: 1/4 INCH EQUALS ONE MILE	
		"ETUX" MEANS "AND WIFE"	
		"ETAL" MEANS "AND OTHERS"	

### GENERAL INFORMATION

**NOTICE:** This book is published as a guide to the Community. All data contained herein was gathered from the Official Public Records at the Court House and elsewhere. Due to continual sales and transfers of property it is impossible to guarantee 100% accuracy. We do however, guarantee the accuracy to be 95% or better as compared to the official county records.

The Index Map above shows the various townships in the county as they are located geographically. Numerals on each township indicate the page number that particular map will appear in detail.

Turn to the INDEX TO OWNERS in the back of the book. The Index to Owners shows alphabetically, every land owner in the county whose name appears on the township maps. To find a land owner, look up his name in the alphabetical index, which will show the section and page number of his land.

Name	Section	Page
ANTHONY, FLOYD.....	9	10

NEPEUSKUN SOUTHWEST PART RUSHFORD T. 17 N.-R. 14 E.

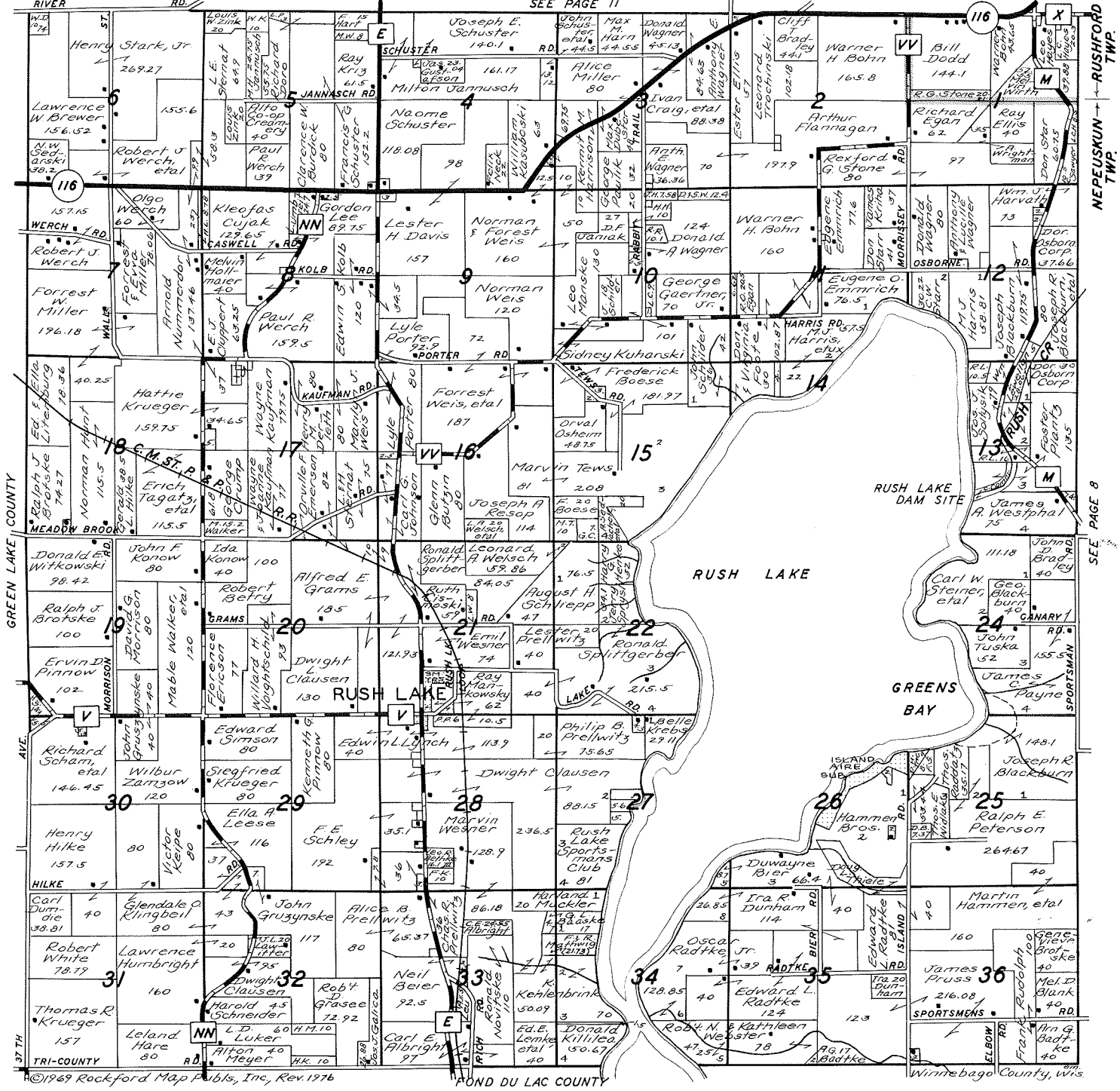

**FIRST NATIONAL BANK**



SINCE 1876

PHONE: 361-2400

BERLIN, WISCONSIN 54923



**REAL ESTATE** ALL ACTION AGENCY OFFICES  
Open Daily 9 A.M. to 5 P.M.  
Saturday till 2 P.M.

MAIN OFFICE:  
801 West Fond du Lac Street - Highway 23 West  
Next to Super Valu - Ripon, Wisconsin 54971  
Phone: 414 - 748-3000 or 3001 or 3002

BRANCH OFFICES:  
84 North Bridge Street - Markesan, Wisconsin  
Phone: 414 - 398-3003  
520 North Mill Street, Across from Courthouse  
Green Lake, Wisconsin - Phone: 414 - 294-6667

# UTICA SOUTHEAST PART RUSHFORD T. 17 N.-R. 15 E.

SEE PAGE 12

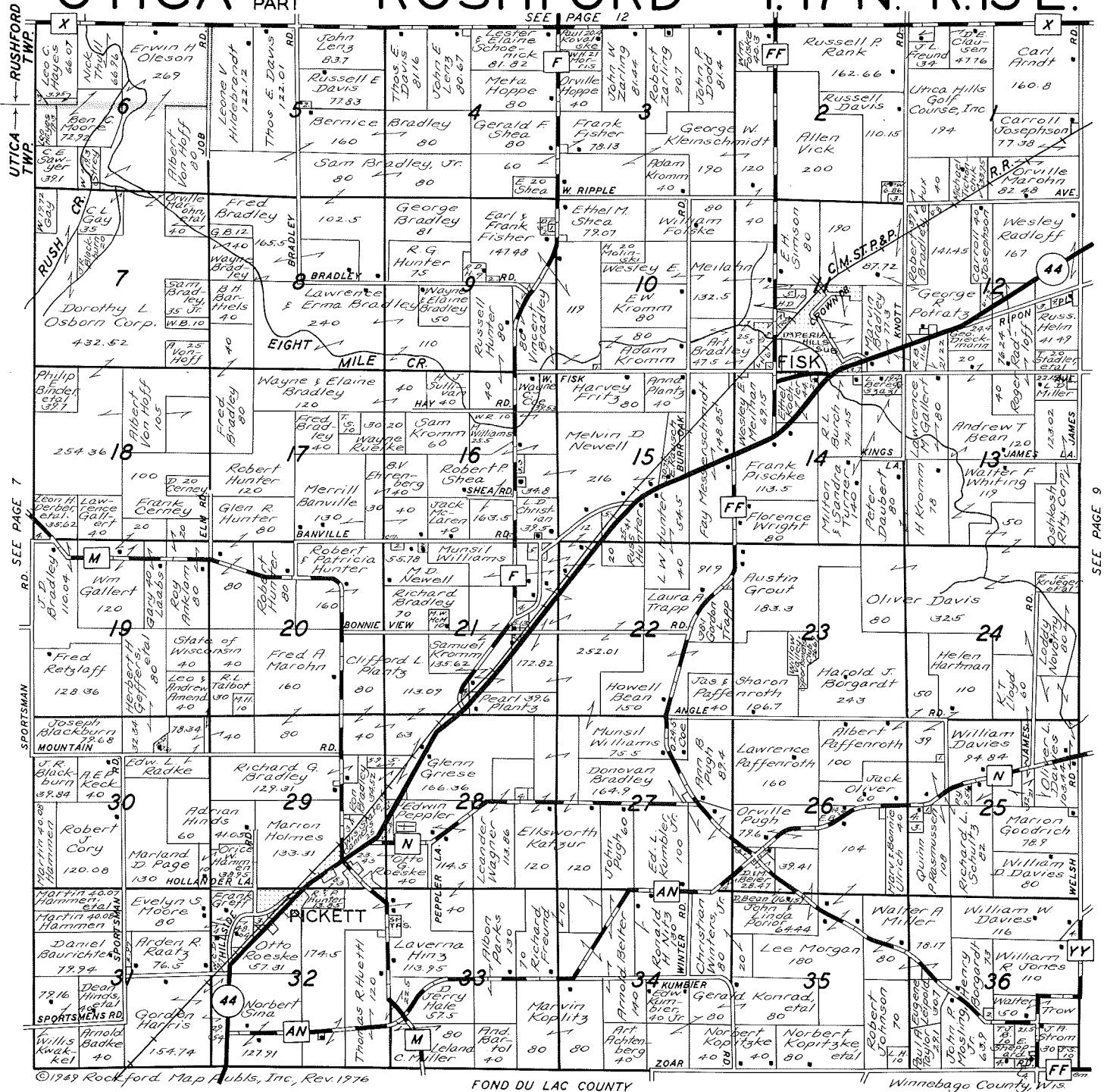

©1989 Rockford Map & Publs, Inc., Rev. 1976

FOND DU LAC COUNTY

Winnepago County, Wis.

## PICKETT COOPERATIVE



PETROLEUM PRODUCTS  
 FARM HARDWARE - APPLIANCES  
 FERTILIZER - LP GAS  
 SEED - FEED - COAL

**PHONE: 589-2311**  
 PICKETT, WISCONSIN

## WISCONSIN STATE CANNERS COMPANY

Packers Of  
 Fancy Wisconsin Peas And Corn

**PHONE: 589-2262 or 589-3511**  
 PICKETT, WISCONSIN

SEE PAGE 13

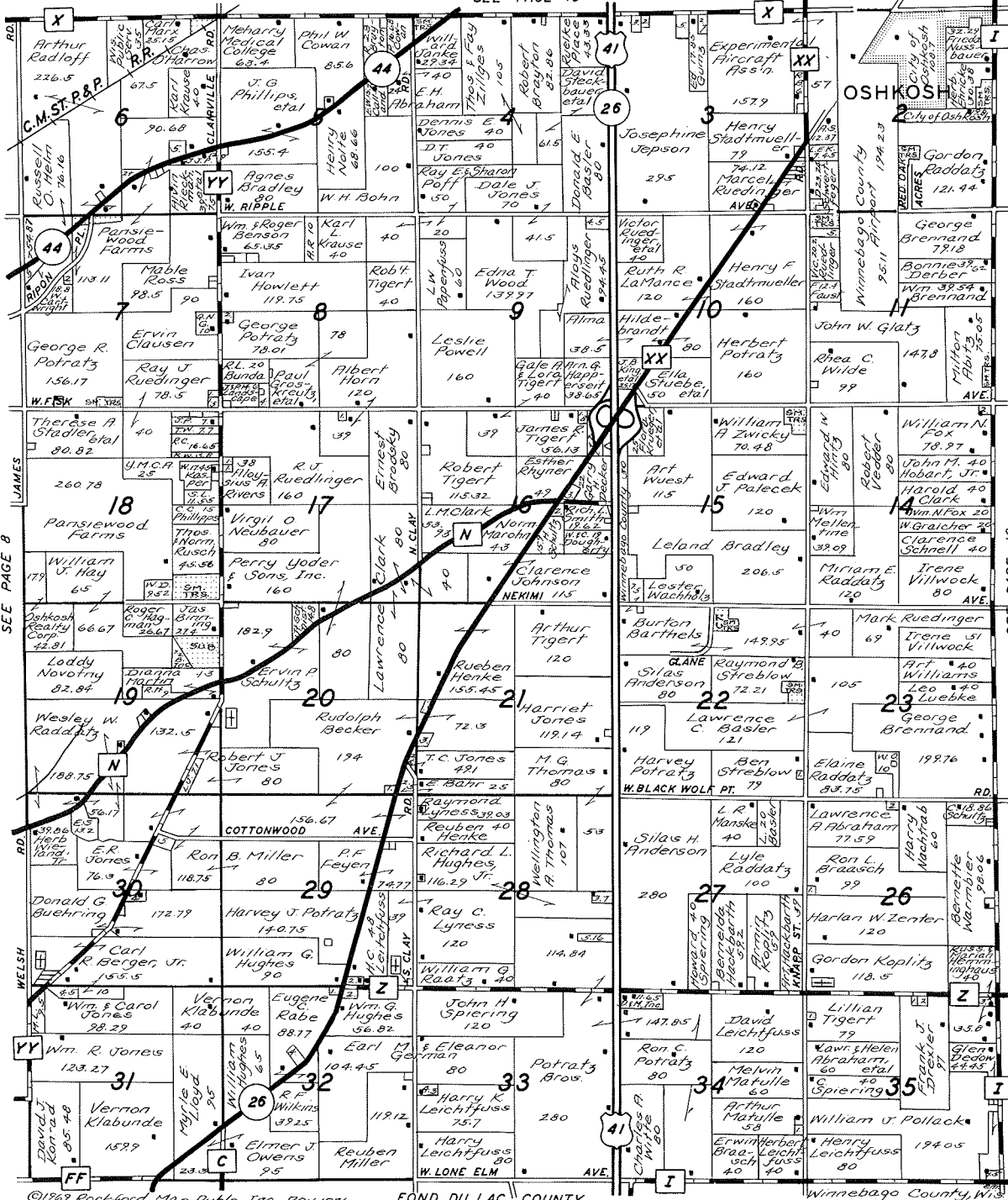

©1967 Rodford Map Pubs, Inc., Rev. 1976

FOND DU LAC COUNTY

Winnebago County, Wis.

# ROSENDALE MUTUAL INSURANCE COMPANY

FIRE - LIGHTNING - EXTENDED  
OR SUPPLEMENTAL COVERAGE

*Fond Du Lac - Dodge - Green Lake  
And Winnebago Counties*

PHONE: 872-2016 - P.O. Box 3  
ROSENDALE, WISCONSIN 54974



# WAYNE FEED SUPPLY

**DEALER IN**  
FEED - SEED - GRAIN - FERTILIZER  
CUSTOM GRINDING - MIXING  
PICKUP & DELIVERY

Processors of Tomorrows Feed Today

PHONE: ROSENDALE 872-2331  
ELDORADO, WISCONSIN

# BLACK WOLF

# T. 17 N.-R. 16-17 E.

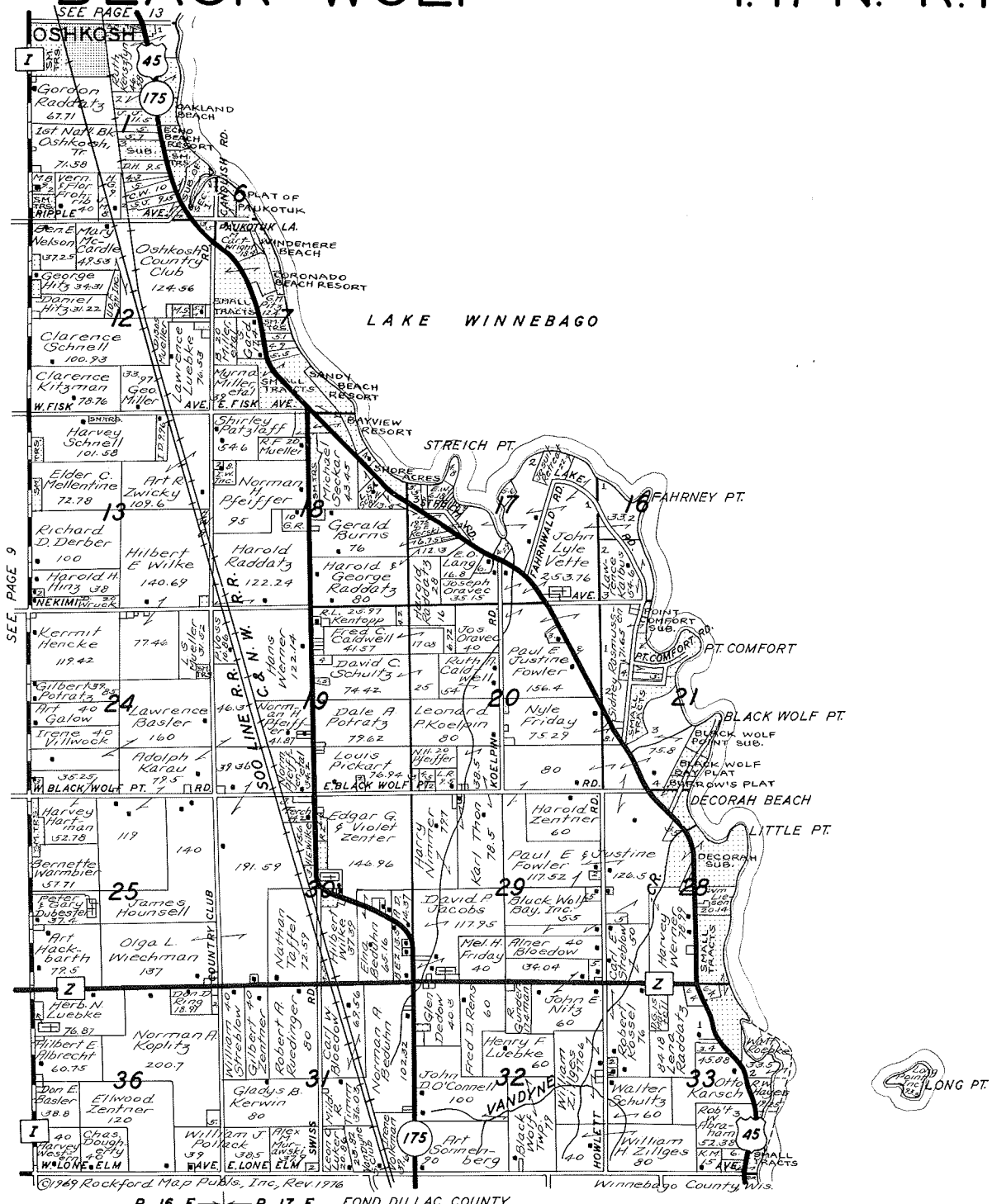

©1969 Rockford Map Publ's, Inc, Rev 1976  
 Winnebago County, Wis.  
 R. 16 E. ← R. 17 E. FOND DU LAC COUNTY

## MARQUARDT FUNERAL HOME



1025 OREGON STREET

Funeral Director

OSHKOSH WISCONSIN 54901



## Valley Bank

50 Pearl Avenue - 3180 Omro Road - Oshkosh, Wisconsin  
 MEMBER FDIC AND VALLEY BANCORPORATION



SEE PAGE 15

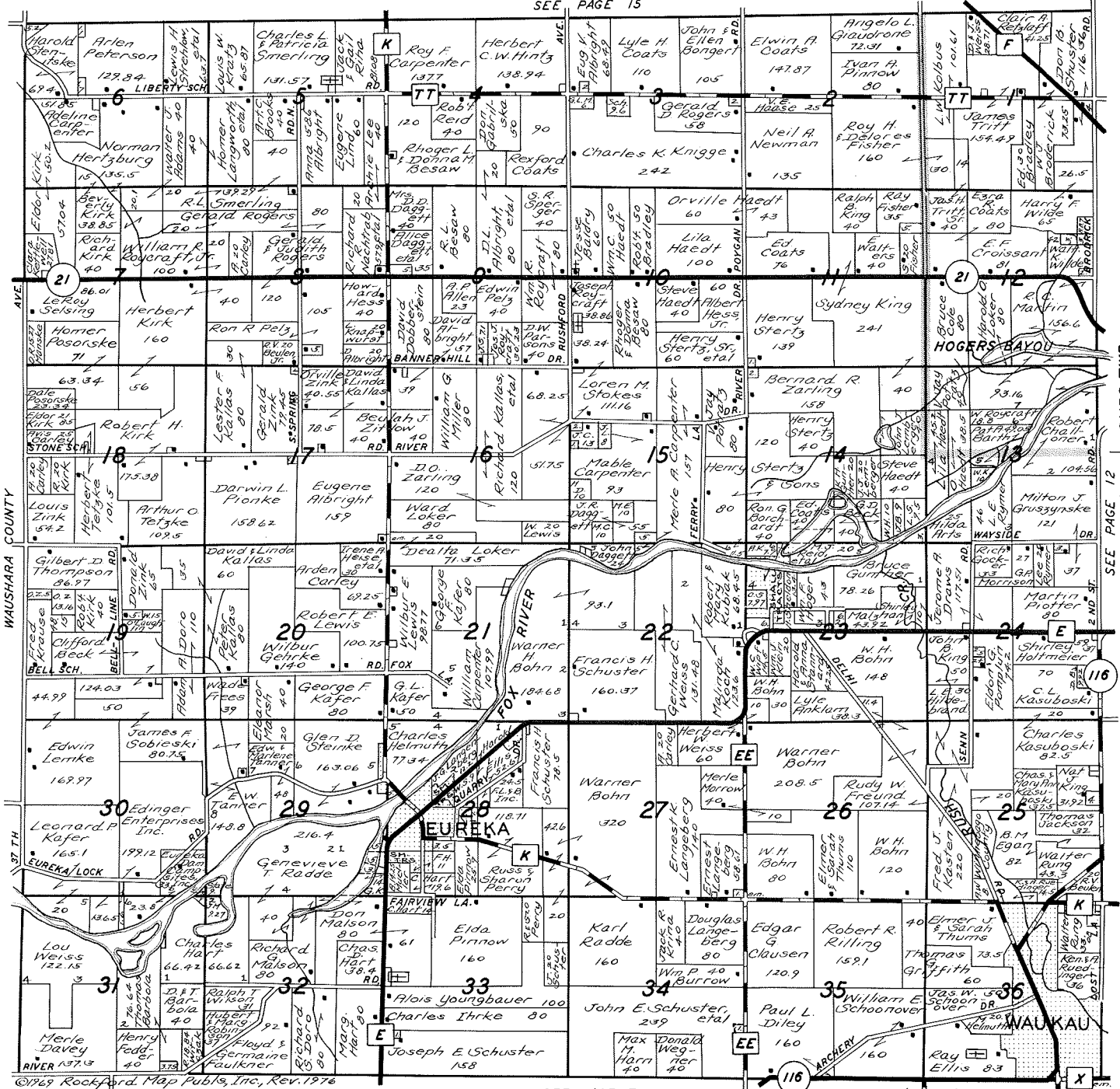

SEE PAGE 7

Winnebago County, Wis.



JOIN

THE 4-H TODAY



HOME ABSTRACT & TITLE CO.

"V. R. Wassenberg, Owner" — Abstracts of Title - Title Insurance

Member Wisconsin and American Land Title Association  
Representing Title Insurance Company of Minnesota

7 CHURCH AVENUE - P.O. BOX 74 - OSHKOSH 54901 - PHONE: 235-7760



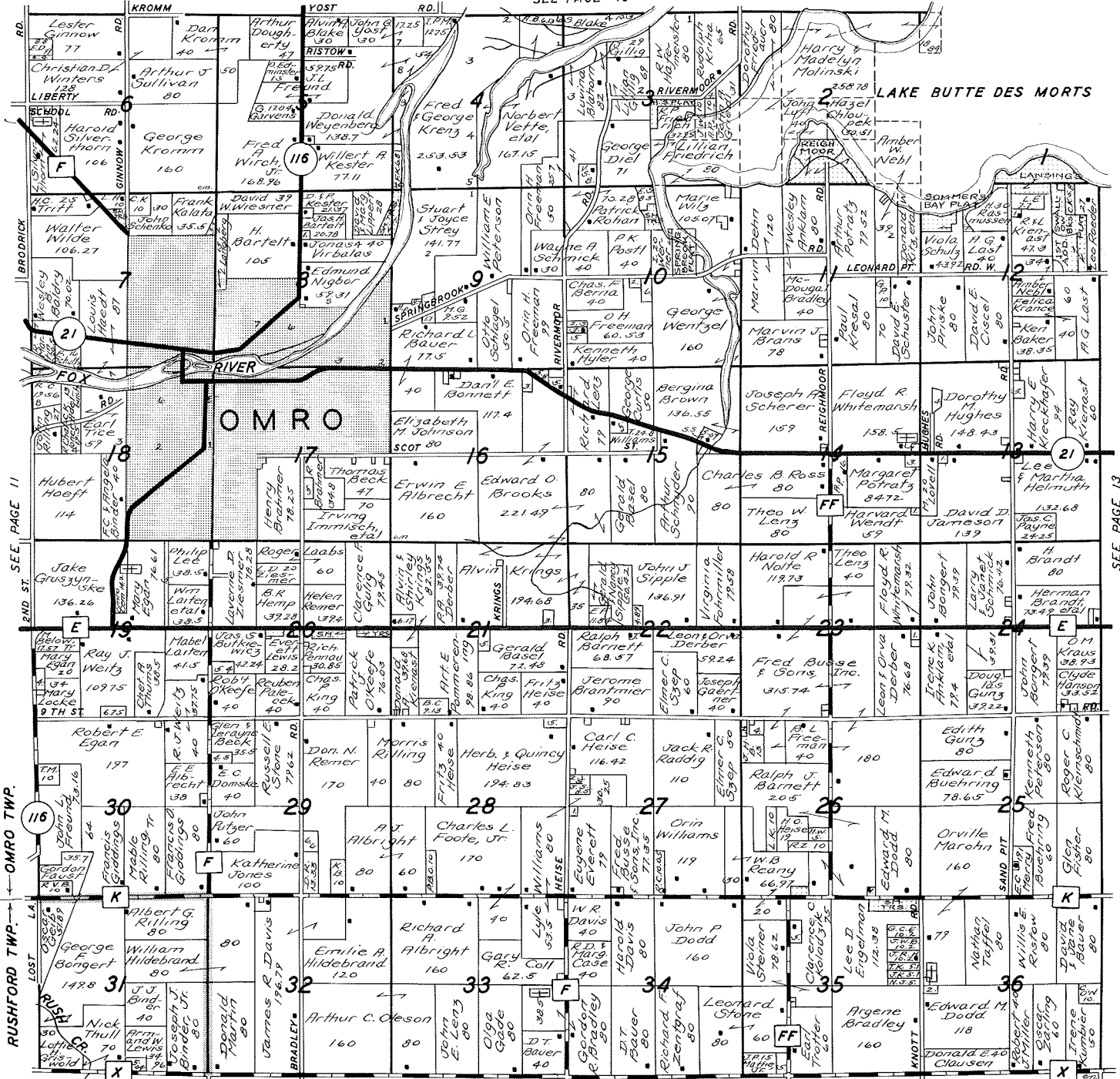

©1969 Rockford Map Publ's, Inc., Rev. 1976

SEE PAGE 8

Winnebago County, Wis.

**John L. Freund**  
 Realty, Inc.  
 Auctioneer & Realtor  
 Freund Auctions  
 "The Sound That Sells"



PHONE: 685-2747 or 231-2335 or 921-3290  
 206 WEST RIVER DRIVE - OMRO, WISCONSIN 54963

**GEO. DAGGETT & SON CO.**

GENERAL FARM SUPPLY  
 Bird Seed - Specialty Feeds - Water Softener Salt  
 Farm Hardware - Barn Equipment Parts  
 Seeds - Fertilizer - Seed Cleaning & Treating  
 Complete Feed Service - Grinding - Mixing  
 Flour - Feed - Grains - Steel Products  
 Fencing - Post - Lawn Seed - Lawn Fertilizer

OFFICE & WAREHOUSE - PHONE: 685-2021  
 251 EAST MAIN STREET - OMRO, WISCONSIN 54963



SEE PAGE 14

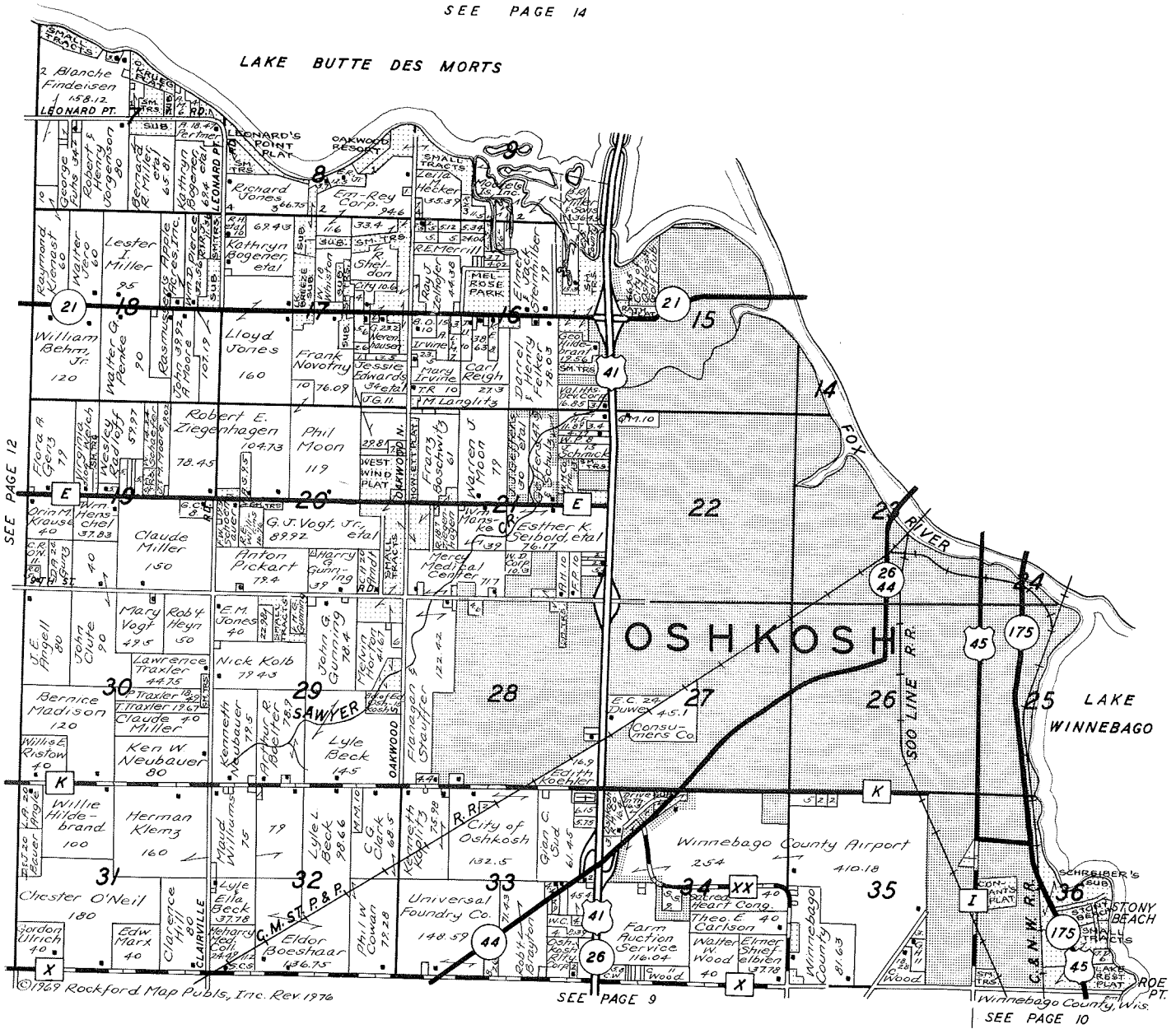

30,406 PAID SUBSCRIBERS	
6 Month ABC Statement Ending September 30, 1975	
Read The	
<b>OSHKOSH</b>	
<b>DAILY NORTHWESTERN</b>	
224 STATE STREET - PHONE: 235-7700	
SIX DAYS A WEEK	
24,118 IN WINNEBAGO COUNTY	
Subject to ABC Audit	

OSHKOSH.....	17,451
BUTTE DES MORTS.....	121
EUREKA.....	60
LARSEN.....	209
NEENAH MENASHA.....	4,071
OMRO.....	1,158
PICKETT.....	150
WAUKAU.....	79
WINNECONNE.....	819
<b>TOTAL</b>	<b>24,118</b>

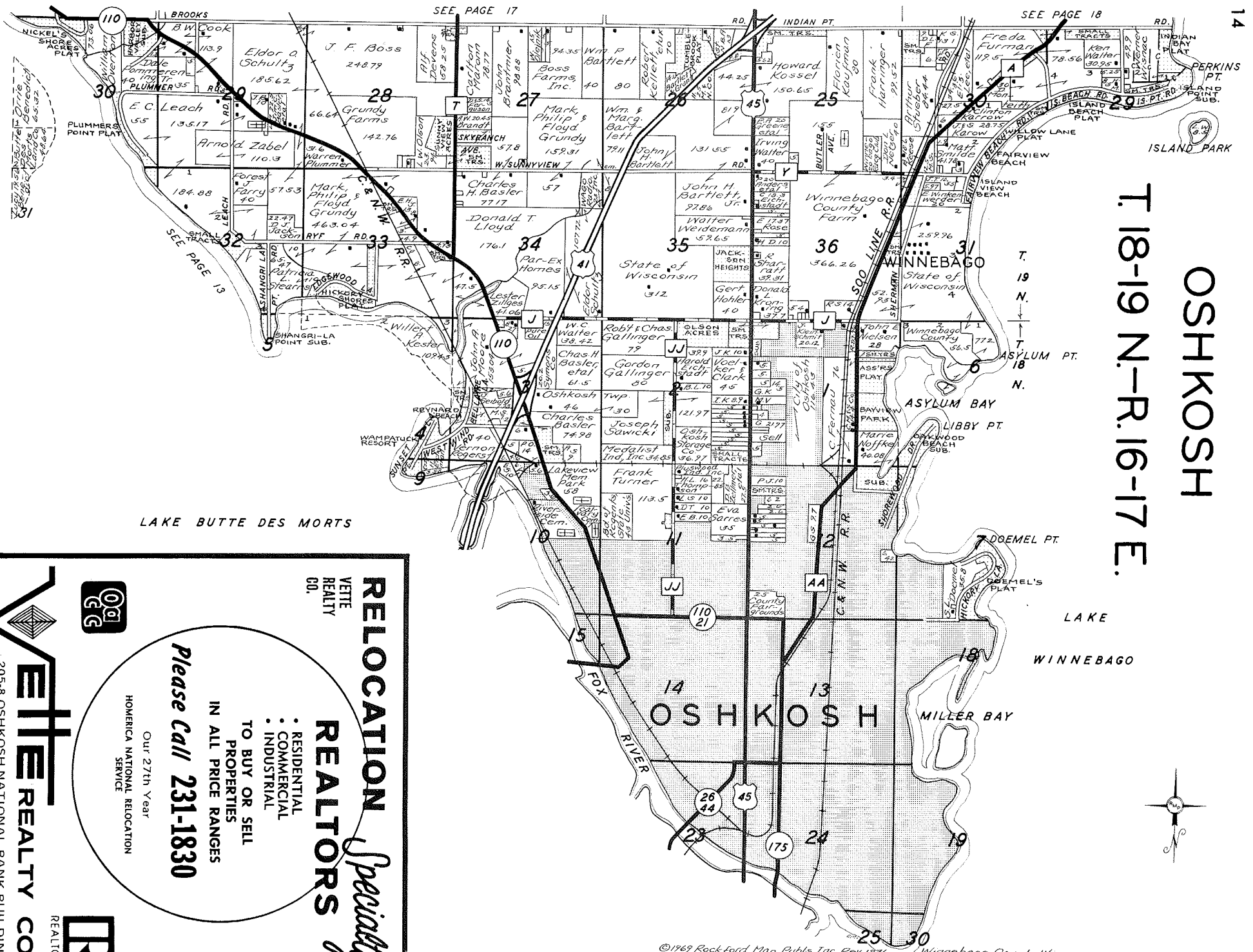

**OSHKOSH**  
**T. 18-19 N.-R. 16-17 E.**

LAKE BUTTE DES MORTS

LAKE WINNEBAGO

©1969 Rockford Map Publ. Inc. Rev. 1974  
 Winnebago County, Wis.  
 R. 16 E. ← R. 17 E.



**RELOCATION**  
**REALTORS**  
*Specialty*

**RELOCATION**  
**REALTORS**  
*Specialty*

**• RESIDENTIAL**  
**• COMMERCIAL**  
**• INDUSTRIAL**

**TO BUY OR SELL**  
**PROPERTIES**  
**IN ALL PRICE RANGES**

**Please Call 231-1830**

Our 27th Year  
 HOMERICA NATIONAL RELOCATION SERVICE



**REALTOR**





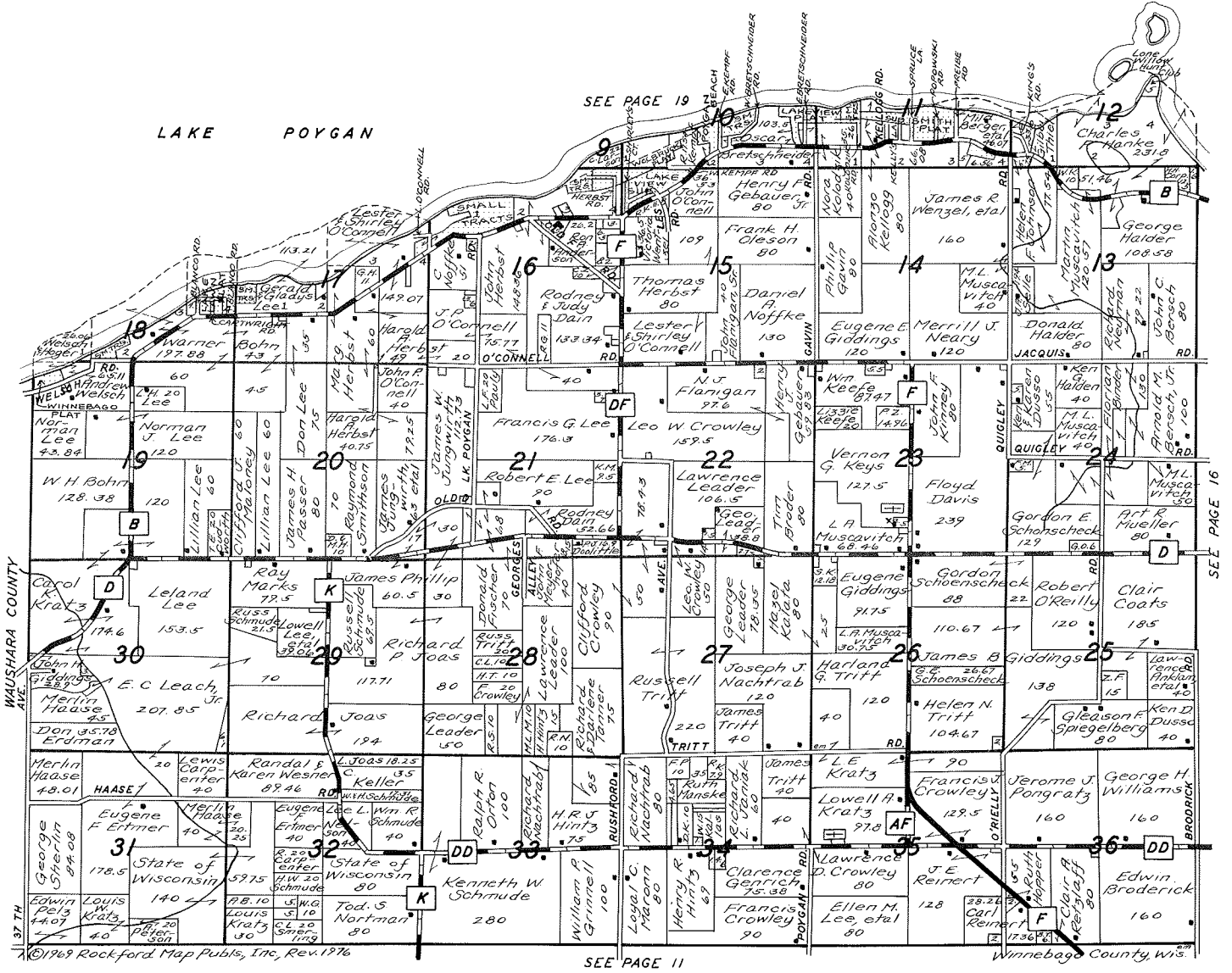

©1969 Rockford Map Publ's, Inc., Rev. 1976

SEE PAGE 11

Winnebago County, Wis.

# WINNECONNE

# T. 19 N.-R. 15 E.

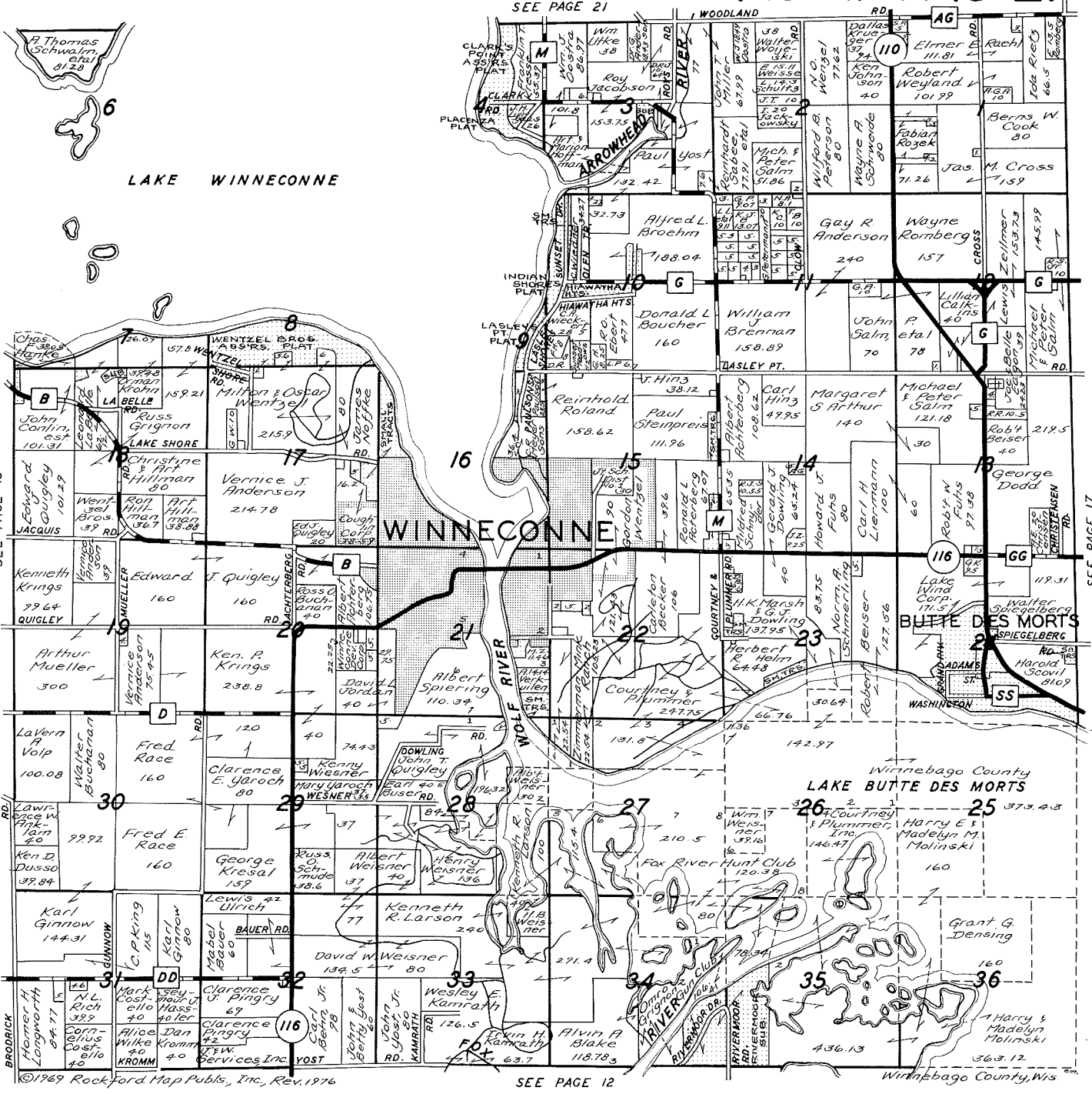

16  
14  
SEE PAGE 18

SEE PAGE 21

SEE PAGE 15

SEE PAGE 17

SEE PAGE 14

©1969 Rockford Map Pubs, Inc., Rev. 1976

SEE PAGE 12

Winnebago County, Wis.

## JAMES P. COUGHLIN

Real Estate & Insurance

Phone: 582-4420

or 582-4527



136 WEST MAIN STREET  
WINNECONNE, WISCONSIN 54986



THE CLOSER YOU LOOK  
THE BETTER WE LOOK

## WENTZEL FORD INC.

FORD CARS  
TRUCKS  
TRACTORS



IMPLEMENTS  
GEHL &  
NEW HOLLAND

CAR RENTALS & LEASING

905 East Main - Winneconne, Wisconsin 54986  
Phone: 582-4221 - Parts Phone: 582-4692



Sperry New Holland is a Division of Sperry Rand Corporation

SEE PAGE 22

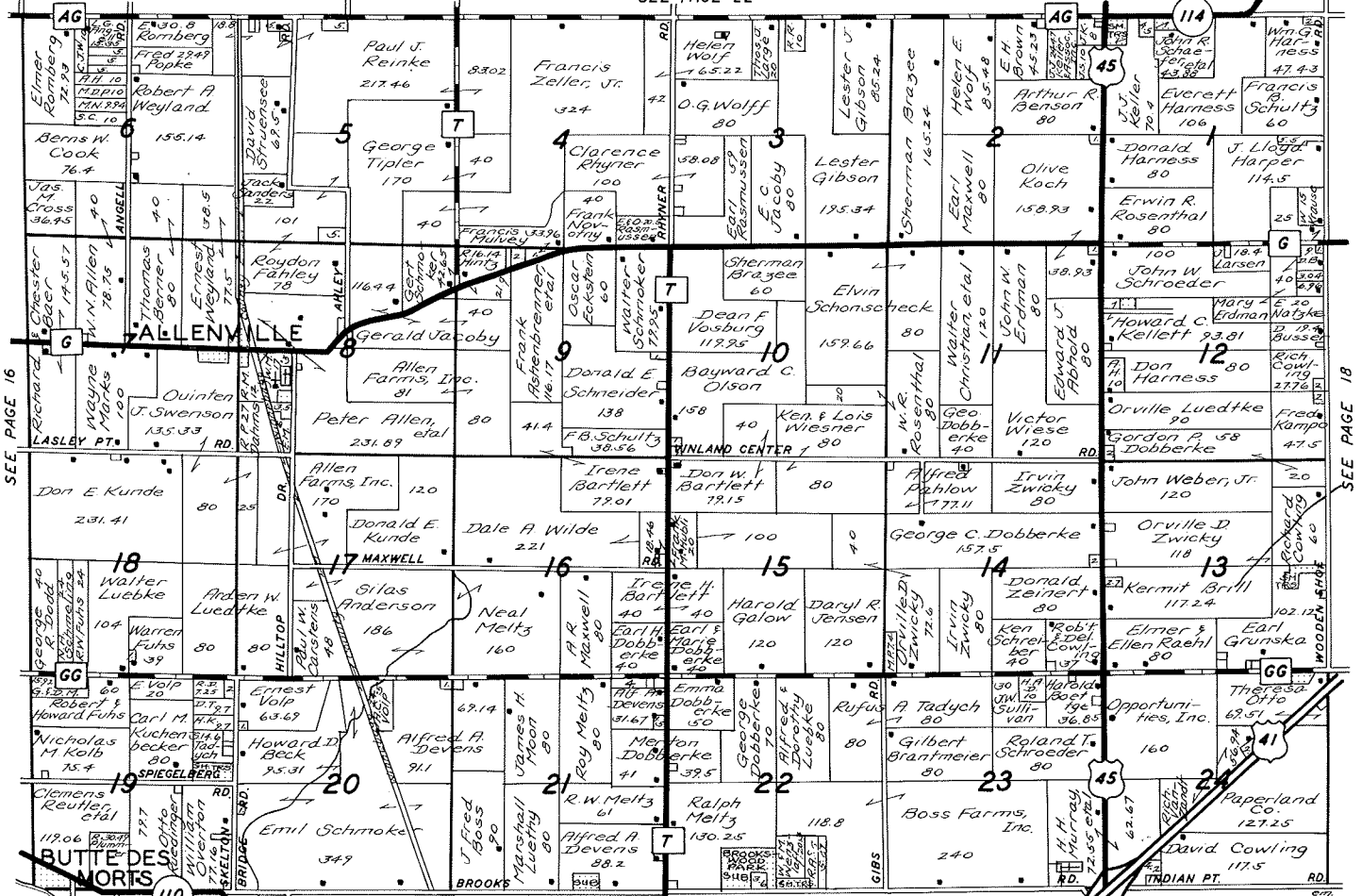

L. BUTTE DES MORTS ©1969 Rockford Map Publs, Inc., Rev. 1976

SEE PAGE 14

Winneshago County, Wis.

# MERT DOBBERKE

## REALTOR & AUCTIONEER



HOMES - COMMERCIAL - FARMS



Office: 231-1118 - Residence: 231-1912

"You'll Be Glad We Got Together"

128 Bowen Street - Oshkosh, Wisconsin 54901



# JOIN



# THE 4-H TODAY

# NEENAH EAST PART VINLAND

# T. 19-20 N. R. 17 E.

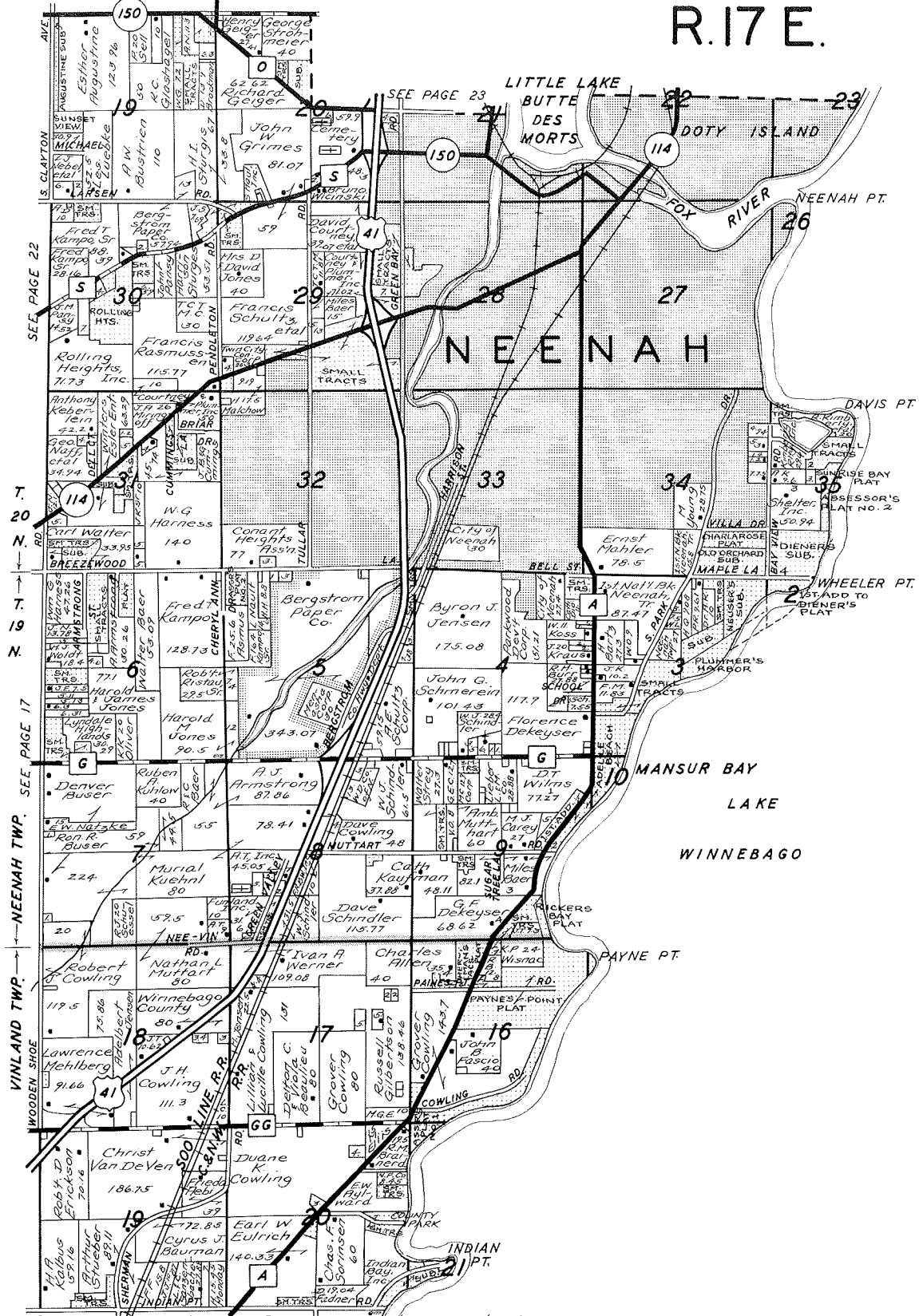

SEE PAGE 18

SEE PAGE 22

SEE PAGE 23

SEE PAGE 17

VINLAND TWP. - NEENAH TWP.

WOODEN SHOE

300' LINE R.R.

WINNEBAGO COUNTY

INDIAN

INDIAN

INDIAN

INDIAN

INDIAN

INDIAN

INDIAN

INDIAN

INDIAN

INDIAN

INDIAN

INDIAN

INDIAN

INDIAN

INDIAN

INDIAN

INDIAN

INDIAN

INDIAN

INDIAN

INDIAN

INDIAN



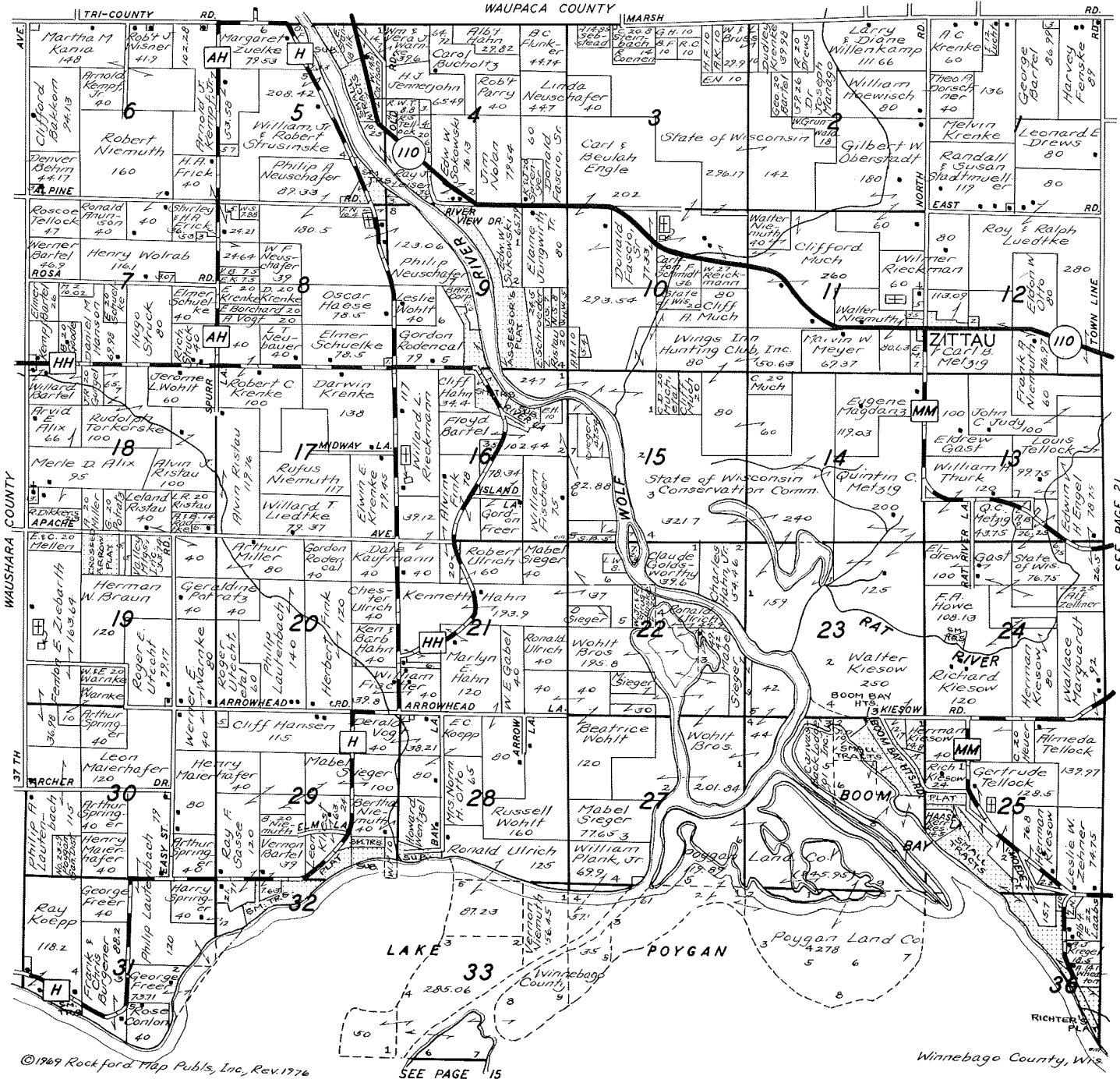

©1969 Rockford Map Publs, Inc., Rev. 1976

SEE PAGE 15

Winneshago County, Wis

SEE PAGE 21

For  
 Complete Banking and Trust Services  
**Marine National Bank of Neenah**



111 East Wisconsin Avenue - Neenah 54956 - Phone: 725-4371

Member FDIC

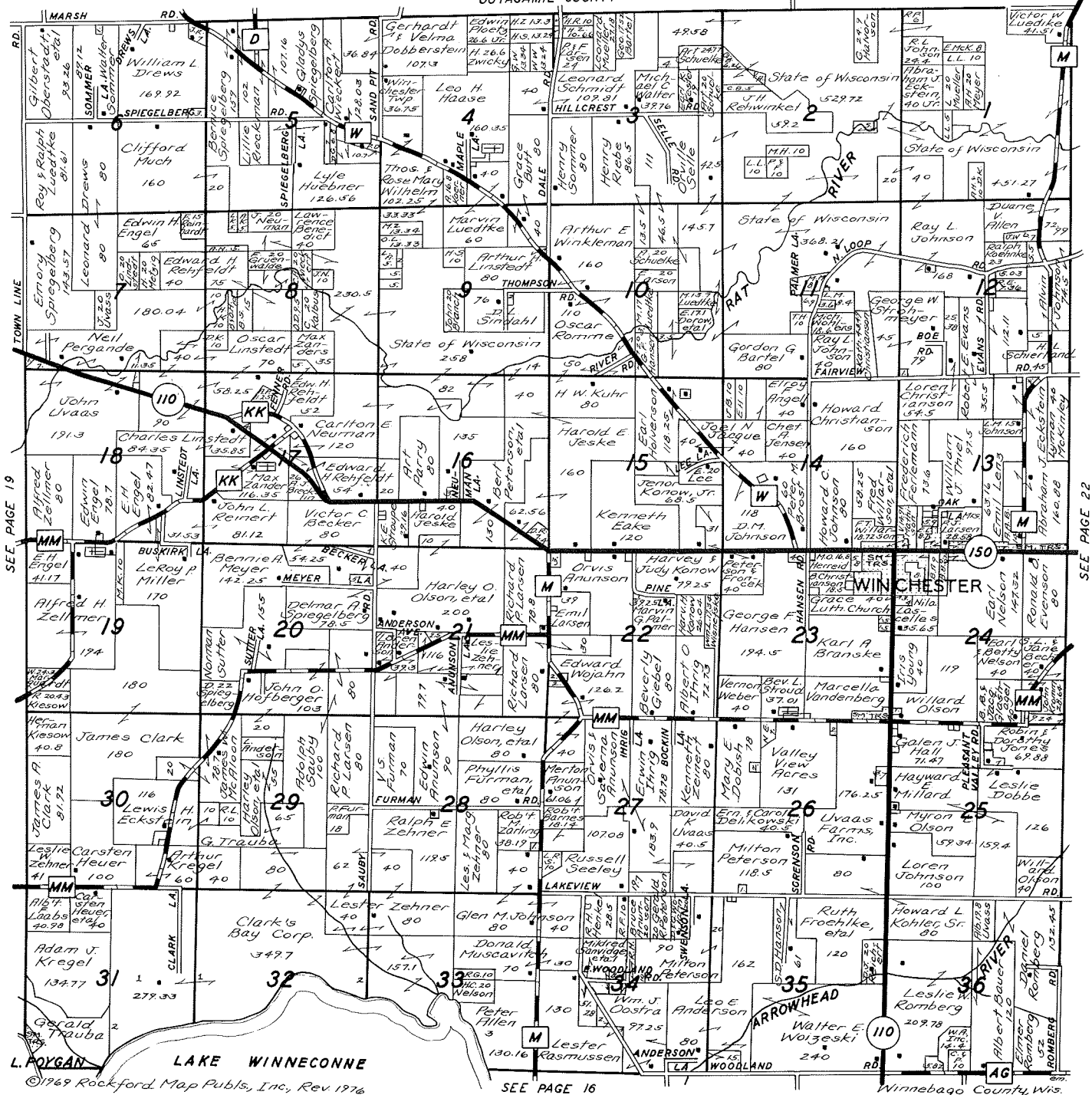

©1969 Rockford Map Publs, Inc., Rev 1976

SEE PAGE 16

Winnebago County, Wis.



## THE FARMERS STATE BANK

LARSEN, WISCONSIN 54947 - PHONE: 836-2101

CONVENIENT BANKING HOURS

Monday thru Thursday, 8:30 A.M. to 3:30 P.M.

Fridays, 8:30 A.M. to 8:30 P.M.

Closed Saturdays



Serving the Community Since 1914

MEMBER FEDERAL DEPOSIT INSURANCE CORP., MAXIMUM INSURANCE \$40,000.00



# CLAYTON

OUTAGAMIE COUNTY

# T. 20 N.-R. 16 E.

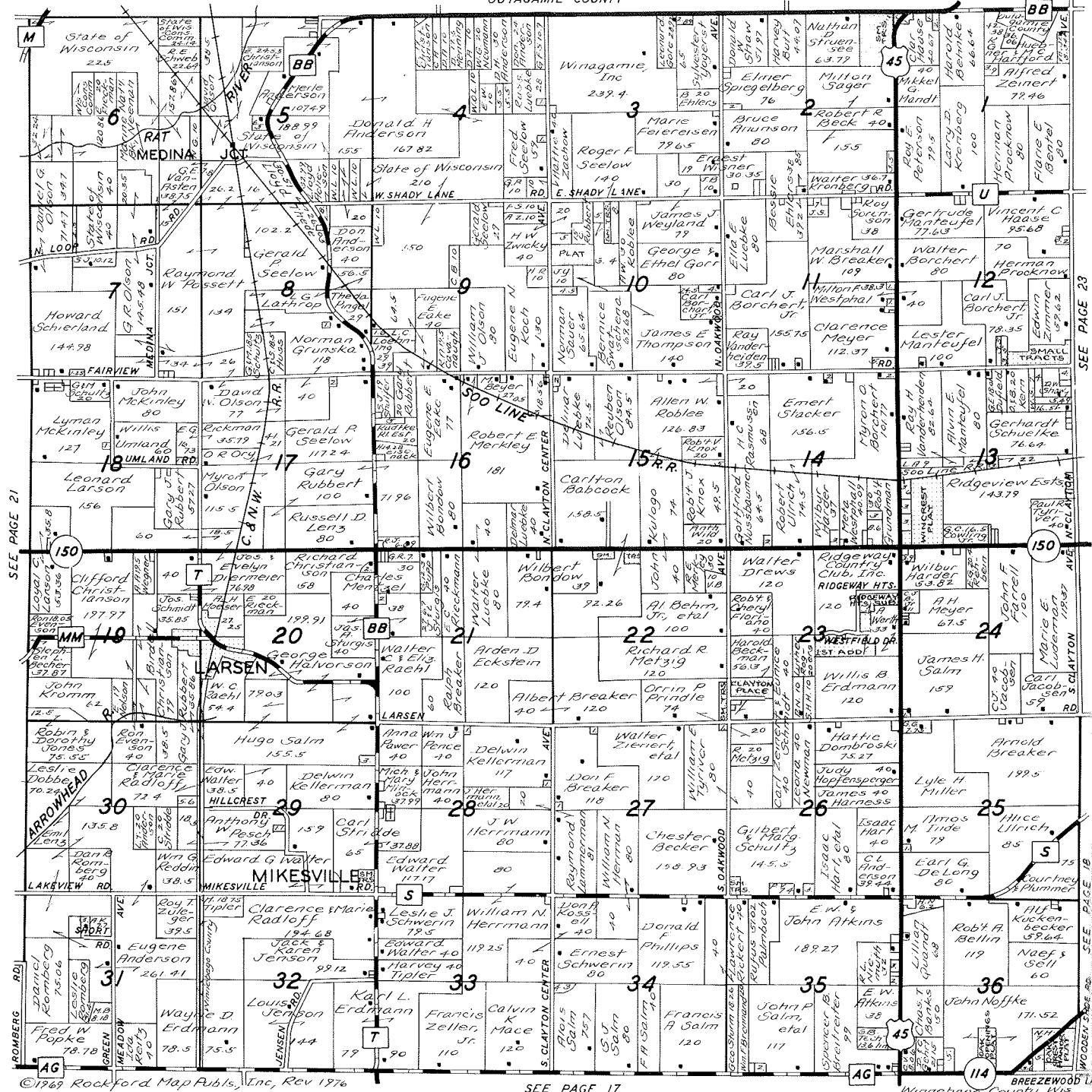

©1969 Rockford Map Publs., Inc., Rev 1976

SEE PAGE 17

Winneshago County Wis



## THE FARMERS STATE BANK

LARSEN, WISCONSIN 54947 - PHONE: 836-2101

CONVENIENT BANKING HOURS

Monday thru Thursday, 8:30 A.M. to 3:30 P.M.  
Fridays, 8:30 A.M. to 8:30 P.M.  
Closed Saturdays



Serving the Community Since 1914

MEMBER FEDERAL DEPOSIT INSURANCE CORP., MAXIMUM INSURANCE \$40,000.00



# MENASHA

# T. 20 N.-R. 17 E.

OUTAGAMIE COUNTY

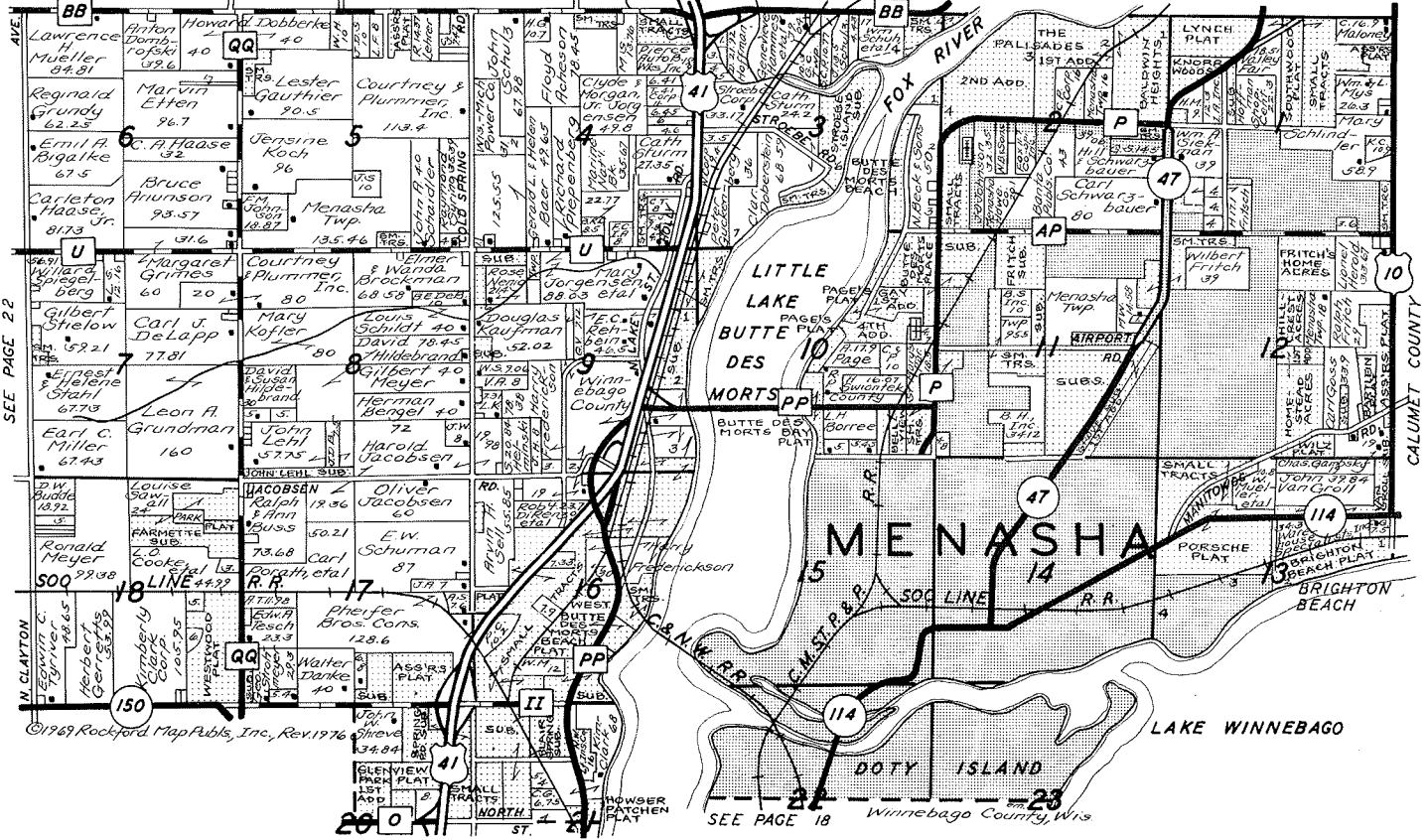

SEE PAGE 22

SEE PAGE 22

©1969 Rockford Map Publs, Inc., Rev. 1976

SEE PAGE 18 Winnebago County, Wis

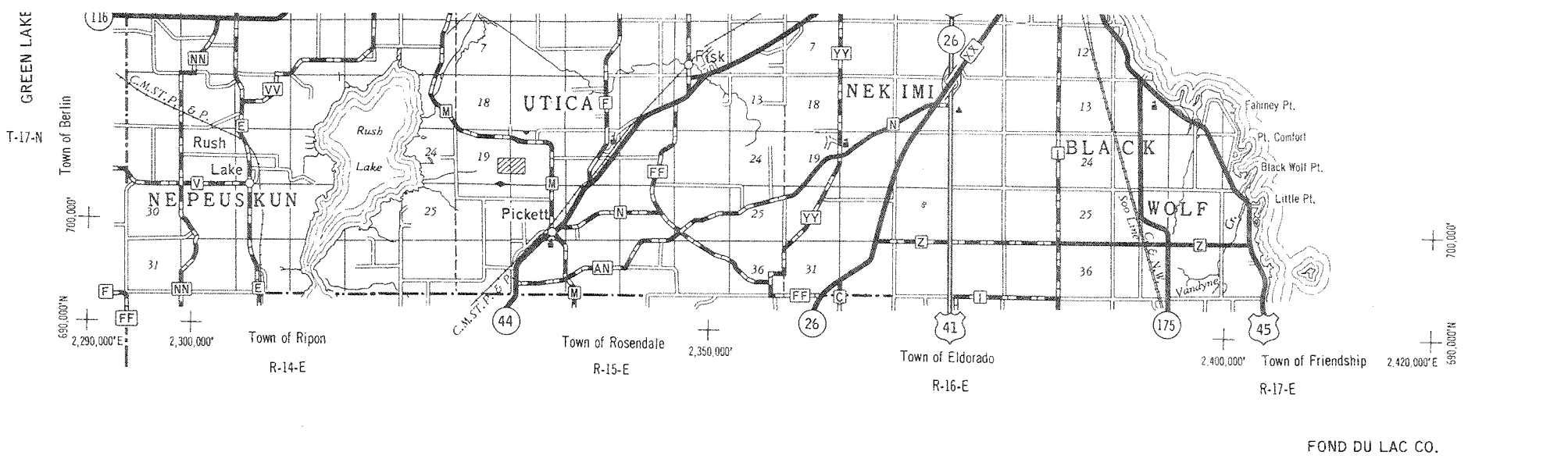
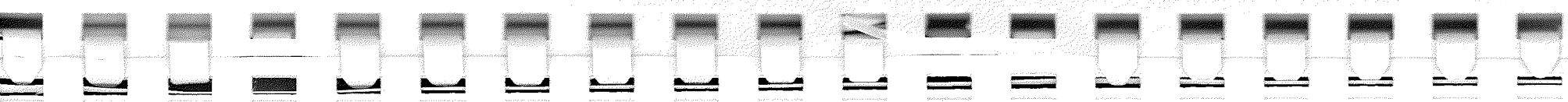
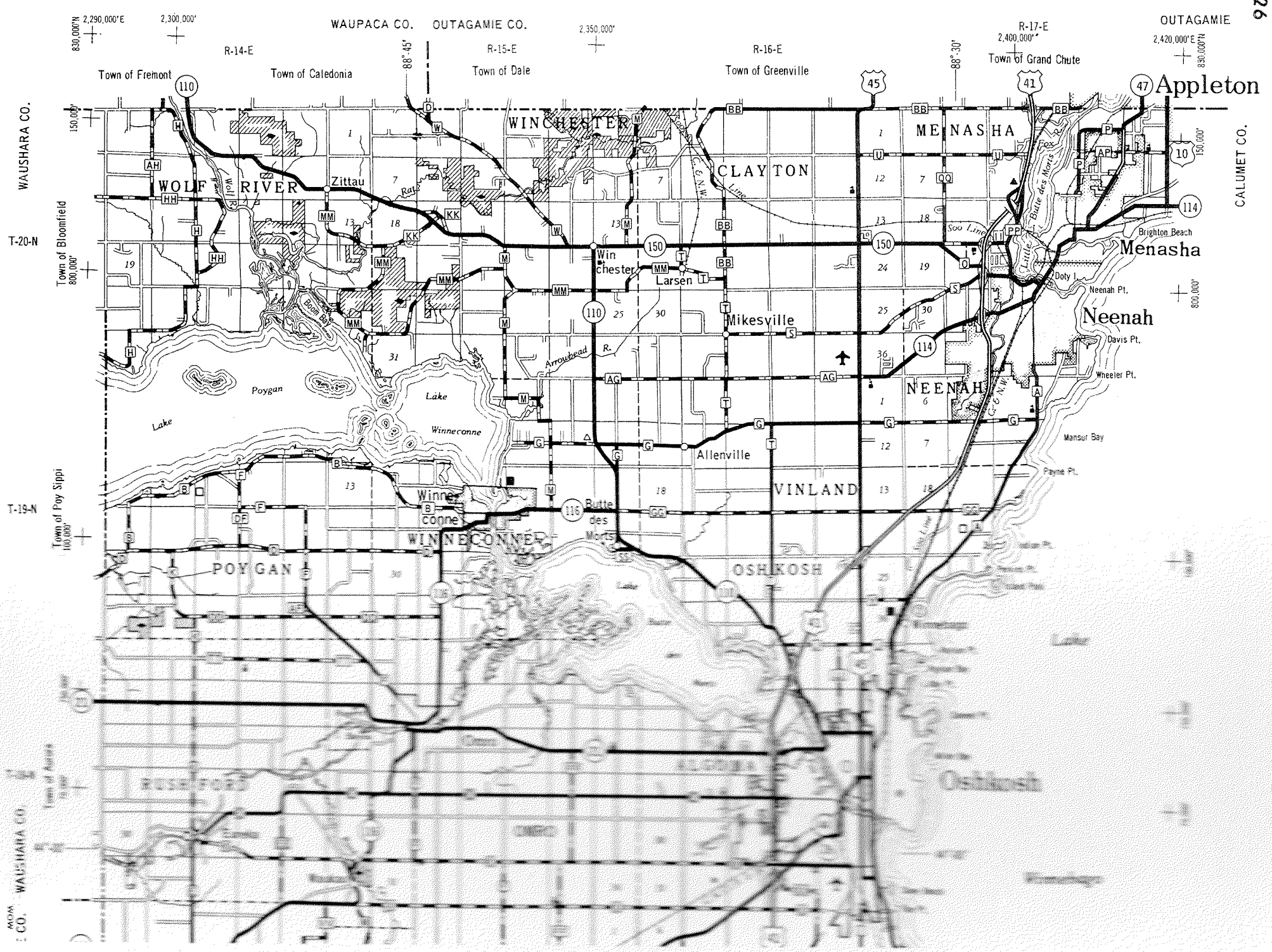

Copyright 1969 - Revised 1976  
 ROCKFORD MAP PUBLISHERS, Inc.

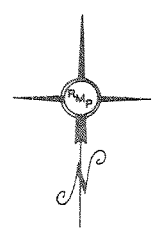

# GENERAL HIGHWAY MAP WINNEBAGO COUNTY WISCONSIN

SCALE 0 1 2 MILES

### LEGEND

- |                                    |                     |                            |     |
|------------------------------------|---------------------|----------------------------|-----|
| Portland Cement or Bitum. Concrete | U.S. & STATE COUNTY | Civil Town Boundary        | --- |
| Bituminous                         | ---                 | Corporate Limits           | --- |
| Gravel                             | ---                 | Nat. & State Forests       | --- |
| Earth                              | ---                 | Airport                    | ✈   |
| °Town Road                         | ---                 | Fish Hatchery              | 🐟   |
| Fire Lane                          | ---                 | Game Farm                  | 🏠   |
| Multilane Divided                  | ---                 | County Seat                | ⊙   |
| Freeway                            | ---                 | Unincorp. Village          | ○   |
| Interchange                        | ---                 | Schools                    | 🎓   |
| Highway Separation                 | ---                 | Public Hunt or Fish. Grds. | 🏹   |
| Interstate Highway No.             | ---                 | Hospital                   | 🏥   |
| U.S. Highway No.                   | ---                 | Lookout Tower              | 🗼   |
| State Highway No.                  | ---                 | Ranger Station             | 🏠   |
| County Hwy. Letter                 | ---                 | Public Camp & Picnic Grds. | 🏕   |
| Railroad                           | ---                 | State Park                 | 🌲   |
| Dam                                | ---                 | With Campsites             | 🏕   |
| State Boundary                     | ---                 | Without Campsites          | 🌲   |
| County Boundary                    | ---                 | With Facilities            | 🏠   |
|                                    |                     | County Park                | 🌲   |
|                                    |                     | Without Facilities         | 🌲   |
|                                    |                     | With Facilities            | 🏠   |
|                                    |                     | Wayside                    | 🚰   |
|                                    |                     | Without Facilities         | 🚰   |

\*Surface types on town roads not shown.

### ALPHABETICAL INDEX TO TOWNSHIP MAPS

ALGOMA	13
BLACK WOLF	10
CLAYTON	22
MENASHA	23
NEENAH	18
NEKIMI	9
NEPEUSKUN	7
OMRO	11,12
OSHKOSH	14
POYGAN	15
RUSHFORD	7,8,11,12
UTICA	8
VINLAND	17,18
WINCHESTER	21
WINNECONNE	16
WOLF RIVER	19

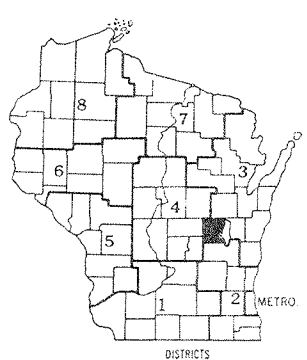



INDEX TO OWNERS

Table with columns: Name, Sec.-Page, Name, Sec.-Page, Name, Sec.-Page, Name, Sec.-Page, Name, Sec.-Page. Includes sections for A, B, and C.

LEE TRUCK SALES, INC.



2625 SOUTH WASHBURN STREET (HIWAY 41 & 44)
OSHKOSH, WISCONSIN 54901
PHONE: 414 - 231-4020
Direct Fond du Lac Line: 921-3412

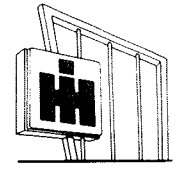

INTERNATIONAL TRUCKS
COMPLETE BODY & PAINT SHOP

PARTS & SERVICE 7 A.M. to MIDNITE
TRUCK LEASING & RENTALS

Continuation of the index table with columns: Name, Sec.-Page, Name, Sec.-Page, Name, Sec.-Page, Name, Sec.-Page, Name, Sec.-Page.

C

Small table listing names and page numbers under section C.



INDEX TO OWNERS

Table with 12 columns: Name, Sec.-Page, Name, Sec.-Page, Name, Sec.-Page, Name, Sec.-Page, Name, Sec.-Page. Lists various owners and their corresponding page numbers.



TWIN CITY CONCRETE CORPORATION

Central Mixed Concrete - Mortar Bag Cement Expansion Joints and Wire Mesh

PHONE: 414 - 722-7703 NEENAH, WISCONSIN 54956

SERVING THE FOX RIVER VALLEY AREA

DIAL DIRECT OR CALL COLLECT P.O. BOX 767

COURTNEY & PLUMMER INCORPORATED

Crushed Gravel and Stone - Washed Sand and Gravel Mason Sand - Road & Parking Lot Construction Agricultural Limestone - Equipment Rentals

PHONE: 1 - 414 - 722-7703 NEENAH, WISCONSIN 54956



Table listing owners and page numbers under the letter 'C'.

D

Table listing owners and page numbers under the letter 'D'.

Table listing owners and page numbers under the letter 'D'.

E

Table listing owners and page numbers under the letter 'E'.

Table listing owners and page numbers under the letter 'E'.

F

Table listing owners and page numbers under the letter 'F'.

Table listing owners and page numbers under the letter 'F'.

G

Table listing owners and page numbers under the letter 'G'.

INDEX TO OWNERS

Table with 4 columns: Name, Sec.-Page, Name, Sec.-Page, Name, Sec.-Page, Name, Sec.-Page. Contains names and page numbers for various owners.

INDEX TO OWNERS

Table with columns: Name, Sec.-Page, Name, Sec.-Page, Name, Sec.-Page, Name, Sec.-Page. Lists owners and their corresponding page numbers across four columns.

INDEX TO OWNERS

Table with 10 columns: Name, Sec.-Page, Name, Sec.-Page, Name, Sec.-Page, Name, Sec.-Page, Name, Sec.-Page. Lists owners and their corresponding page numbers, organized into sections P, Q, R, S.

INDEX TO OWNERS

Table with columns: Name, Sec.-Page, Name, Sec.-Page, Name, Sec.-Page, Name, Sec.-Page, Name, Sec.-Page. Lists owners and their corresponding page numbers across multiple columns.