

TO THE WINNEBAGO COUNTY BOARD SUPERVISORS

Your Planning and Zoning Committee begs leave to report:

WHEREAS, it has reviewed the Petition for Comprehensive Land Use Plan amendment 21-LUPA-5910 filed with the County Clerk by:

Town of Nepeuskun

WHEREAS, a Public Hearing was held on, 9/28/2021 pursuant to mailed and published notice as provided by as on the following:

PROPERTY INFORMATION:

Applicant(s): Town of Nepeuskun

WHEREAS,

Applicant is requesting an amendment to the Winnebago County Comprehensive Future Land Use Plan in order to amend the Farmland Preservation Plan element.

And

WHEREAS, your Planning and Zoning Committee, being fully informed of the facts, and after full consideration of the matter, making the following findings:

1. There were no objections.
2. Proposed amendment is to include an amendment to the Farmland Preservation Map in the County's Comprehensive Future Land Use Plan.

NOW THEREFORE BE IT RESOLVED, that this committee hereby reports our findings for your consideration and is hereby recommending APPROVAL OR DENIAL. Vote: 5-0

AND BE IT FURTHER RESOLVED, by the Winnebago County Board of Supervisors, that the enclosed Ordinance is hereby ADOPTED OR DENIED.

For the Planning and Zoning Committee

AMENDATORY ORDINANCE 10/04/21

The Winnebago County Board of Supervisors do ordain Comprehensive Land Use Plan Amendment # 21-LUPA-5910 as follows:

Applicant is requesting an amendment to the Winnebago County Comprehensive Future Land Use Plan in order to amend the Farmland Preservation Plan element.

Adopted Denied this _____ day of _____, 20

Shiloh Ramos - Chairman

ATTEST:

Susan T. Ertmer, Clerk

APPROVED BY WINNEBAGO COUNTY EXECUTIVE THIS _____ DAY OF _____, 2021.

Jon Doemel
County Executive

Town of Nepeuskun
Winnebago County, Wisconsin
Farmland Preservation Plan

Farmland Preservation Areas

 Areas of Agricultural Use and Agriculture Related Use

Nonagricultural Development Areas

 Areas of Nonagricultural Development

Map Features

-  Parcel Lines
-  Section Lines
-  Waterways
-  Open Water

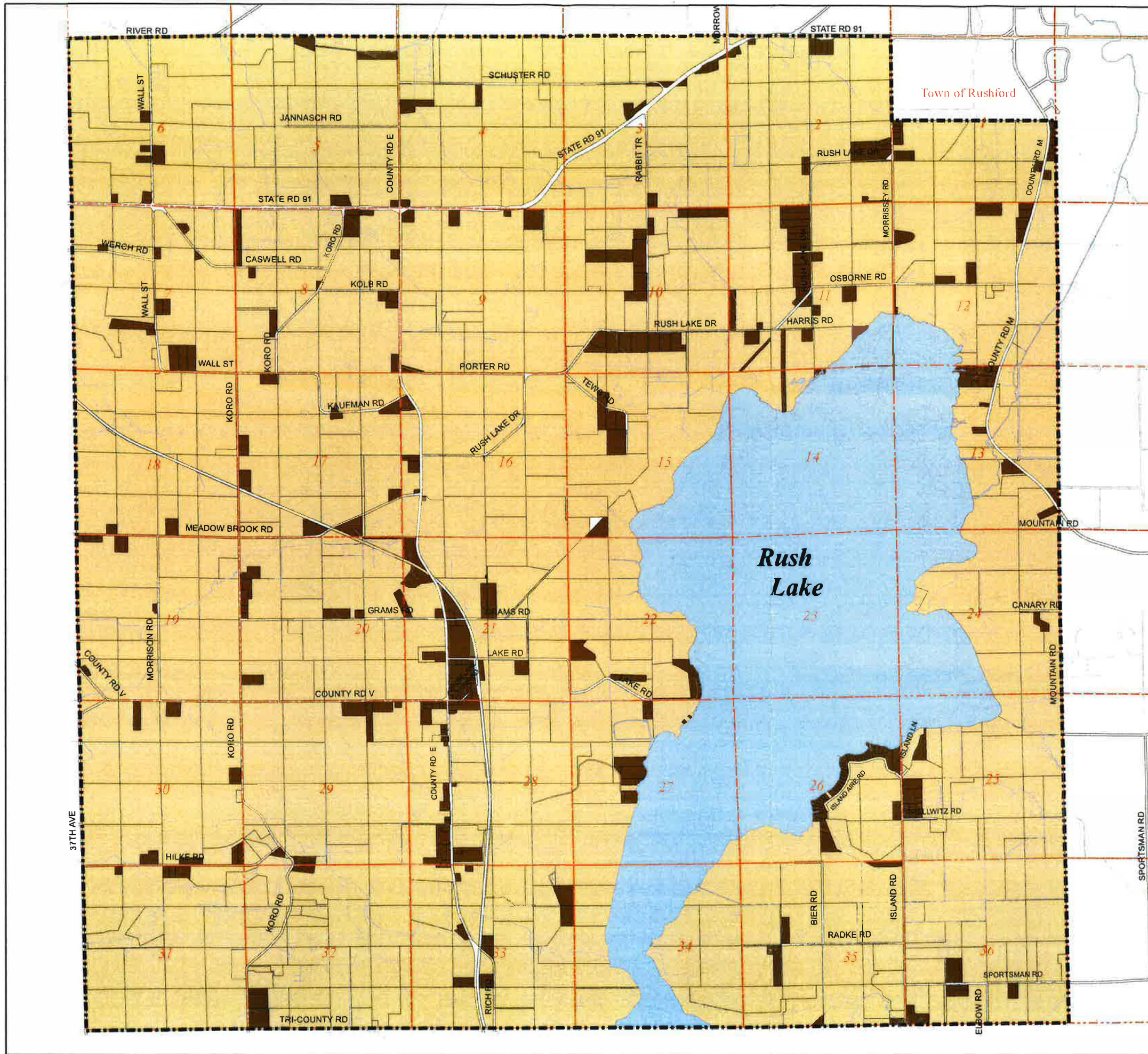

Approximate Scale



This base map was created by Winnebago County, who expressly disclaims all liability regarding fitness of use of the information. The user is responsible for understanding the accuracy limitations of the data provided herein.

Martenson & Eisele, Inc.

 1377 Midway Road
Menasha, WI 54952
www.martenson-eisele.com
info@martenson-eisele.com
920.731.0381 1.800.236.0381

Planning
Environmental
Surveying
Engineering
Architecture

Town of Nepeuskun
Winnebago County, Wisconsin

Farmland Preservation Plan







Farmland Preservation Areas

 Areas of Agricultural Use and Agriculture Related Use

Nonagricultural Development Areas

 Areas of Nonagricultural Development

Map Features

-  Municipal Boundary
-  Section Lines
-  Parcel Lines
-  Right of Way Lines
-  Waterways
-  Open Water

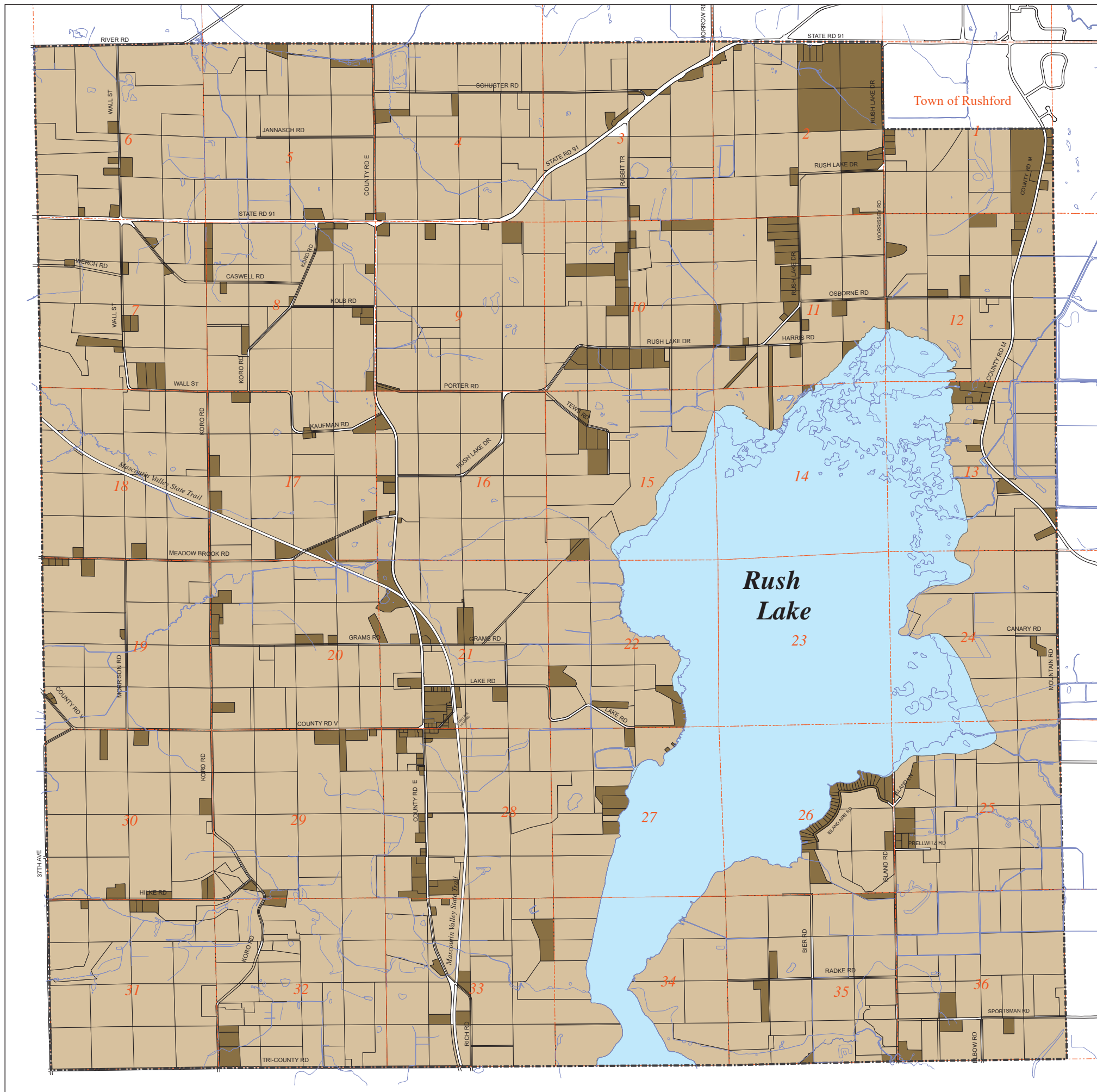

Note : In the event of any conflicts between interpretation of the County's Proposed Land Use Plan Map and the County's Farmland Preservation Plan Map, the County's Farmland Preservation Plan Map shall take precedence over other future land use classifications on the Proposed Land Use Map for the purposes of planning for agriculture.



This base map was created by Winnebago County, who expressly disclaims all liability regarding fitness of use of the information. The user is responsible for understanding the accuracy limitations of the data provided herein.

Martenson & Eisele, Inc.

1377 Midway Road
Menasha, WI 54952
www.martenson-eisele.com
info@martenson-eisele.com
920.731.0381 1.800.236.0381
argis10328002gis.mxd_08/17/2021

Planning
Environmental
Surveying
Engineering
Architecture