

NORTH

0 40' 80'

DRAWING SCALE

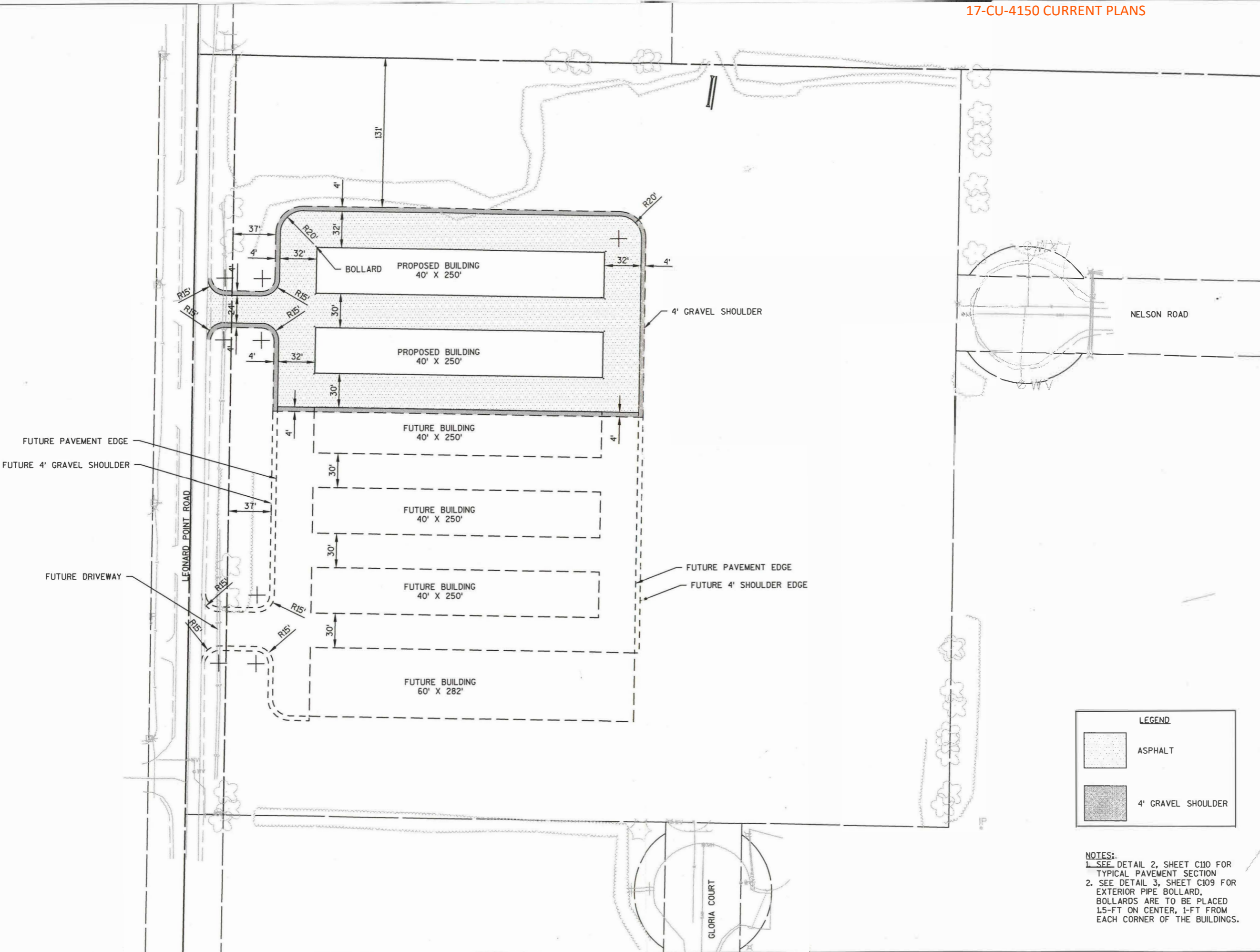

ALGOMA SELF-STORAGE UNITS

**TOWN OF ALGOMA
WINNEBAGO COUNTY, WI**

Omni
ASSOCIATES
ONE SYSTEMS DRIVE
APPLETON, WI 54914
(920) 735-6900

REV. DATE DESCRIPTION

REV.	DATE	DESCRIPTION

SHEET DESCRIPTION

SITE PLAN

PROJECT MANAGER: EAM

PROJ NO: M1483A17

DATE: DATE 3/30/2017

DRAWING NO.

C102

LEGEND

	ASPHALT
	4' GRAVEL SHOULDER

- NOTES:**
- SEE DETAIL 2, SHEET C110 FOR TYPICAL PAVEMENT SECTION
 - SEE DETAIL 3, SHEET C109 FOR EXTERIOR PIPE BOLLARD. BOLLARDS ARE TO BE PLACED 15-FT ON CENTER, 1-FT FROM EACH CORNER OF THE BUILDINGS.

File Name: F:\Municipal\Notes\M1483A17 - Algoma Storage Sheds\Civil 3D 2014\Sheets\Plan\PlantC11_M1483A17_Landscape Plan.dwg
 Plotted By: BORTZE on 04/26/2017 at 01:56 PM

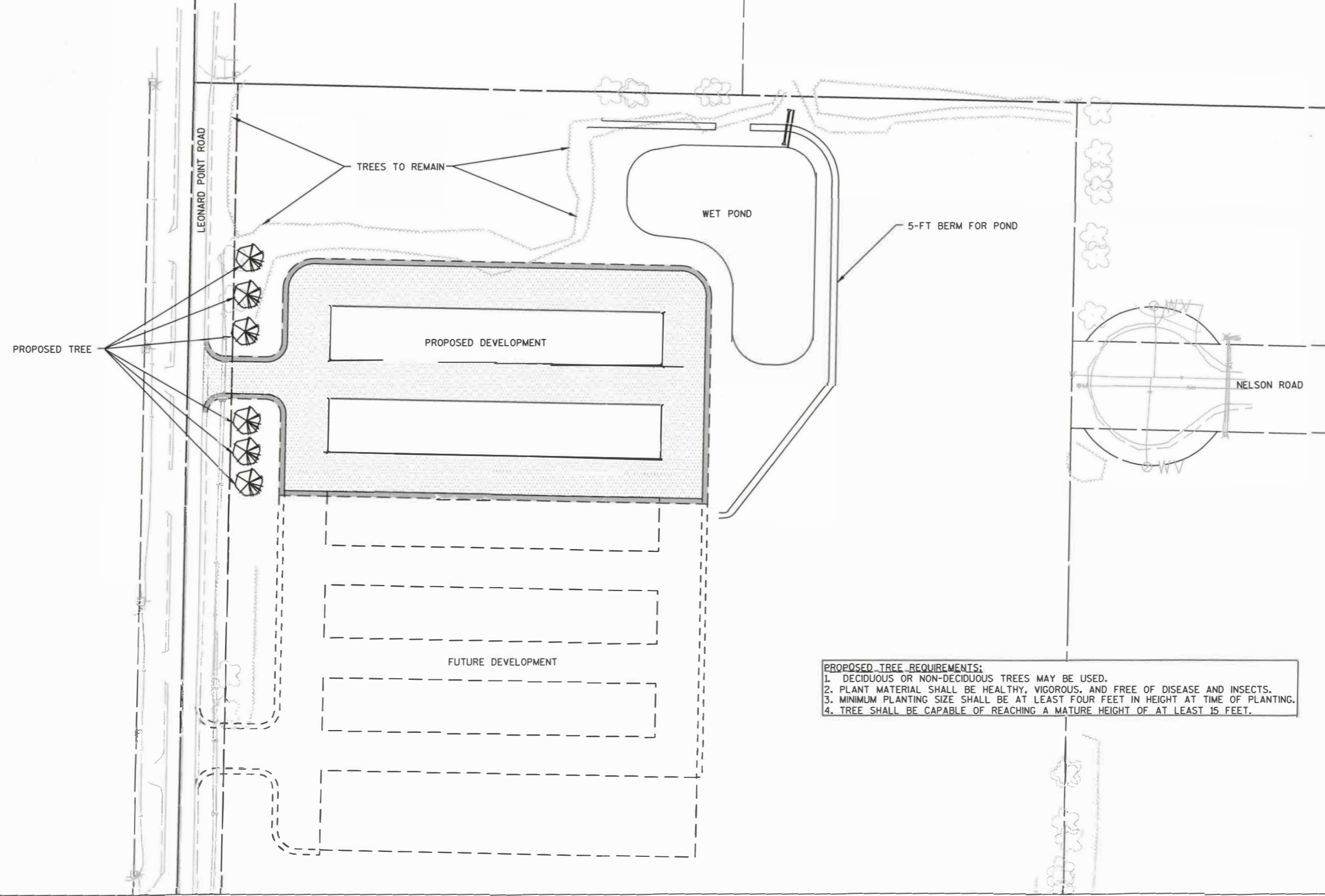

PROPOSED TREE REQUIREMENTS:
 1. DECIDUOUS OR NON-DECIDUOUS TREES MAY BE USED.
 2. PLANT MATERIAL SHALL BE HEALTHY, VIGOROUS, AND FREE OF DISEASE AND INSECTS.
 3. MINIMUM PLANTING SIZE SHALL BE AT LEAST FOUR FEET IN HEIGHT AT TIME OF PLANTING.
 4. TREE SHALL BE CAPABLE OF REACHING A MATURE HEIGHT OF AT LEAST 15 FEET.



NORTH

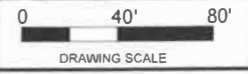

ALGOMA SELF-STORAGE UNITS
TOWN OF ALGOMA
WINNEBAGO COUNTY, WI

Omni
 ASSOCIATES
 ONE SYSTEMS DRIVE
 APPLETON, WI 54914
 (920) 735-6900

REV	DATE	DESCRIPTION

SHEET DESCRIPTION	
LANDSCAPE PLAN	
PROJECT MANAGER	EAM
PROJ NO:	M1483A17
DATE:	DATE 3/30/2017
DRAWING NO.	C111

© 2014 OMNI ASSOCIATES, INC. - THIS DESIGN, DRAWING AND DETAIL IS THE COPYRIGHTED PROPERTY OF OMNI ASSOCIATES, INC. NO PART SHALL BE COPIED, DUPLICATED, DISTRIBUTED OR REPRODUCED IN ANY MANNER WITHOUT WRITTEN CONSENT OF OMNI ASSOCIATES, INC.

SHEET INDEX

- C001 TITLE
- C101 SITE PLAN
- C102 EROSION CONTROL PLAN
- C103 GRADING PLAN
- C104 GRADING PLAN
- C105 CONSTRUCTION DETAILS
- C106 CONSTRUCTION DETAILS

PROJECT
**SPARE SPACE SELF STORAGE PHASE 4
 SITE DEVELOPMENT**

TOWN OF ALGOMA, WINNEBAGO COUNTY, WISCONSIN

WESTWOOD PROJECT NUMBER
R3000876.00



PROJECT LOCATION

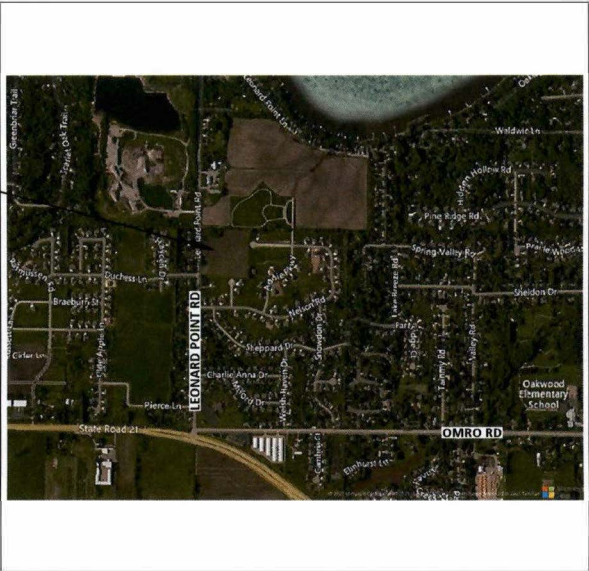

CLIENT
Spare Space Self Storage

JASON IDEUS
 1564 LEONARD POINT ROAD
 OSHKOSH, WI 54904
 1-920-347-8673



Westwood

Phone (920) 735-6900 One Systems Drive
 Fax (920) 830-6100 Appleton, WI 54914-1654
 Toll Free (800) 571-6677 westwoodps.com
 Westwood Infrastructure, Inc.

DIGGERSHOTLINE

Dial 811 or (800) 242-8511
 www.DiggersHotline.com

Westwood
 One Systems Drive
 Appleton, WI 54914-1654
 Phone (920) 735-6900
 Fax (920) 830-6100
 Toll Free (800) 571-6677
 westwoodps.com

COVERSHEET

SPARE SPACE SELF STORAGE - PHASE 4
JASON IDEUS
TOWN OF ALGOMA, WI

REV.	DATE	DESCRIPTION

PROJECT MANAGER
EAM
 PROJECT NO.
R3000876.00
 DATE
03/20/2023
 SHEET NO.
C100

© 2023 Westwood Professional Services. The design, drawing and data in this copyrighted property of Westwood Professional Services. No part shall be copied, distributed, distributed or reproduced in any manner without the consent of Westwood Professional Services.

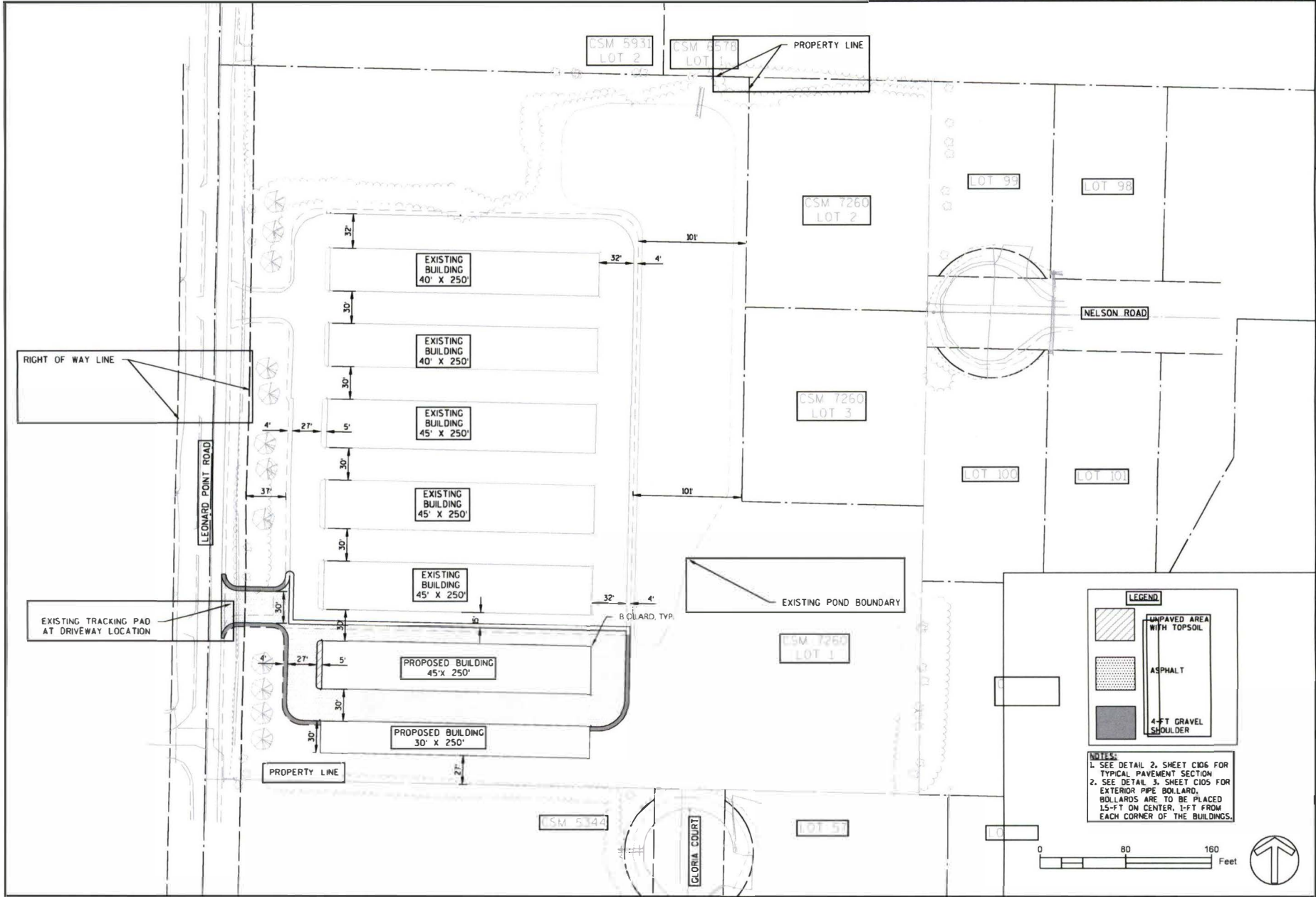

Westwood
 1000 Westwood Drive
 Appleton, WI 54914
 Tel: (920) 835-5300
 Fax: (920) 835-5300
 Website: westwoodinc.com

REV.	DATE	DESCRIPTION

SPARE SPACE SELF STORAGE - PHASE 4
JASON IDEUS
TOWN OF ALGOMA, WI

SITE PLAN
 PROJECT MANAGER
EAM
 PROJECT NO.
3000876.00
 DATE
03/20/2023
 DRAWING NO.
C101

©2023 Westwood Infrastructure, Inc. - All design, drawing and detail is the copyrighted property of Westwood Infrastructure, Inc. No part shall be copied, duplicated, distributed or reproduced in any manner without written consent of Westwood Infrastructure, Inc.

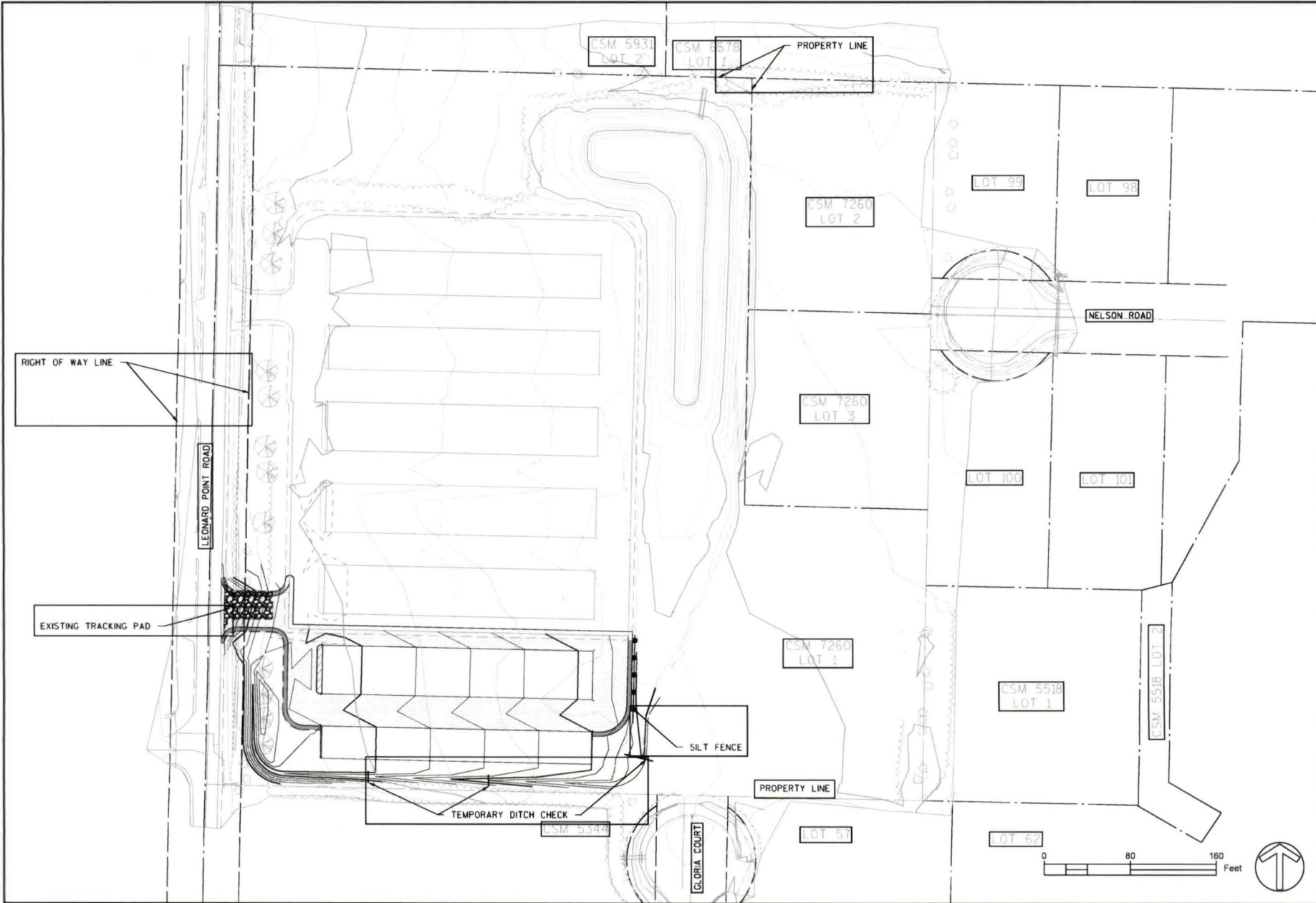

RIGHT OF WAY LINE

EXISTING TRACKING PAD

LEONARD POINT ROAD

GLORIA COURT

PROPERTY LINE

CSM 7260 LOT 2

CSM 7260 LOT 3

CSM 7260 LOT 1

LOT 51

CSM 5518 LOT 1

LOT 62

LOT 100

LOT 101

LOT 99

LOT 98

NELSON ROAD

CSM 5931 LOT 2

CSM 6578 LOT 1

PROPERTY LINE

TEMPORARY DITCH CHECK

CSM 5344

SILT FENCE

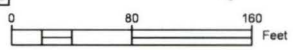

SPARE SPACE SELF STORAGE - PHASE 4
JASON IDEUS
TOWN OF ALGOMA, WI

REV	DATE	DESCRIPTION

EROSION CONTROL PLAN

PROJECT MANAGER
EAM

PROJECT NO.
3000876.00

DATE
03/20/2023

DRAWING NO.
C102

© 2021 Westwood Infrastructure, Inc. - This design, drawing and detail is the copyrighted property of Westwood Infrastructure, Inc. No part shall be copied, published, distributed or reproduced in any manner without written consent of Westwood Infrastructure, Inc.

Westwood
 Infrastructure
 1800 311-4000
 1820 315-5100
 1840 315-5100
 1860 315-5100
 1880 315-5100
 1900 315-5100
 1920 315-5100
 1940 315-5100
 1960 315-5100
 1980 315-5100
 2000 315-5100
 2020 315-5100
 2040 315-5100
 2060 315-5100
 2080 315-5100
 2100 315-5100
 2120 315-5100
 2140 315-5100
 2160 315-5100
 2180 315-5100
 2200 315-5100
 2220 315-5100
 2240 315-5100
 2260 315-5100
 2280 315-5100
 2300 315-5100
 2320 315-5100
 2340 315-5100
 2360 315-5100
 2380 315-5100
 2400 315-5100
 2420 315-5100
 2440 315-5100
 2460 315-5100
 2480 315-5100
 2500 315-5100
 2520 315-5100
 2540 315-5100
 2560 315-5100
 2580 315-5100
 2600 315-5100
 2620 315-5100
 2640 315-5100
 2660 315-5100
 2680 315-5100
 2700 315-5100
 2720 315-5100
 2740 315-5100
 2760 315-5100
 2780 315-5100
 2800 315-5100
 2820 315-5100
 2840 315-5100
 2860 315-5100
 2880 315-5100
 2900 315-5100
 2920 315-5100
 2940 315-5100
 2960 315-5100
 2980 315-5100
 3000 315-5100
 3020 315-5100
 3040 315-5100
 3060 315-5100
 3080 315-5100
 3100 315-5100
 3120 315-5100
 3140 315-5100
 3160 315-5100
 3180 315-5100
 3200 315-5100
 3220 315-5100
 3240 315-5100
 3260 315-5100
 3280 315-5100
 3300 315-5100
 3320 315-5100
 3340 315-5100
 3360 315-5100
 3380 315-5100
 3400 315-5100
 3420 315-5100
 3440 315-5100
 3460 315-5100
 3480 315-5100
 3500 315-5100
 3520 315-5100
 3540 315-5100
 3560 315-5100
 3580 315-5100
 3600 315-5100
 3620 315-5100
 3640 315-5100
 3660 315-5100
 3680 315-5100
 3700 315-5100
 3720 315-5100
 3740 315-5100
 3760 315-5100
 3780 315-5100
 3800 315-5100
 3820 315-5100
 3840 315-5100
 3860 315-5100
 3880 315-5100
 3900 315-5100
 3920 315-5100
 3940 315-5100
 3960 315-5100
 3980 315-5100
 4000 315-5100
 4020 315-5100
 4040 315-5100
 4060 315-5100
 4080 315-5100
 4100 315-5100
 4120 315-5100
 4140 315-5100
 4160 315-5100
 4180 315-5100
 4200 315-5100
 4220 315-5100
 4240 315-5100
 4260 315-5100
 4280 315-5100
 4300 315-5100
 4320 315-5100
 4340 315-5100
 4360 315-5100
 4380 315-5100
 4400 315-5100
 4420 315-5100
 4440 315-5100
 4460 315-5100
 4480 315-5100
 4500 315-5100
 4520 315-5100
 4540 315-5100
 4560 315-5100
 4580 315-5100
 4600 315-5100
 4620 315-5100
 4640 315-5100
 4660 315-5100
 4680 315-5100
 4700 315-5100
 4720 315-5100
 4740 315-5100
 4760 315-5100
 4780 315-5100
 4800 315-5100
 4820 315-5100
 4840 315-5100
 4860 315-5100
 4880 315-5100
 4900 315-5100
 4920 315-5100
 4940 315-5100
 4960 315-5100
 4980 315-5100
 5000 315-5100
 5020 315-5100
 5040 315-5100
 5060 315-5100
 5080 315-5100
 5100 315-5100
 5120 315-5100
 5140 315-5100
 5160 315-5100
 5180 315-5100
 5200 315-5100
 5220 315-5100
 5240 315-5100
 5260 315-5100
 5280 315-5100
 5300 315-5100
 5320 315-5100
 5340 315-5100
 5360 315-5100
 5380 315-5100
 5400 315-5100
 5420 315-5100
 5440 315-5100
 5460 315-5100
 5480 315-5100
 5500 315-5100
 5520 315-5100
 5540 315-5100
 5560 315-5100
 5580 315-5100
 5600 315-5100
 5620 315-5100
 5640 315-5100
 5660 315-5100
 5680 315-5100
 5700 315-5100
 5720 315-5100
 5740 315-5100
 5760 315-5100
 5780 315-5100
 5800 315-5100
 5820 315-5100
 5840 315-5100
 5860 315-5100
 5880 315-5100
 5900 315-5100
 5920 315-5100
 5940 315-5100
 5960 315-5100
 5980 315-5100
 6000 315-5100
 6020 315-5100
 6040 315-5100
 6060 315-5100
 6080 315-5100
 6100 315-5100
 6120 315-5100
 6140 315-5100
 6160 315-5100
 6180 315-5100
 6200 315-5100
 6220 315-5100
 6240 315-5100
 6260 315-5100
 6280 315-5100
 6300 315-5100
 6320 315-5100
 6340 315-5100
 6360 315-5100
 6380 315-5100
 6400 315-5100
 6420 315-5100
 6440 315-5100
 6460 315-5100
 6480 315-5100
 6500 315-5100
 6520 315-5100
 6540 315-5100
 6560 315-5100
 6580 315-5100
 6600 315-5100
 6620 315-5100
 6640 315-5100
 6660 315-5100
 6680 315-5100
 6700 315-5100
 6720 315-5100
 6740 315-5100
 6760 315-5100
 6780 315-5100
 6800 315-5100
 6820 315-5100
 6840 315-5100
 6860 315-5100
 6880 315-5100
 6900 315-5100
 6920 315-5100
 6940 315-5100
 6960 315-5100
 6980 315-5100
 7000 315-5100
 7020 315-5100
 7040 315-5100
 7060 315-5100
 7080 315-5100
 7100 315-5100
 7120 315-5100
 7140 315-5100
 7160 315-5100
 7180 315-5100
 7200 315-5100
 7220 315-5100
 7240 315-5100
 7260 315-5100
 7280 315-5100
 7300 315-5100
 7320 315-5100
 7340 315-5100
 7360 315-5100
 7380 315-5100
 7400 315-5100
 7420 315-5100
 7440 315-5100
 7460 315-5100
 7480 315-5100
 7500 315-5100
 7520 315-5100
 7540 315-5100
 7560 315-5100
 7580 315-5100
 7600 315-5100
 7620 315-5100
 7640 315-5100
 7660 315-5100
 7680 315-5100
 7700 315-5100
 7720 315-5100
 7740 315-5100
 7760 315-5100
 7780 315-5100
 7800 315-5100
 7820 315-5100
 7840 315-5100
 7860 315-5100
 7880 315-5100
 7900 315-5100
 7920 315-5100
 7940 315-5100
 7960 315-5100
 7980 315-5100
 8000 315-5100
 8020 315-5100
 8040 315-5100
 8060 315-5100
 8080 315-5100
 8100 315-5100
 8120 315-5100
 8140 315-5100
 8160 315-5100
 8180 315-5100
 8200 315-5100
 8220 315-5100
 8240 315-5100
 8260 315-5100
 8280 315-5100
 8300 315-5100
 8320 315-5100
 8340 315-5100
 8360 315-5100
 8380 315-5100
 8400 315-5100
 8420 315-5100
 8440 315-5100
 8460 315-5100
 8480 315-5100
 8500 315-5100
 8520 315-5100
 8540 315-5100
 8560 315-5100
 8580 315-5100
 8600 315-5100
 8620 315-5100
 8640 315-5100
 8660 315-5100
 8680 315-5100
 8700 315-5100
 8720 315-5100
 8740 315-5100
 8760 315-5100
 8780 315-5100
 8800 315-5100
 8820 315-5100
 8840 315-5100
 8860 315-5100
 8880 315-5100
 8900 315-5100
 8920 315-5100
 8940 315-5100
 8960 315-5100
 8980 315-5100
 9000 315-5100
 9020 315-5100
 9040 315-5100
 9060 315-5100
 9080 315-5100
 9100 315-5100
 9120 315-5100
 9140 315-5100
 9160 315-5100
 9180 315-5100
 9200 315-5100
 9220 315-5100
 9240 315-5100
 9260 315-5100
 9280 315-5100
 9300 315-5100
 9320 315-5100
 9340 315-5100
 9360 315-5100
 9380 315-5100
 9400 315-5100
 9420 315-5100
 9440 315-5100
 9460 315-5100
 9480 315-5100
 9500 315-5100
 9520 315-5100
 9540 315-5100
 9560 315-5100
 9580 315-5100
 9600 315-5100
 9620 315-5100
 9640 315-5100
 9660 315-5100
 9680 315-5100
 9700 315-5100
 9720 315-5100
 9740 315-5100
 9760 315-5100
 9780 315-5100
 9800 315-5100
 9820 315-5100
 9840 315-5100
 9860 315-5100
 9880 315-5100
 9900 315-5100
 9920 315-5100
 9940 315-5100
 9960 315-5100
 9980 315-5100
 10000 315-5100

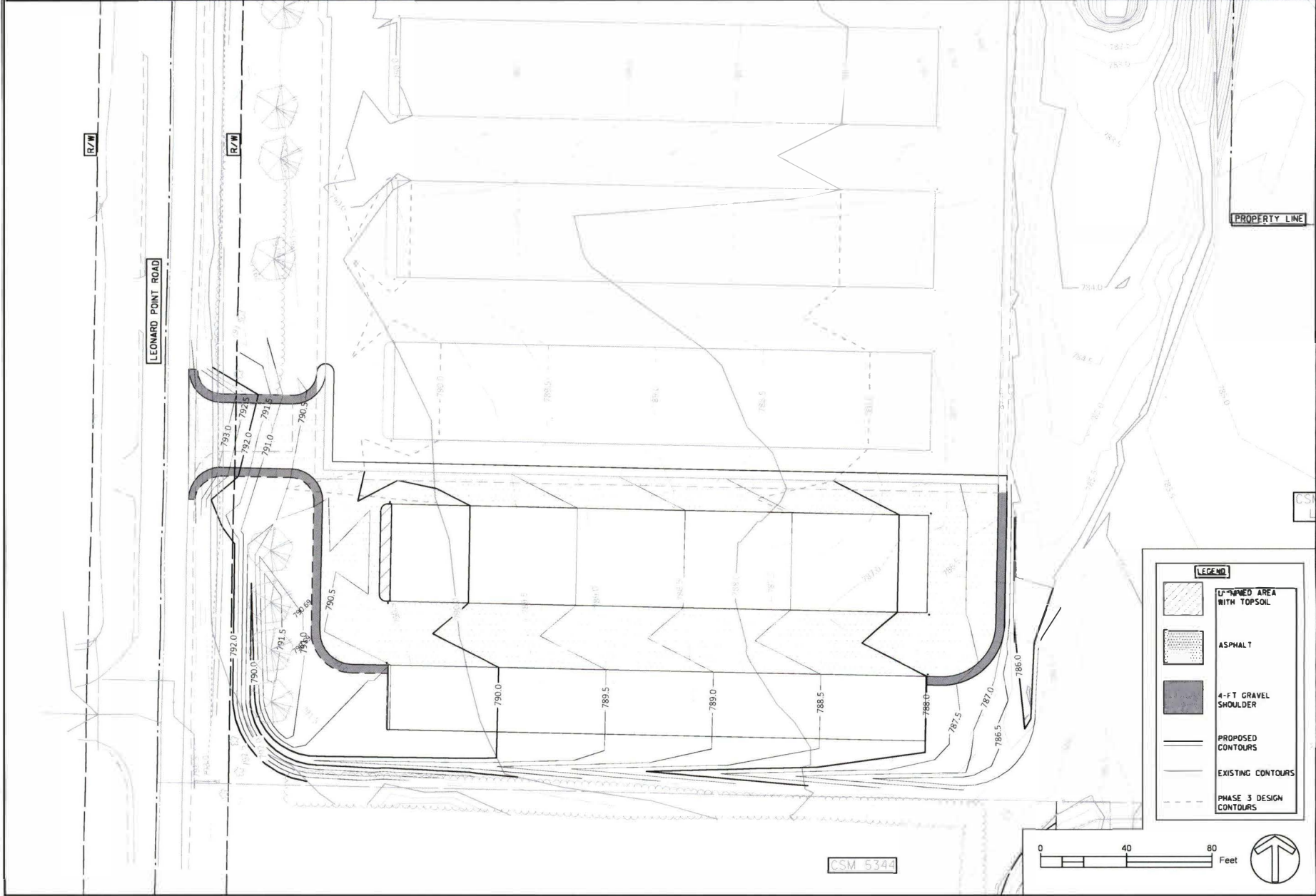

Westwood
 One Schwan Drive
 Appleton, WI 54914-1844
 Phone: (920) 233-6800
 Fax: (920) 233-2200
 www.westwoodinc.com

REV	DATE	DESCRIPTION

SPARE SPACE SELF STORAGE - PHASE 4
JASON IDEUS
TOWN OF ALGOMA, WI

GRADING PLAN

PROJECT MANAGER
EAM

PROJECT NO.
3000875.00

DATE
03/20/2023

DRAWING NO.
C103

PROPERTY LINE

CSM 5344

0 40 80 Feet

©2021 Westwood Infrastructure, Inc. - This design, drawing and detail is the copyrighted property of Westwood Infrastructure, Inc. No part may be copied, duplicated, distributed or reproduced in any manner without written consent of Westwood Infrastructure, Inc.

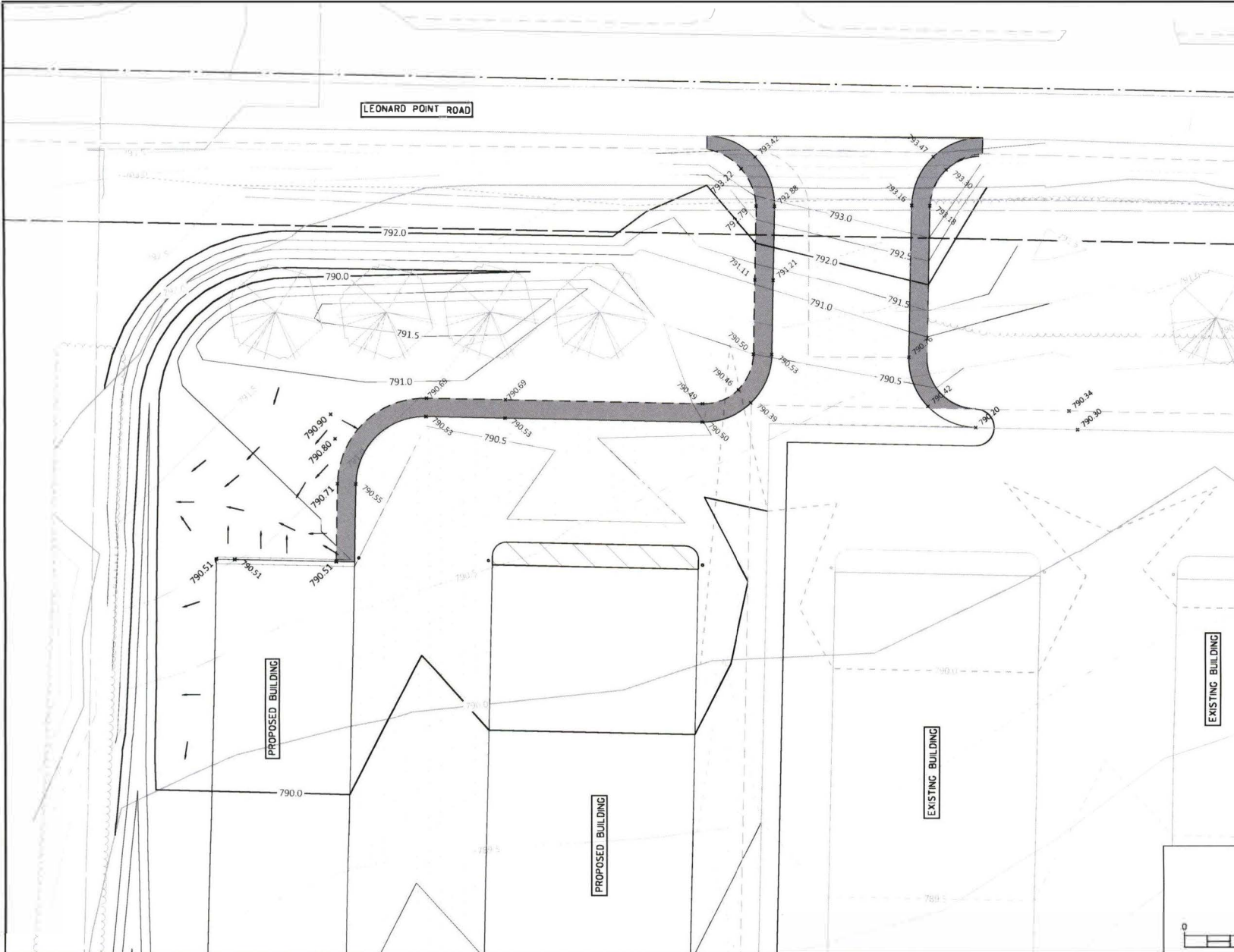

LEGEND

- UNPAVED AREA WITH TOPSOIL
- ASPHALT
- 4-FT GRAVEL SHOULDER
- PROPOSED CONTOURS
- EXISTING CONTOURS
- PHASE 3 DESIGN CONTOURS

Westwood
 Civil & Survey
 1830 21st Street
 Appleton, WI 54914-1634
 Phone: (920) 834-8306
 Fax: (920) 834-8377
 www.westwoodinc.com
 Westwood Infrastructure, Inc.

REV	DATE	DESCRIPTION

SPARE SPACE SELF STORAGE - PHASE 4
JASON IDEUS
TOWN OF ALGOMA, WI



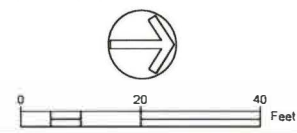

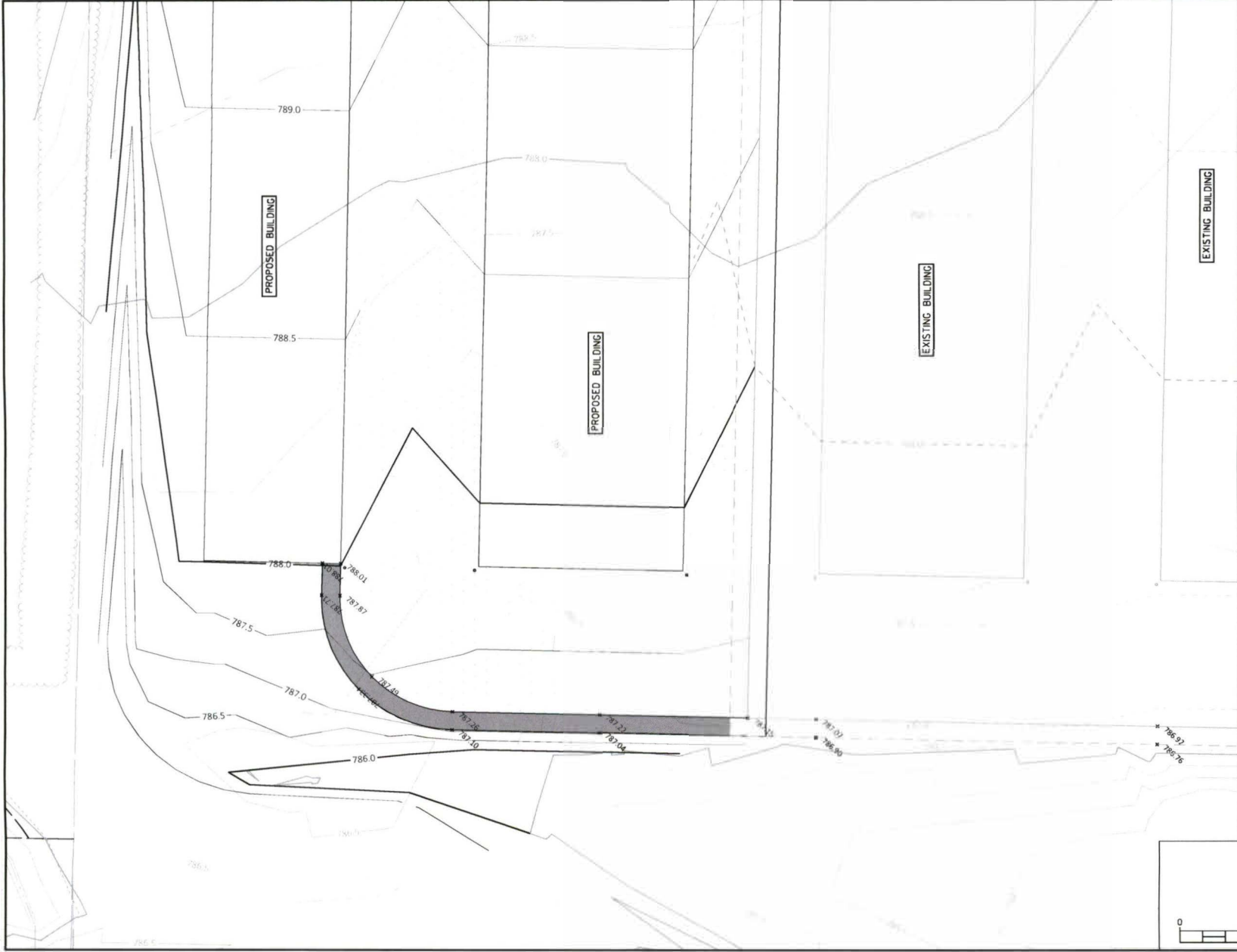

WEST GRADING PLAN
 PROJECT MANAGER: EAM
 PROJECT NO: 3000876.00
 DATE: 03/20/2023
 DRAWING NO: **C104**



© 2023 Westwood Infrastructure, Inc. - This design, drawing and detail is the copyrighted property of Westwood Infrastructure, Inc. No part shall be copied, duplicated, distributed or reproduced in any manner without written consent of Westwood Infrastructure, Inc.



LEGEND

-  UNPAVED AREA WITH TOPSOIL
-  ASPHALT
-  4-FT GRAVEL SHOULDER
-  PROPOSED CONTOURS
-  EXISTING CONTOURS
-  PHASE 3 DESIGN CONTOURS

REV	DATE	DESCRIPTION

SPARE SPACE SELF STORAGE - PHASE 4
JASON IDEUS
TOWN OF ALGOMA, WI

EAST
GRADING PLAN

PROJECT MANAGER
EAM

PROJECT NO.
3000876.00

DATE
03/20/2023

DRAWING NO.
C105

Westwood
 1000 100-0000
 Algoma, WI 54911-1614
 Tel: (920) 871-6877
 westwoodinc.com
 Westwood Infrastructure, Inc.

© 2021 Westwood Infrastructure, Inc. - This design, drawing and detail is the copyrighted property of Westwood Infrastructure, Inc. No part shall be copied, duplicated, distributed or reproduced in any manner without written consent of Westwood Infrastructure, Inc.

NOTES

- ① TRENCH SHALL BE A MINIMUM OF 4" WIDE & 6" DEEP TO BURY AND ANCHOR THE GEOTEXTILE FABRIC. FOLD MATERIAL TO FIT TRENCH AND BACKFILL & COMPACT TRENCH WITH EXCAVATED SOIL.
- ② WOOD POSTS SHALL BE A MINIMUM SIZE OF 1" X 1" OF OAK OR HICKORY.
- ③ CONSTRUCT SILT FENCE FROM A CONTINUOUS ROLL IF POSSIBLE BY CUTTING LENGTHS TO AVOID JOINTS. IF A JOINT IS NECESSARY USE ONE OF THE FOLLOWING TWO METHODS: A) OVERLAP THE END POSTS AND TWIST, OR ROTATE, AT LEAST 180 DEGREES, B) HOOK THE END OF EACH SILT FENCE LENGTH.
- ④ EROSION CONTROL SHALL BE IN ACCORDANCE WITH WDNR TECHNICAL STANDARDS.

NOTE:

ADDITIONAL POST DEPTH OR TIE BACKS MAY BE REQUIRED IN UNSTABLE SOILS

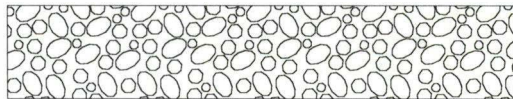
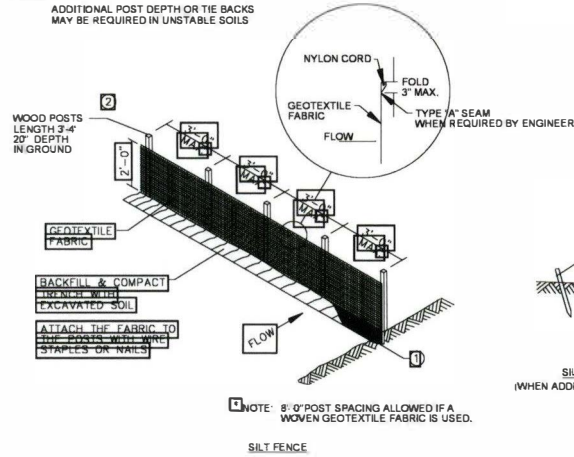

THE GRAVEL ACCESS SHALL BE INSPECTED DAILY AREAS NOT MEETING THE DESIGN CRITERIA AND REQUIREMENTS SHALL BE REPAIRED/REPLACED IMMEDIATELY

2 TRACKING PAD
NOT TO SCALE

CLEAR OR WASHED ROCK (3" - 6") BREAKER RUN MINIMUM THICKNESS 12" FOR CONSTRUCTION ACCESS.

③ JOINING TWO LENGTHS OF SILT FENCE

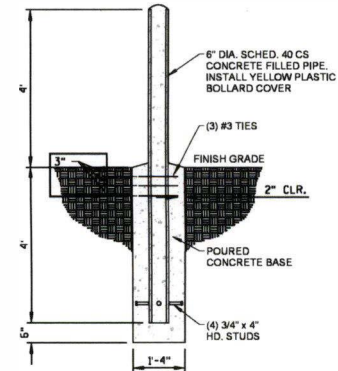
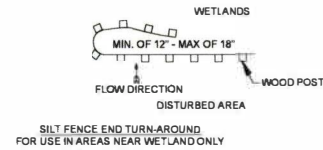

3 EXTERIOR PIPE BOLLARD
NOT TO SCALE

REV.	DATE	DESCRIPTION

SPARE SPACE SELF STORAGE - PHASE 4
JASON IDEUS
TOWN OF ALGOMA, WI

CONSTRUCTION DETAILS

PROJECT MANAGER	EAM
PROJECT NO.	3000876.00
DATE	03/20/2023
DRAWING NO.	C106

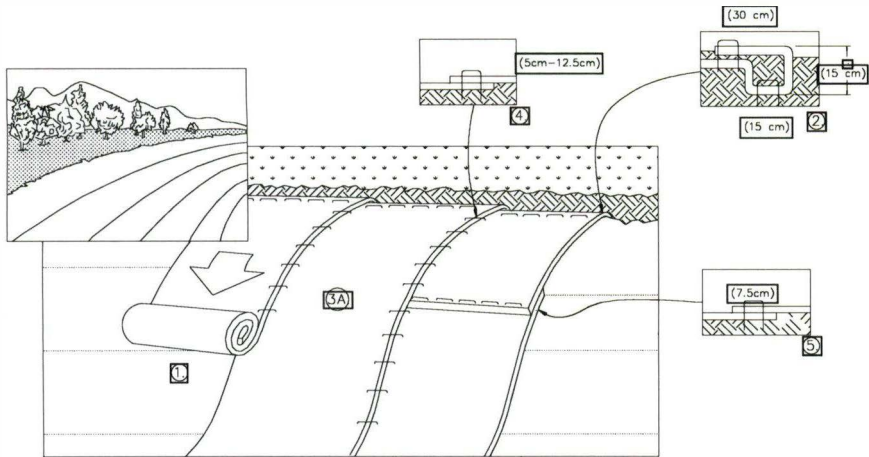

1. PREPARE SOIL BEFORE INSTALLING BLANKETS, INCLUDING ANY NECESSARY APPLICATION OF LIME, FERTILIZER, AND SEED.
NOTE: WHEN USING CELL-O-SEED, DO NOT SEED PREPARED AREA. CELL-O-SEED MUST BE INSTALLED WITH PAPER SIDE DOWN.
2. BEGIN AT THE TOP OF THE SLOPE BY ANCHORING THE BLANKET IN A 6" X8" WIDE TRENCH WITH APPROXIMATELY 12" OF BLANKET EXTENDED BEYOND THE UP-SLOPE PORTION OF THE TRENCH. ANCHOR THE BLANKET WITH A ROW OF STAPLES/STAKES APPROXIMATELY 12" APART IN THE BOTTOM OF THE TRENCH. BACK FILL AND COMPACT THE TRENCH AFTER STAPLING. APPLY SEED TO COMPACTED SOIL AND FOLD REMAINING 12" PORTION OF BLANKET BACK OVER SEED AND COMPACTED SOIL. SECURE BLANKET OVER COMPACTED SOIL WITH A ROW OF STAPLES/STAKES SPACED APPROXIMATELY 12" APART ACROSS THE WIDTH OF THE BLANKET.
3. ROLL THE BLANKETS (A) DOWN OR (B) HORIZONTALLY ACROSS THE SLOPE. BLANKETS WILL UNROLL WITH THE APPROPRIATE SIDE AGAINST THE SOIL SURFACE. ALL BLANKETS MUST BE SECURELY FASTENED TO SOIL SURFACE BY PLACING STAPLES/STAKES IN APPROPRIATE LOCATIONS AS SHOWN IN THE STAPLE PATTERN GUIDE. WHEN USING OPTIONAL DOT SYSTEM, STAPLES/STAKES SHOULD BE PLACED THROUGH EACH OF THE COLORED DOTS CORRESPONDING TO THE APPROPRIATE STAPLE PATTERN.
4. THE EDGES OF PARALLEL BLANKETS MUST BE STAPLED WITH APPROXIMATELY 2" - 5" OVERLAP DEPENDING ON BLANKET TYPE. TO ENSURE PROPER SEAM ALIGNMENT, PLACE THE EDGE OF THE OVERLAPPING BLANKET (BLANKET BEING INSTALLED ON TOP) EVEN WITH THE COLORED SEAM STITCH ON THE PREVIOUSLY INSTALLED BLANKET.
5. CONSECUTIVE BLANKETS SPICED DOWN THE SLOPE MUST BE PLACED END OVER END (SHINGLE STYLE) WITH AN APPROXIMATE 3" OVERLAP. STAPLE THROUGH OVERLAPPED AREA, APPROXIMATELY 12" APART ACROSS ENTIRE BLANKET WIDTH.

NOTE:
*IN LOOSE SOIL CONDITIONS, THE USE OF STAPLE OR STAKE LENGTHS GREATER THAN 6" MAY BE NECESSARY TO PROPERLY SECURE THE BLANKETS.

1 EROSION CONTROL MAT (WISDOT CLASS I, TYPE B)

NOT TO SCALE

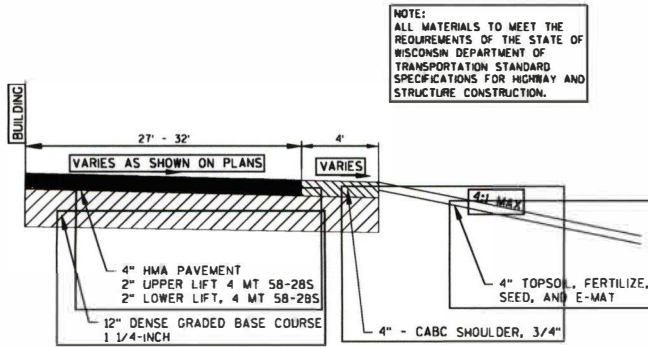

2 TYPICAL PAVEMENT SECTION

NOT TO SCALE

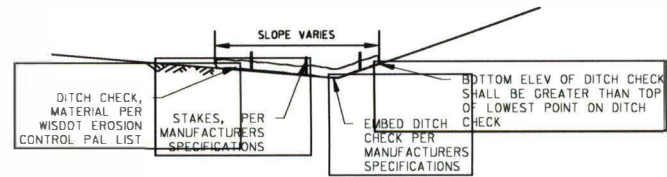

3 TEMPORARY DITCH CHECK

NOT TO SCALE

REV	DATE	DESCRIPTION

CONSTRUCTION DETAILS
PROJECT MANAGER EAM
PROJECT NO. 3000876.00
DATE 03/20/2023
DRAWING NO. C106

©2021 Westwood Infrastructure, Inc. - This map, drawing and detail is the copyrighted property of Westwood Infrastructure, Inc. No part may be copied, duplicated, distributed or reproduced in any manner without the written consent of Westwood Infrastructure, Inc.